



## ST. GEORGES SLOUGH, SL1 5PA

We are delighted to present this impressive semi-detached property to let in the heart of Slough, situated in a sought-after location. The property is in good condition, making it ready to move into and start enjoying the comfortable living it offers.

As you step inside, you are greeted by two spacious reception rooms, perfect for

# £2,800 Per



2



1



5

EPC E

**cameron**  
  
ESTATE AGENTS

GROUND FLOOR  
379 sq.ft. (35.2 sq.m.) approx.

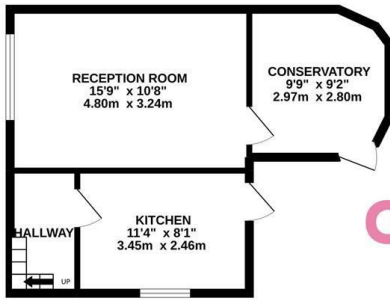

1ST FLOOR  
422 sq.ft. (39.2 sq.m.) approx.

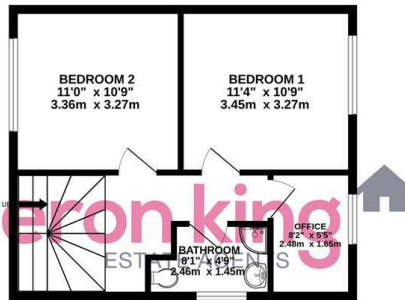

2ND FLOOR  
415 sq.ft. (38.6 sq.m.) approx.



TOTAL FLOOR AREA : 1217 sq.ft. (113.0 sq.m.) approx.

Whilst every attempt has been made to ensure the accuracy of the floorplan contained here, measurements of doors, windows, rooms and any other items are approximate and no responsibility is taken for any error, omission or mis-statement. This plan is for illustrative purposes only and should be used as such by any prospective purchaser. The services, systems and appliances shown have not been tested and no guarantee as to their operability or efficiency can be given.  
Made with Metropix ©2022

entertaining guests or relaxing with family. The open-plan design of one of the reception rooms creates a feeling of space and allows plenty of natural light to flood in through the large windows. The other reception room provides a separate space and offers access to a beautiful garden, where you can enjoy outdoor activities.

This property features a modern kitchen equipped with high-quality appliances and ample workspace. The abundance of natural light makes this kitchen a delightful place to prepare meals.

The five bedrooms in this property are generously sized, providing plenty of space for families. The double bedrooms offer spaciousness and an abundance of natural light, while the single bedroom provides a cozy haven. Each bedroom has its own unique charm, making it easy to personalize and create a comfortable retreat.

The property boasts two well-appointed bathrooms. One bathroom features a shower cubicle, WC, and wash hand basin, while the other offers a relaxing bath, WC, and wash hand basin.

Outside, there is a driveway for convenient parking, as well as a single garage for parking your family cars, providing

- 5 Bedroom Famil Home
- 10 Minutes Walk to Burnham Station
- Easy Access to M4 Motorway (Junction 7)
- Large Private Rear Garden
- Driveway Parking for Multiple Vehicles
- Walking Distance to Local Schools
- Close to Local Amenities
- Conservatory Area
- Furnished or Unfurnished (optional)



411 Bath Road, Slough, SL1 5QL  
t: 01628 667442  
e: sales@cameronking.co.uk

