



1 SHOAL CREEK NORTHAMPTON, NN4 0YT

£1,250,000
FREEHOLD

Stonhills are pleased to offer this stunning four bedroom detached family home, positioned on Shoal Creek, one of the most sought-after roads within Collingtree Park. The property features a large, private rear garden, detached double garage, four double bedrooms including two en-suites, and enjoys views across Collingtree Park Golf Course, with Virgin Active and excellent transport links close by.



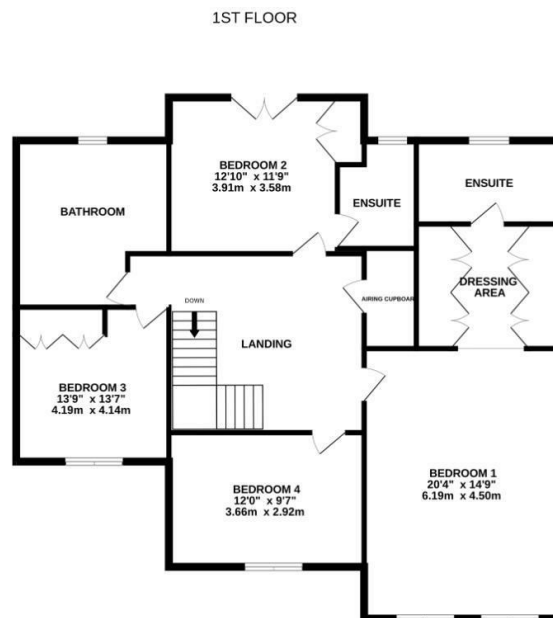
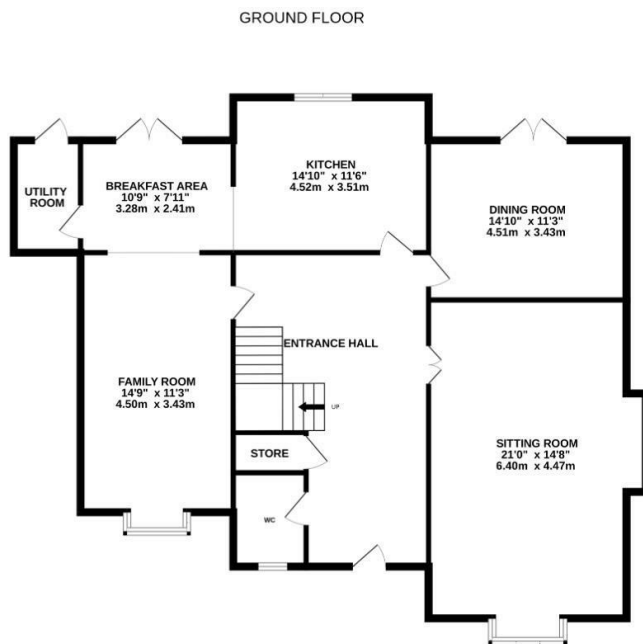

1 SHOAL CREEK, NORTHAMPTON

Whilst every attempt has been made to ensure the accuracy of the floorplan contained here, measurements of doors, windows, rooms and any other items are approximate and no responsibility is taken for any error, omission or mis-statement. This plan is for illustrative purposes only and should be used as such by any prospective purchaser. The services, systems and appliances shown have not been tested and no guarantee as to their operability or efficiency can be given.
Made with Metropix ©2026

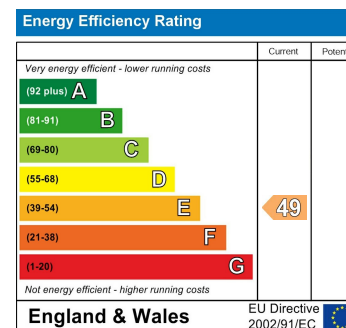

Agents Note: Whilst every care has been taken to prepare these particulars, they are for guidance purposes only. All measurements are approximate and are for general guidance purposes only and whilst every care has been taken to ensure their accuracy, they should not be relied upon and potential buyers/tenants are advised to recheck the measurements

Northampton Office Sales
39 St Giles Street
Northampton
Northamptonshire
NN1 1JF

01604 624424
lewis@stonhills.co.uk
<https://www.stonhills.co.uk/>

stonhills
LAND & ESTATE AGENTS