

**£550,000**

**Sutton Way**

Hounslow, TW5 0JA



## PROPERTY SUMMARY

Tucked away on the desirable Sutton Way in Heston, this charming 1930s semi-detached home presents a fantastic opportunity for buyers with a vision. Bursting with potential, the property features two reception rooms, three bedrooms, and a bathroom—offering a solid foundation for transformation.

In need of full modernisation, it serves as the perfect blank canvas to craft your dream home from the ground up.

With its generously sized layout and scope for extension (subject to planning), the home offers endless possibilities. Whether you're seeking to create a beautiful family residence or a rewarding investment, this property invites you to bring your ideas to life.

3



1



2







Approximate Gross Internal Area = 86.87 sq m / 935 sq ft  
(Excluding Void)

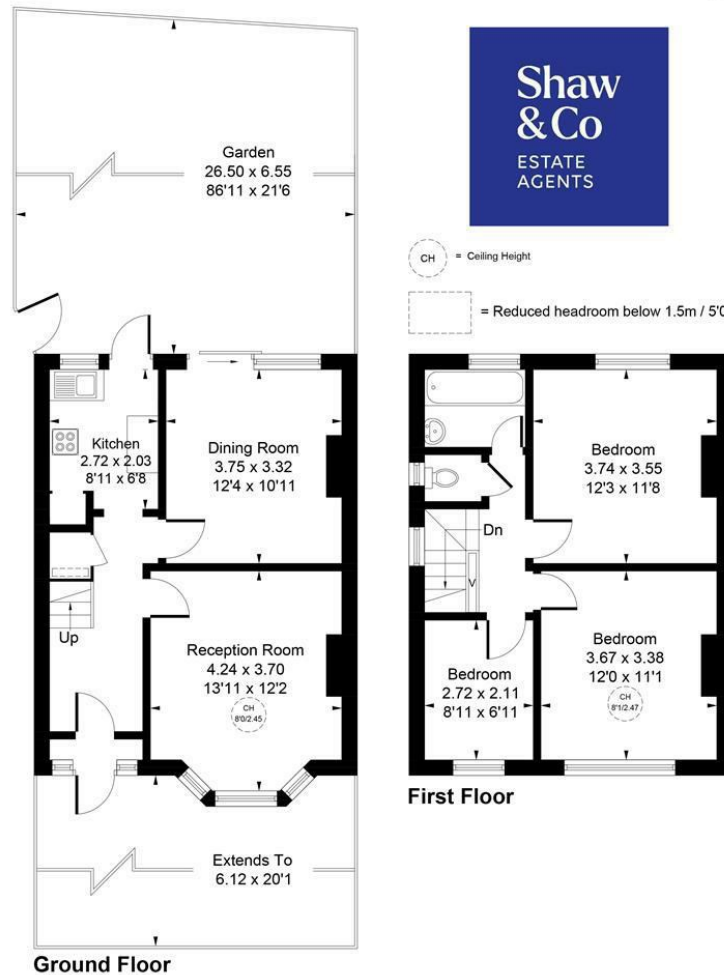

Whilst every attempt has been made to ensure the accuracy of the floor plan contained here, measurements of doors, windows, rooms and any other items are approximate and no responsibility is taken for any error, omission, or mis-statement.  
This plan is for illustrative purposes only and should be used as such by any prospective purchaser.  
© Vizion Property Marketing Produced for Shaw & Co.

## LOCAL AUTHORITY

Hounslow

## TENURE

Freehold

## COUNCIL TAX BAND

D

## VIEWINGS

By prior appointment only

Energy Efficiency Rating		Current	Potential
Very energy efficient - lower running costs			
(92 plus) A			88
(81-91) B			
(69-80) C			66
(55-68) D			
(39-54) E			
(21-38) F			
(1-20) G			
Not energy efficient - higher running costs			
England & Wales		EU Directive 2002/91/EC	

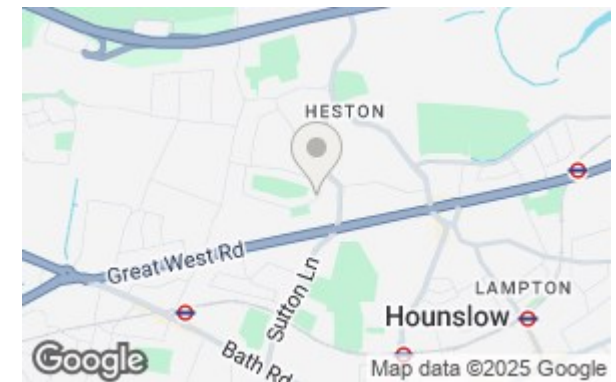

Agents Note: Whilst every care has been taken to prepare these particulars, they are for guidance purposes only. All measurements are approximate and are for general guidance purposes only and whilst every care has been taken to ensure their accuracy, they should not be relied upon and potential buyers/tenants are advised to recheck the measurements

**Shaw  
& Co**  
ESTATE  
AGENTS

**OFFICE ADDRESS**  
10 Central Parade  
New Heston Road  
Heston  
Middlesex  
TW5 0LJ

**OFFICE DETAILS**  
0208 570 7258  
heston@shawandcoestates.com