



**Shaw  
& Co**  
ESTATE  
AGENTS

**£195,000**  
**Ferraro Close**  
Hounslow, TW5 0UJ

S  
&



## Spooner House, Ferraro Close, Hounslow, TW5

Approximate Gross Internal Area  
560 sq ft - 52 sq m

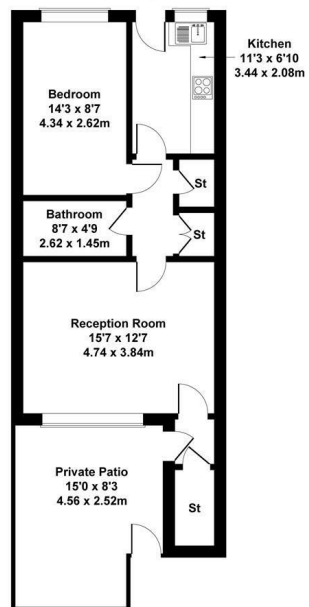

Not to Scale, Produced by The Plan Portal 2025  
For Illustrative Purposes Only.

Shaw  
& Co

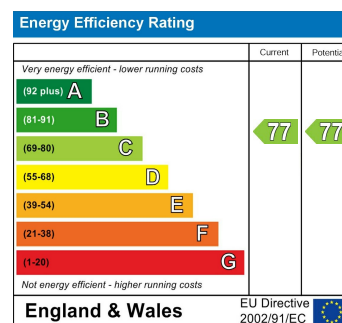
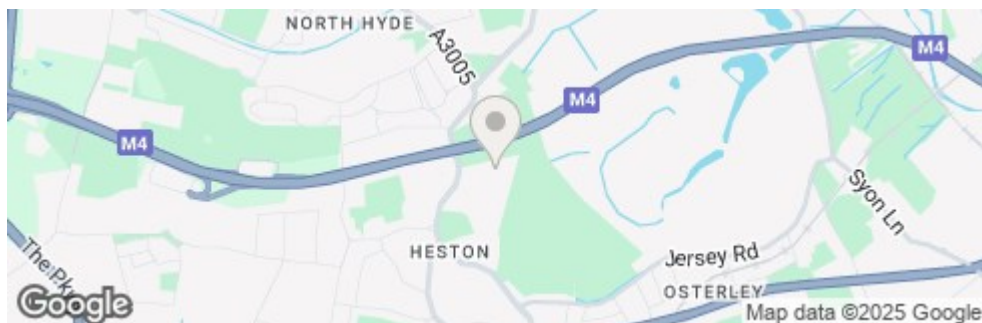
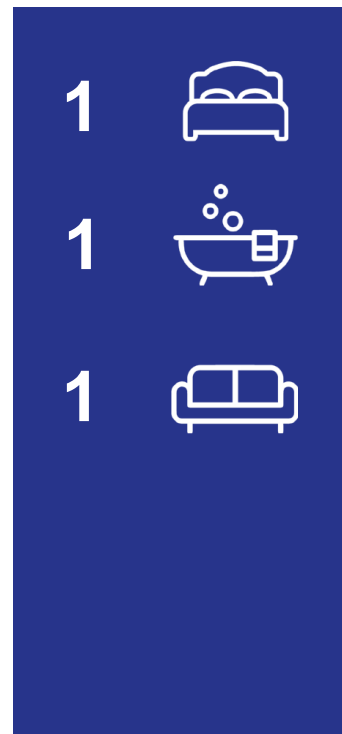

- Spacious Ground Floor 1- Private Patio bedroom Flat
- Ideal for First-time Buyers or Investors
- Communal Resident Parking
- Ample Storage
- Cash Buyers Only

Agents Note: These particulars are for guidance only. All measurements area approximate and should be rechecked by buyers / tenants. While care has been taken to ensure accuracy, they should be solely relied upon.

**Shaw  
& Co**  
ESTATE  
AGENTS

**OFFICE ADDRESS**  
10 Central Parade  
New Heston Road  
Heston  
Middlesex  
TW5 0LH

**OFFICE DETAILS**  
0208 570 7258  
heston@shawandcoestates.com