

**Shaw
& Co**
ESTATE
AGENTS

OFFERS OVER
£510,000

Tiverton Road

Hounslow, TW3 4JE

Shaw & Co
ESTATE AGENTS

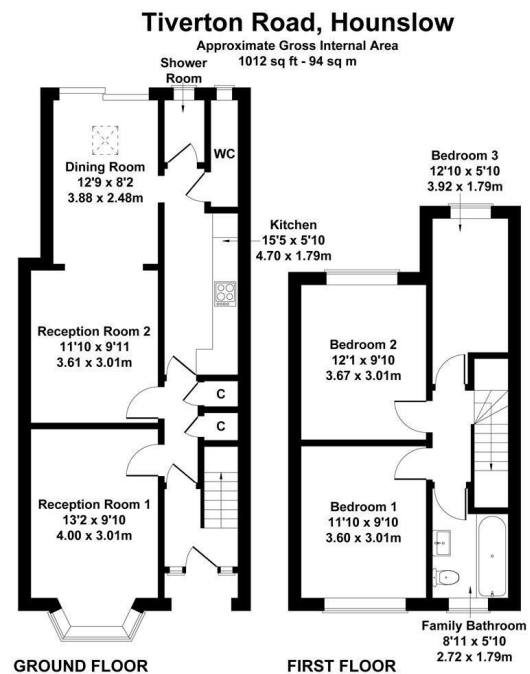

Not to Scale. Produced by The Plan Portal 2024
For Illustrative Purposes Only.

Shaw & Co
ESTATE AGENTS

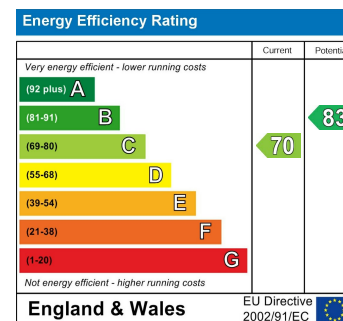
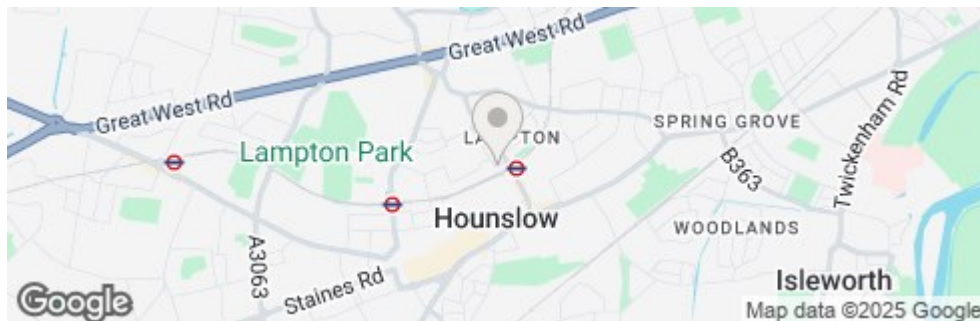

- Sought after road
 - Two bathrooms
 - Rear garden
 - Close to amenities
 - Good investment
- No chain
 - Extended
 - Walking distance to Hounslow East Tube Station
 - Ideal for commuters
 - Well proportioned living features throughout.
- Agents Note: These particulars are for guidance only. All measurements area approximate and should be rechecked by buyers / tenants. While care has been taken to ensure accuracy, they should be solely relied upon.

Shaw & Co
ESTATE AGENTS

OFFICE ADDRESS
10 Central Parade
New Heston Road
Heston
Middlesex
TW5 0LH

OFFICE DETAILS
0208 570 7258
heston@shawandcoestates.com