

**£725,000**

**North Hyde Lane**

Hounslow, TW5 0EH





## PROPERTY SUMMARY

Welcome to this charming detached house located on North Hyde Lane. This property boasts a spacious reception room, perfect for entertaining guests or simply relaxing with your family.

Situated on a generous plot, this 4-bedroom semi-detached house offers great potential for those looking to create their dream home. The side extension provides additional living space, giving you the opportunity to tailor the property to your needs and preferences.

Conveniently located in a desirable area, this property offers easy access to local amenities, schools, and transport links, making it an ideal choice for families or professionals.

Don't miss out on the chance to own this chain-free property with endless possibilities. Whether you're looking to invest or settle down, this house on North Hyde Lane is a fantastic opportunity not to be missed.

4



1



1







Approximate Gross Internal Area = 161.91 sq m / 1743 sq ft  
 Outbuilding = 11.26 sq m / 121 sq ft  
 Total = 173.17 sq m / 1864 sq ft

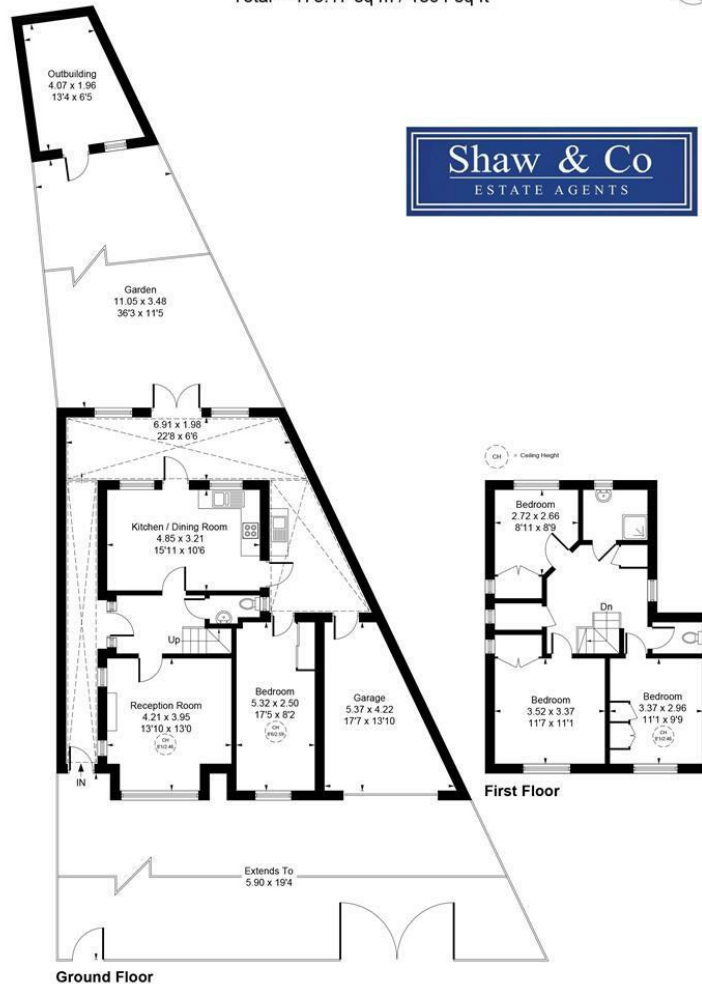

Whilst every attempt has been made to ensure the accuracy of the floor plan contained here, measurements of doors, windows, rooms and any other items are approximate and no responsibility is taken for any error, omission, or mis-statement.  
 This plan is for illustrative purposes only and should be used as such by any prospective purchaser.  
 © Vizion Property Marketing Produced for Shaw & Co.

## LOCAL AUTHORITY

Hounslow

## TENURE

Freehold

## COUNCIL TAX BAND

E

## VIEWINGS

By prior appointment only

| Energy Efficiency Rating                    |                         |           |
|---|-------------------------|-----------|
|   | Current                 | Potential |
| Very energy efficient - lower running costs |                         |           |
| (92 plus) A                                 |                         |           |
| (81-91) B                                   |                         |           |
| (69-80) C                                   |                         |           |
| (55-68) D                                   |                         |           |
| (39-54) E                                   |                         |           |
| (21-38) F                                   |                         |           |
| (1-20) G                                    |                         |           |
| Not energy efficient - higher running costs |                         |           |
| England & Wales                             | EU Directive 2002/91/EC |           |

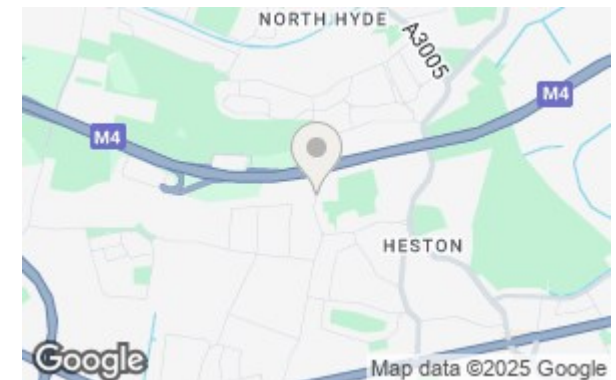

Agents Note: Whilst every care has been taken to prepare these particulars, they are for guidance purposes only. All measurements are approximate and are for general guidance purposes only and whilst every care has been taken to ensure their accuracy, they should not be relied upon and potential buyers/tenants are advised to recheck the measurements

**Shaw & Co**  
 ESTATE AGENTS

**OFFICE ADDRESS**  
 10 Central Parade  
 New Heston Road  
 Heston  
 Middlesex  
 TW5 0LJ

**OFFICE DETAILS**  
 0208 570 7258  
[heston@shawandcoestates.com](mailto:heston@shawandcoestates.com)