

Whilst every attempt has been made to ensure the accuracy of the floorplan, measurements of doors, windows and rooms are approximate. These plans are for representation purposes only as defined by RICS Code of Measuring Practice and used as such by any prospective purchaser. (ID1199856)

PRODUCED FOR BORLAND & BORLAND ESTATE AGENTS

Ground Floor

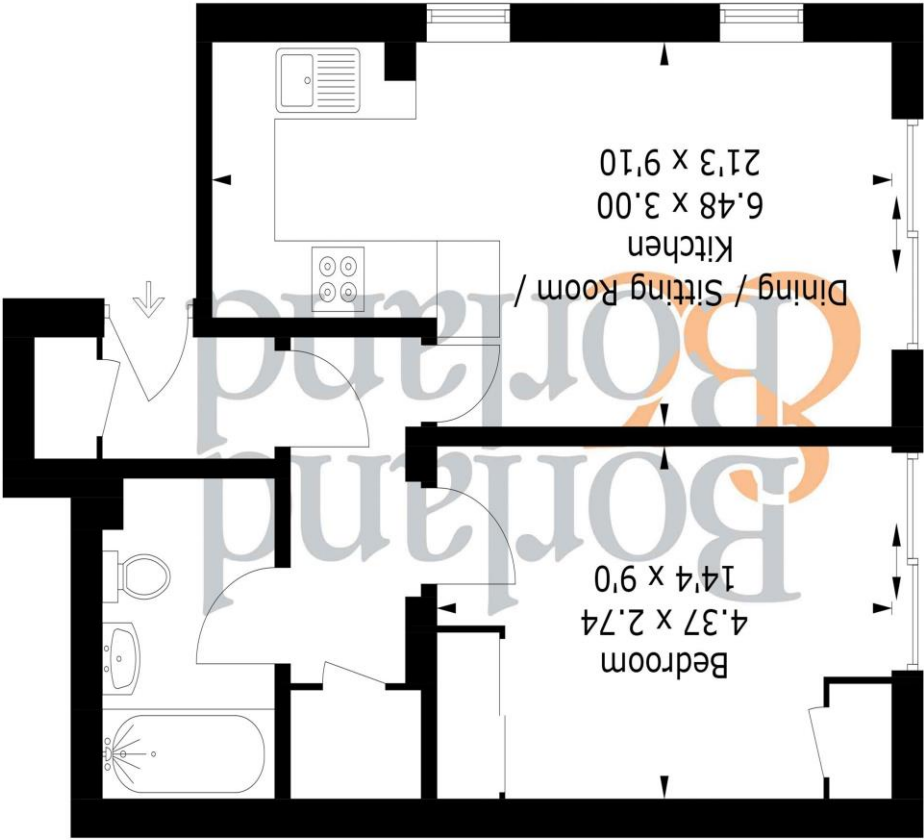

Flat 1, 27, North Street, PO10 7BY

Directions





NO FORWARD CHAIN... ONE BEDROOM GROUND FLOOR FLAT, WITH COURTYARD... Ideally placed just a brief stroll from Emsworth recreation ground and Railway station, Emsworth Square is a short distance to the south with its range of local shops, pubs and restaurants as well as doctor and dentist surgeries. The accommodation comprises: Entrance Hall, Open plan Kitchen/Sitting/ Dining room, Double Bedroom, Bathroom & two storage cupboards. Outside is a small courtyard garden. The property is in need of some modernisation.

Emsworth is situated on the upper reaches of Chichester Harbour, a National Landscape (formerly an Area of Outstanding Natural Beauty). Considered one of the best locations of the south coast for sailing and walking, the town of Emsworth has an attractive range of local sights, amenities, sailing clubs, boat yards, restaurants and is within easy travelling distance of the historic City of Chichester. Connects to Mainline railway station to London at nearby Havant.



- GROUND FLOOR
- ONE BEDROOM FLAT
- COURTYARD GARDEN
- OPEN PLAN KITCHEN/DINING/SITTING ROOM

- PERFECT FIRST TIME BUY OR INVESTMENT BUY
- CLOSE TO THE CENTRE OF TOWN
- CLOSE TO THE TRAIN STATION
- NO FORWARD CHAIN