





# 28B Beach Road, Emsworth, Hampshire PO10 7JS



PRIME LOCATION & NO FORWARD CHAIN for this Detached Family Home occupying a large garden plot in the much sought-after South West corner of Emsworth. Chichester Harbour Foreshore is within a short walk, as are Emsworth Sailing Club, Millpond and Emsworth Town Square.

On the Ground Floor there is an Entrance Hall, Cloakroom, a Spacious Sitting Room with open fireplace and doors leading to a Dining Room, and a Kitchen. Upstairs there are Four Bedrooms, and a Family Bathroom. The property offers flexible living accommodation with the scope for extension, subject to planning, and it is worthy of full renovation and modernisation now required. To the exterior there is a large, mature rear garden, as well as ample car parking and a Garage. Viewing by Appointment Only – No Chain.

- PRIME LOCATION SOUTH A259
- DETACHED FAMILY HOME
- TWO RECEPTIONS & FOUR BEDROOMS
- REQUIRES UPDATING WITH SCOPE FOR EXTENSION SUBJECT TO USUAL CONSENTS.
- GAS HEATING
- MATURE REAR GARDEN
- GARAGE & OFF ROAD PARKING
- NO FORWARD CHAIN

Guide Price  
£750,000  
Freehold









## ACCOMMODATION

### Ground Floor:

- Entrance hall
- Cloakroom
- Sitting room
- Kitchen
- Dining room

### First Floor:

- Bedroom one
- Bedroom two
- Bedroom three
- Bedroom four
- Family bathroom

### External:

- Driveway
- Garage
- Generous enclosed rear garden









## LOCATION

Situated on the upper reaches of Chichester Harbour, an Area of Outstanding Natural Beauty, Emsworth village has a thriving community with a range of local shops, providing for everyday needs, including dentist/doctor surgeries plus pubs, restaurants, two Sailing Clubs.

Easy access to the A27, M27, A3 & trains direct to London, Gatwick & Brighton. Widely considered to be one of the most desirable destinations for recreational sailing, kayaking and paddle boarding, with numerous coastal walks close at hand.









## 28B, Beach Road, PO10 7JS

Approximate Gross Internal Area = 119.2 sq m / 1283 sq ft

Garage = 19.4 sq m / 209 sq ft

Total = 138.6 sq m / 1492 sq ft

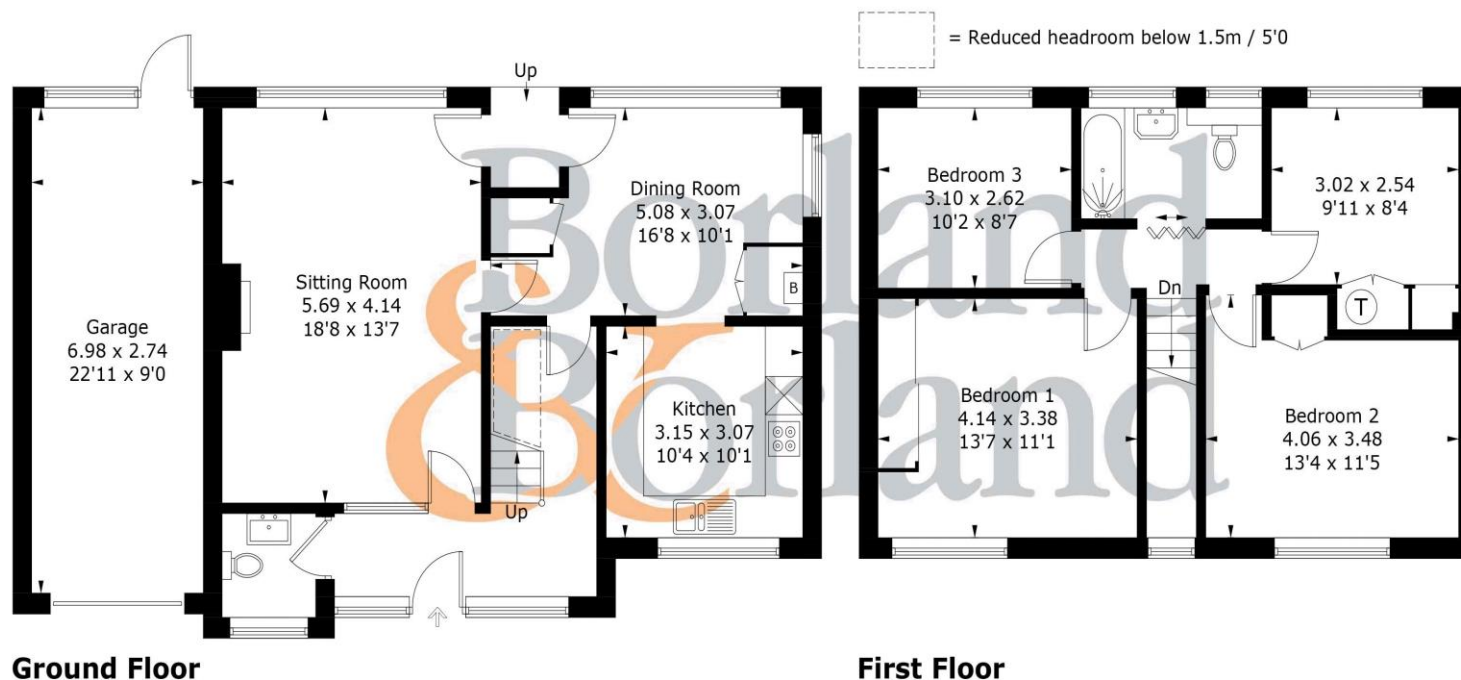

### Directions

SAT NAV: PO10 7JS

WHAT THREE WORDS: Dizzy.Hugs.Arch

### PRODUCED FOR BORLAND & BORLAND ESTATE AGENTS

Whilst every attempt has been made to ensure the accuracy of the floorplan, measurements of doors, windows and rooms are approximate. These plans are for representation purposes only as defined by RICS Code of Measuring Practice and used as such by any prospective purchaser. (ID1159685)

‘IMPORTANT NOTICE Borland & Borland gives notice that: 1. These particulars do not constitute an offer or contract or part thereof. 2. All descriptions, photographs and plans are for guidance only and should not be relied upon as statements or representations of fact. All measurements are approximate and not necessarily to scale. Any prospective purchaser must satisfy themselves of the correctness of the information with the particulars by inspection or otherwise. 3. Borland & Borland does not have any authority to give any representations or warranties whatsoever in relation to this property (including but not limited to planning/building regulations), nor can it enter into any contract on behalf of the Vendor. 4. Borland & Borland does not accept responsibility for any expenses incurred by prospective purchasers in inspecting properties which have been sold, let or withdrawn. 5. If there is anything of particular importance to you, please contact this office and Borland & Borland will try to have the information checked for you.

9a High Street, Emsworth, Hampshire PO10 7AQ

Tel: 01243 377655

property@borlandandborland.co.uk

www.borlandandborland.co.uk

rightmove

