



6 Nightingale Close, Whalley, BB7 9XB
£110,000



6 Nightingale Close, Whalley, BB7 9XB

TO BE SOLD WITH A TENANT IN SITU

enjoying a prime position within the ever-desirable Calderstones Park development, this well maintained two-bedroom apartment combines stylish, low-maintenance living with the natural charm of the Ribble Valley. Surrounded by mature parkland and thoughtfully landscaped communal areas, the home offers a peaceful setting just moments from the bustling heart of Whalley village.

This first-floor apartment has been well maintained and offers a great opportunity for an investor looking for a an investment opportunity - with having a tenant in situ.



Other information

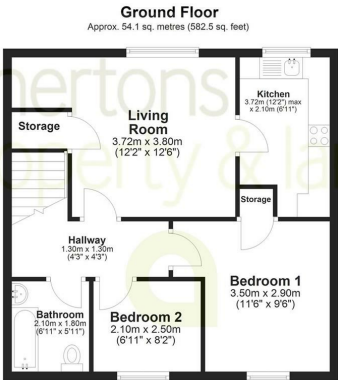
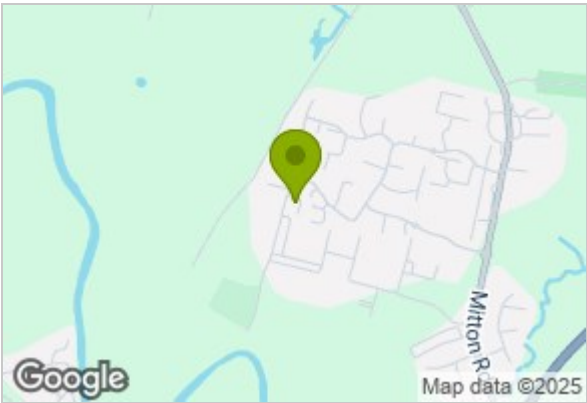

Total area: approx. 54.1 sq. metres (582.5 sq. feet)

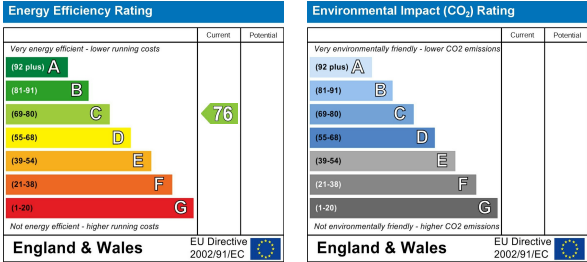

These particulars, whilst believed to be accurate are set out as a general outline only for guidance and do not constitute any part of an offer or contract. Intending purchasers should not rely on them as statements of representation of fact, but must satisfy themselves by inspection or otherwise as to their accuracy. No person in this firms employment has the authority to make or give any representation or warranty in respect of the property.