



11 Grove Street, Barrowford, BB9 8PW
£135,000

11 Grove Street, Barrowford, BB9 8PW

Nestled in the charming village of Barrowford, Pendle, this delightful mid-terrace house on Grove Street offers a perfect blend of character and modern living. Built in 1900, the property boasts a rich history while providing a comfortable and inviting atmosphere for its residents.

Spanning an impressive 848 square feet, this home features two well-proportioned reception rooms, ideal for both relaxation and entertaining. The layout allows for a seamless flow between spaces, making it perfect for family gatherings or quiet evenings in. The two bedrooms provide ample space for rest and rejuvenation, catering to a variety of living arrangements, whether for a small family, a couple, or even as a rental investment.

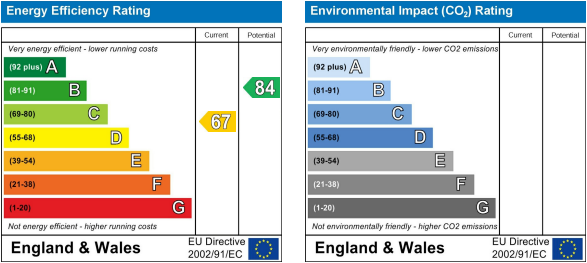
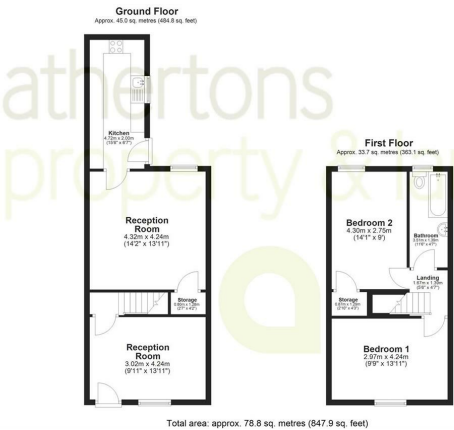

These particulars, whilst believed to be accurate are set out as a general outline only for guidance and do not constitute any part of an offer or contract. Intending purchasers should not rely on them as statements of representation of fact, but must satisfy themselves by inspection or otherwise as to their accuracy. No person in this firms employment has the authority to make or give any representation or warranty in respect of the property.