



22 Bouldsworth Road, Burnley, BB10 3JT
Offers In The Region Of £250,000

 2  1  1  A

22 Bouldsworth Road, Burnley, BB10 3JT

Located within a well-regarded development and surrounded by open countryside, this two-bedroom semi-detached true bungalow offers an excellent opportunity for those looking to downsize. Positioned on the outskirts of town, the property is conveniently located near the villages of Worsthorne and Hurstwood, just off Brownside Road. Local amenities and supermarkets are within walking distance at Pike Hill shopping parade, with regular bus routes providing easy access to Burnley town centre.

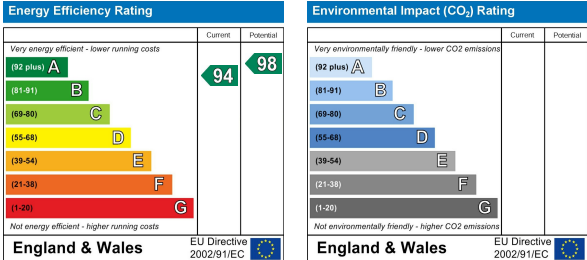
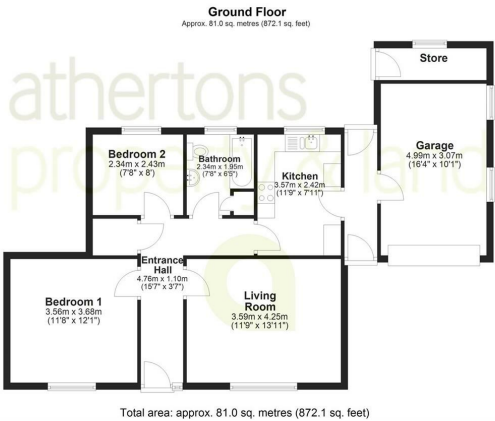
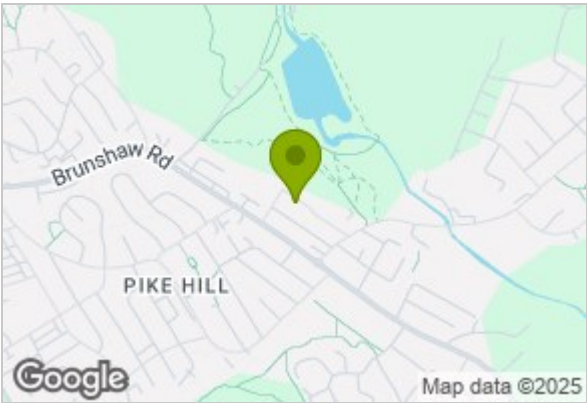

These particulars, whilst believed to be accurate are set out as a general outline only for guidance and do not constitute any part of an offer or contract. Intending purchasers should not rely on them as statements of representation of fact, but must satisfy themselves by inspection or otherwise as to their accuracy. No person in this firms employment has the authority to make or give any representation or warranty in respect of the property.