



This beautifully presented stone-built home provides spacious family accommodation, including four reception rooms and five bedrooms all set in show-stopping gardens and grounds extending to just under one acre. There is also garaging and an outbuilding. The property has been significantly improved and renovated by the present owners to an exceptional standard, including the conversion of attached outbuildings, to create an extremely versatile and spacious residence. The property is approached by a private track leading to an open paved parking area to the front and rear, with a stone-built double garage and car port.

Situated just a short drive from Longridge and Ribchester and close to all amenities, the property is also close to the main road and motorway network - ideal for commuters. All Longridge schools, along with St. Mary's Hall and Stonyhurst College, are within easy reach.

Higher College Farm has a lovely rural feel and is set back from the road. Although adjacent to some commercial premises, the beautiful Georgian farmhouse retains its privacy extremely well, with high surrounding stone walls and mature hedgerows bordering the large front and rear gardens.

The front door opens into an entrance vestibule, which has a stone flagged floor and a glazed door leading into the open dining room; this features engineered oak flooring, a staircase to the first floor, downstairs WC, a utility room with base-level units, sink and plumbing for washer / dryer, original cast iron fireplace and open access into the kitchen / diner. The kitchen / diner boasts stone slab flooring, a stone and brick fireplace, a beamed ceiling, a range of shaker style base and eye-level units with granite worktops, a range of integrated appliances, Belfast sink and an external door to the rear gardens.

From the dining room, the property opens up to stylishly converted outbuildings that had previously served the farm's agricultural use. This amazing wing offers three bright and airy vaulted reception rooms, as well as a home office, boiler room and three-piece shower room which could easily be converted as a whole into a two-bedroom annexe for ageing parents wanting to be closer to family. The accommodation is adorned with King Post Truss vaulted ceilings, tiled flooring, exposed stone walls, floor to ceiling windows, multiple log burning stoves and lovely views over the gardens.

On the first floor, there is a spacious landing area with feature Georgian window, bedrooms one, two and three, en suite to the master and family bathroom. The main bedroom provides views across the gardens and out to the open countryside; it features fitted wardrobes and an en suite with a shower, wash hand basin in a unit, WC and heated towel rail. The statement four-piece family bathroom has a freestanding roll-top bath with cast iron feet, corner shower, chrome and porcelain towel rail, tiled floor and walls and Victorian pedestal wash basin.

There are three further attic bedrooms on the second floor, as well as a four-piece bathroom with tiled walls and floor, wall-mounted bath with a shower head fitting, corner shower, a WC and wall-mounted wash hand basin. The second floor also features a spacious landing area, which would make a fantastic games room or children's area with under eaves storage.

Externally, there is a large paved parking area, extensive lawned gardens to the front and rear and an open double garage with adjoining car port. The gardens are stunning, with mature planted areas including shrub and flower beds and an expanse of lawn sweeping around the property. There are plenty of mature trees and hedgerows, creating a very private feel from the adjacent commercial premises. An adjoining field to the rear of the property has planning approval from Ribble Valley Borough Council for light commercial premises; the planning reference number (3/2022/0553).

### **Services**

All mains services are connected.

### **Tenure**

We understand from the owners to be Freehold.

### **Council Tax**

Band G.

### **Energy Rating (EPC)**

F (30).

### **Viewings**

Strictly by appointment only.

### **Office Hours**

53 King Street, Whalley BB7 9SP  
Monday to Friday 9.00am to 5.00pm  
Saturday 9.30am to 2.30pm

### **Money Laundering Regulations**

Money Laundering Regulations under The Money Laundering, Terrorist Financing and Transfer of Funds (information on the payer) Regulations 2017 (SI 2017/692), brought into effect in June 2017.

We are now required to undertake due diligence checks on intending bidders / prospective purchasers prior to any bid being accepted. Any intending bidders / prospective purchasers should therefore provide us with photographic identification (current passport or driving licence) and proof of address (utility bill no older than three months old or current Council Tax bill) at our office before the sale or the auctioneer prior to the commencement of sale.

The successful bidder / prospective purchaser will be required by us to complete an Identification Verification Questionnaire form (which will incorporate prescribed information, identification documentation etc.) already given in the instance of purchase by auction.









**Ground Floor**  
Approx. 219.3 sq. metres (2360.0 sq. feet)

**Outbuilding**  
Approx. 52.6 sq. metres (566.5 sq. feet)



**First Floor**  
Approx. 80.6 sq. metres (867.8 sq. feet)



**Second Floor**  
Approx. 79.1 sq. metres (851.1 sq. feet)

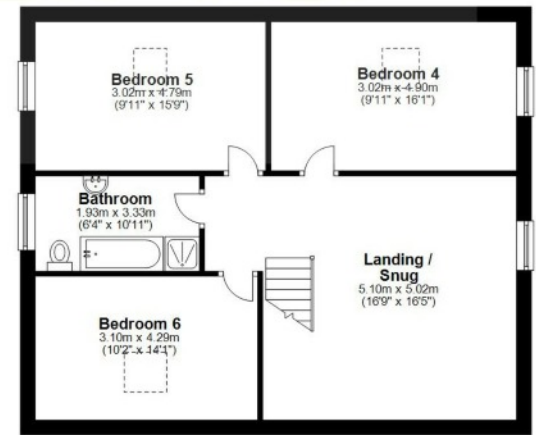

Total area: approx. 431.6 sq. metres (4645.4 sq. feet)











The image is a site plan or map of a farm. A large, irregular area is outlined in red. Inside this red boundary, there are several rectangular shapes representing buildings or structures. Some are simple rectangles, while others are more complex, possibly representing a house or a larger farm building. A road or path is shown as a dashed line on the left side of the red boundary. The text 'Higher College Farm' is centered in the upper part of the red area. Below it, the area is specified as '0.828 acres (3351.13 m²)'. The word 'Def' is written vertically in purple on the left side of the red boundary. There are also some small pink circles on the map, one near the top left and one near the bottom left.

# Higher College Farm

Area: 0.828 acres (3351.13 m<sup>2</sup>)

Def







Established since 1994, Athertons are specialists in the sale and purchase of homes and land throughout the North West. We have offices in Whalley and Barrowford and with our expert local knowledge and a specialist service, our aim is to make the experience of buying and selling property and land a positive one. Athertons Property & Land has been successfully selling houses in the Lancashire property market for well over 30 years. During this time we have developed the valuable expertise and experience required to make the most of every opportunity to secure a sale whilst at the same time achieving the maximum price possible for your home.

Selling any residential property whether it is your home or an investment is a significant and potentially stressful experience. At Athertons our aim is to ensure you a smooth, efficient and satisfying experience when selling your property. Our industry knowledge means we are able to provide you with more than an efficient selling experience but as much personal advice for your circumstances as you would like. Our sales and marketing approach uses both traditional values of communications together with evolving new technologies and this has allowed us to both improve the promotion of our clients' properties and deliver the most relevant information to our many registered buyers.

specialists in the sale and purchase of homes and land throughout the North West

# meet the team



John Atherton -  
Managing Director



Helen Jones -  
Conveyancing Manager



Tom Brown -  
New Build Sales Manager



Mags Twist -  
Office Administrator



Phil Ashton -  
Director / Lettings Cloud



Jim Atherton -  
Director, Sales Manager



Simon Kerins -  
Sales Negotiator & Land  
Management



Mollie Bentley -  
Marketing Manager



Robin Astles -  
Estate Agent



Emily Raine -  
Property Management  
Assistant / Lettings Cloud

specialists in the sale and purchase of homes and land throughout the North West