



Westmount Road, Eltham, SE9 1UT

**£825 PCM**

Situated within the heart of Eltham Park just a short walk to both main line station and the High Street comes a newly decorated studio apartment. Internally the property comprises of an open plan living area to a kitchen and own private bathroom. With the property being immediately available demand is sure to be high so an internal viewing comes highly recommended. Bills excluded.

Floor Plan

- COMMUNAL ENTRANCE
- STUDIO ROOM
- KITCHENETTE
- PRIVATE BATHROOM

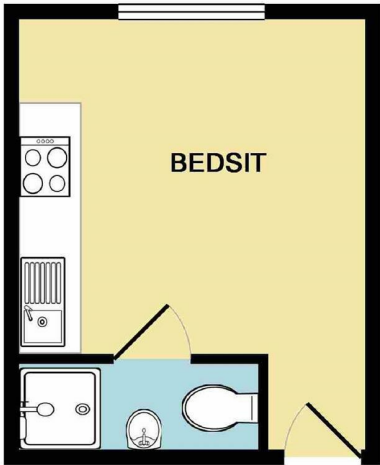

Measurements are approximate. Not to scale. Illustrative purposes only  
Made with Metropix ©2016

Area Map

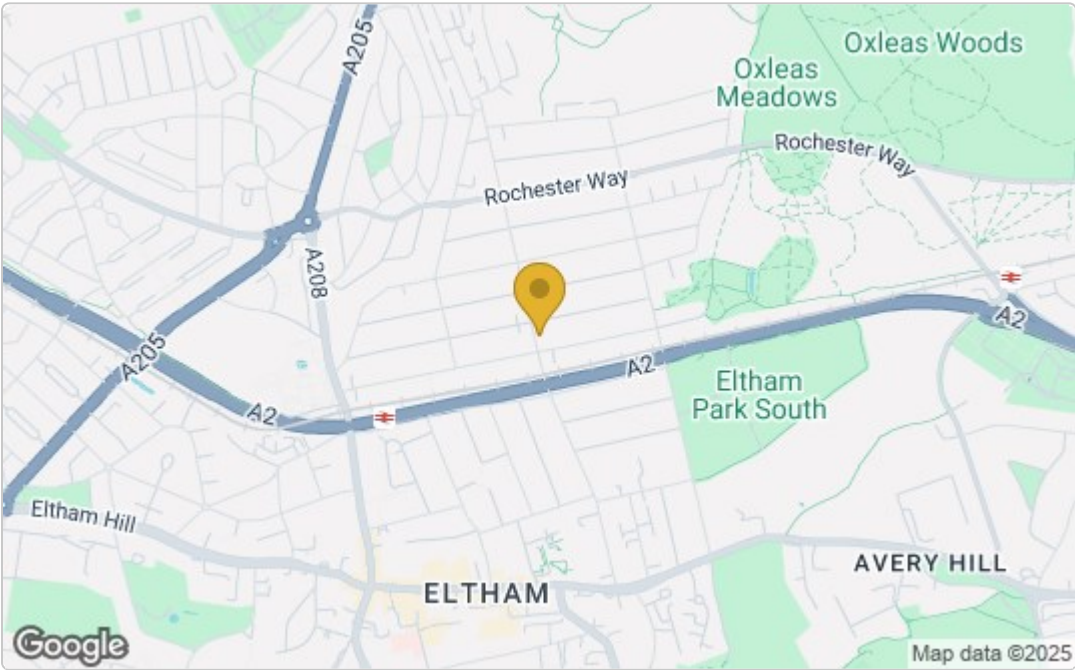

Energy Efficiency Graph

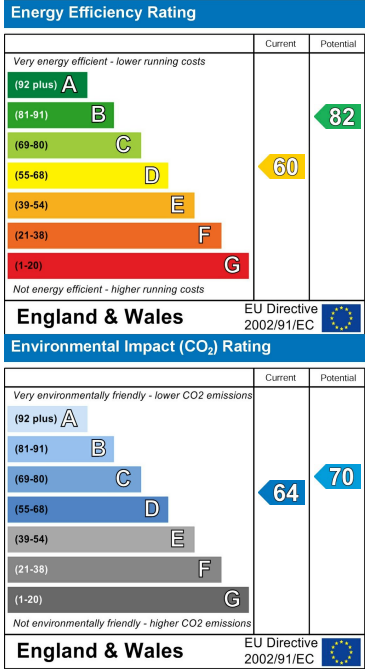

These particulars, whilst believed to be accurate are set out as a general outline only for guidance and do not constitute any part of an offer or contract. Intending purchasers should not rely on them as statements of representation of fact, but must satisfy themselves by inspection or otherwise as to their accuracy. No person in this firms employment has the authority to make or give any representation or warranty in respect of the property.