

Westmount Estates



Westmount Road, London, SE9 1XA

£1,300 PCM

AVAILABLE IMMEDIATELY. Centrally located for both Eltham High Street and mainline station.

Westmount Estates have pleasure in offering this ONE bedroom second floor apartment. Internally the accommodation comprises a sizable lounge, modern fitted kitchen and bathroom and a double bedroom.

EPC rating C. Council Tax Greenwich band B.

COMMUNAL ENTRANCE

A multi paneled door with entry phone system to a communal hallway with stairs to second floor, hardwood door to the entrance hall.

ENTRANCE HALL

Entry phone system, door housing large storage cupboard, radiator, centre light point.

LOUNGE 15'1" x 12'9" (4.6 x 3.9)

A double glazed window to front, radiator, coved ceiling, centre light point.

FITTED KITCHEN 10'9" x 5'10" (3.3 x 1.8)

A modern fitted kitchen with a range of eye and base units, roll top work surface with tiled surround, built in oven and four ring gas hob with extractor fan over, single sink unit with stainless steel drainer and mixer taps, plumbing for washing machine, space for a free standing fridge freezer, double glazed window to front, extractor fan, radiator, centre light point.

BEDROOM ONE 13'9" x 10'2" (4.2 x 3.1)

A double glazed window to rear, radiator, centre light point.

BATHROOM 8'10" x 5'6" (2.7 x 1.7)

A three piece suite comprising panel enclosed bath with mixer taps and shower attachment and glass screen, pedestal wash hand basin, low flush w/c, radiator, double glazed frosted window to rear, extractor fan, centre light point.

Floor Plan

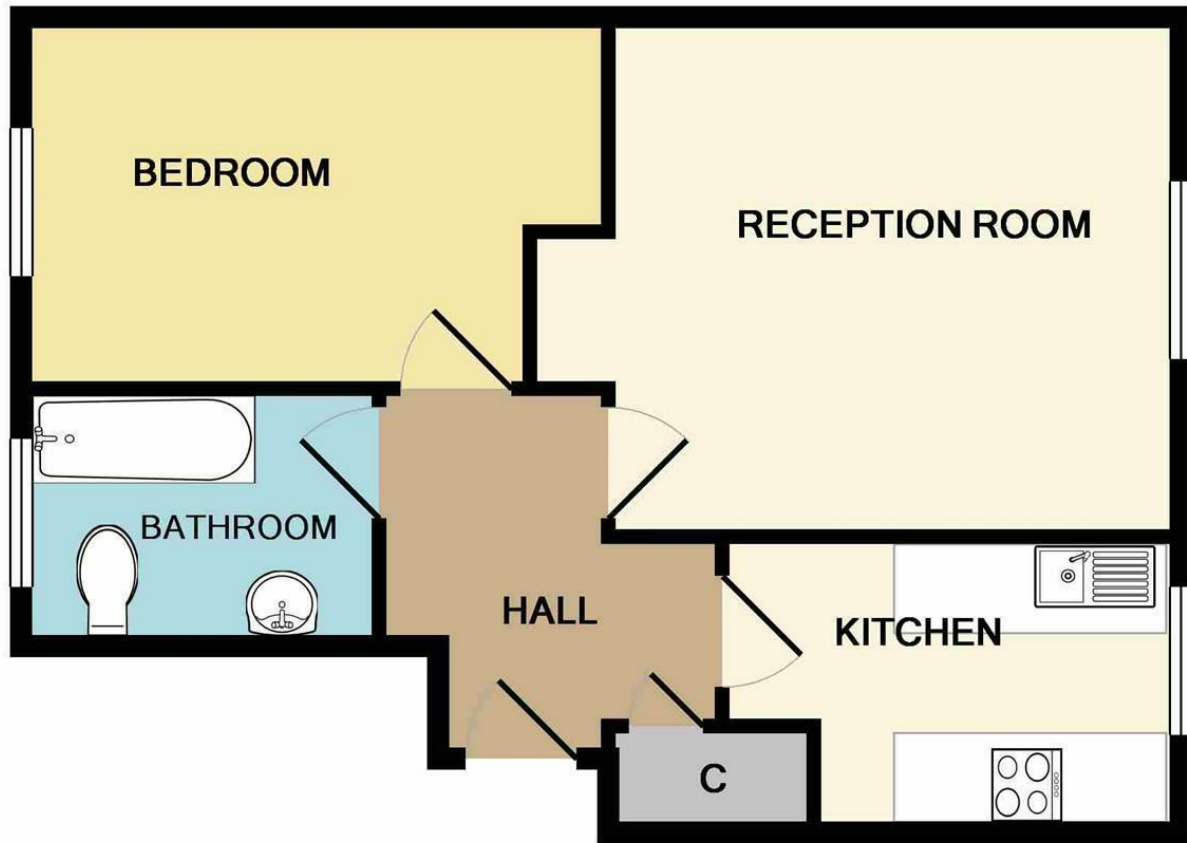

Measurements are approximate. Not to scale. Illustrative purposes only
 Made with Metropix ©2019

Area Map

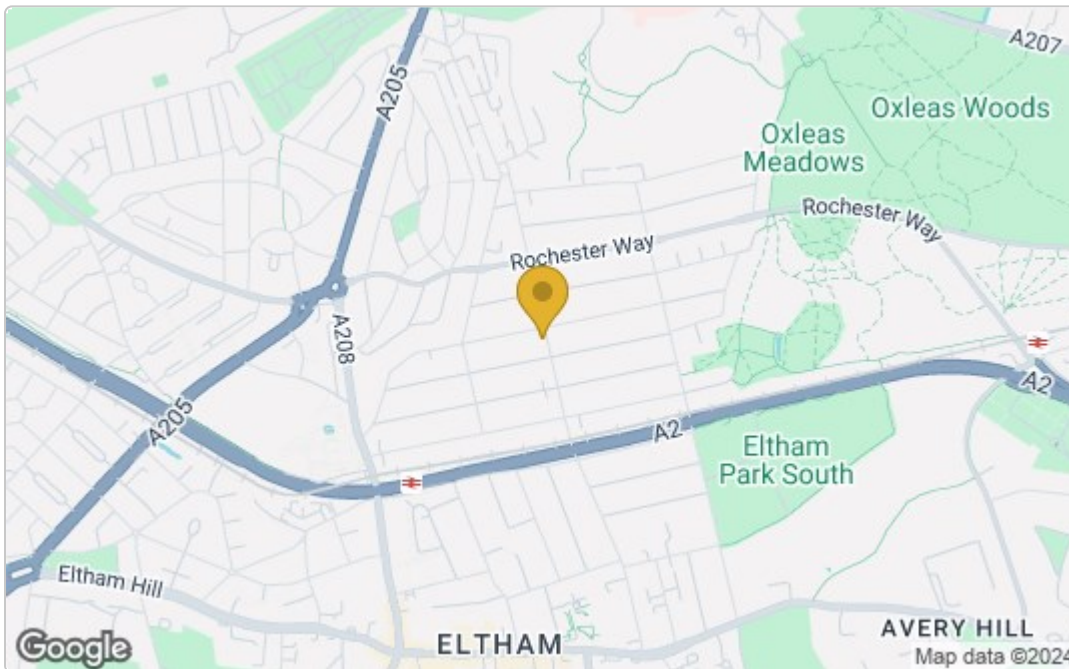

Energy Efficiency Graph

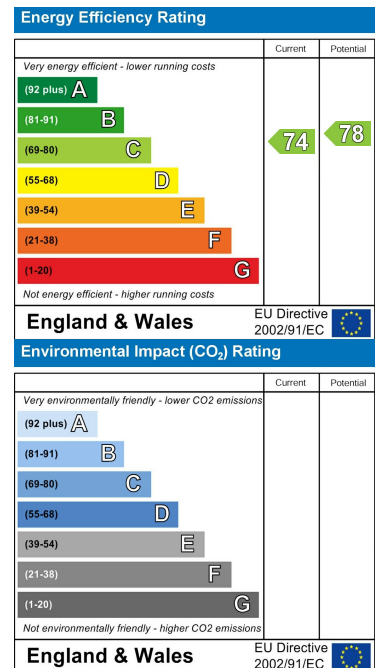

These particulars, whilst believed to be accurate are set out as a general outline only for guidance and do not constitute any part of an offer or contract. Intending purchasers should not rely on them as statements of representation of fact, but must satisfy themselves by inspection or otherwise as to their accuracy. No person in this firm's employment has the authority to make or give any representation or warranty in respect of the property.