

# Westmount Estates

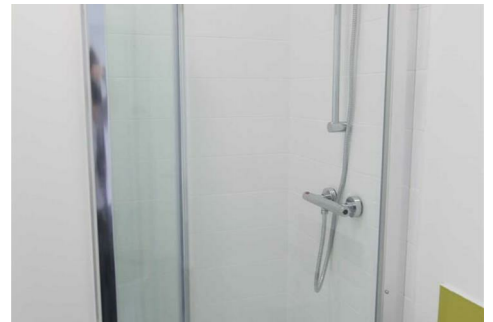

Well Hall Parade, London, SE9 6SP

**£950 PCM**

AVAILABLE IMMEDIATELY comes this newly decorated studio situated within close proximity to a parade of shops and Eltham Station, ideal for anyone needing an easy commute to central London. Internally the property comprises of a large studio, kitchenette with space for washing machine and bathroom comprising of low level w.c, wash hand basin and shower unit. Enquire today to avoid disappointment.

**ENTRANCE**

**STUDIO**

**KITCHENETTE**

**BATHROOM**

# Floor Plan

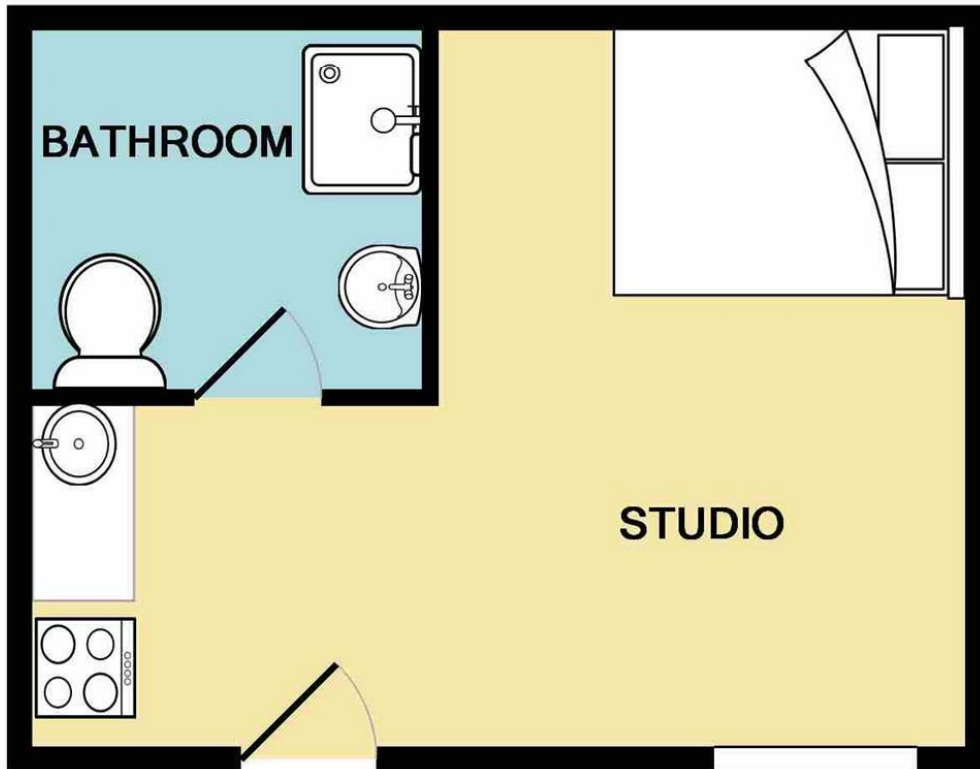

Measurements are approximate. Not to scale. Illustrative purposes only  
 Made with Metropix ©2018

## Area Map

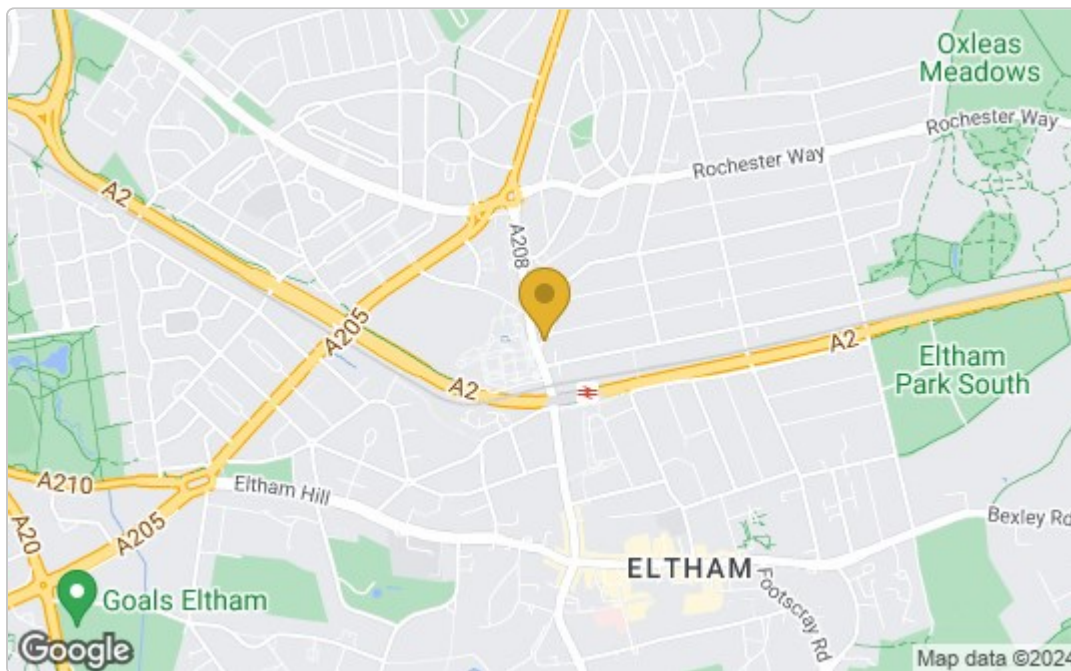

## Energy Efficiency Graph

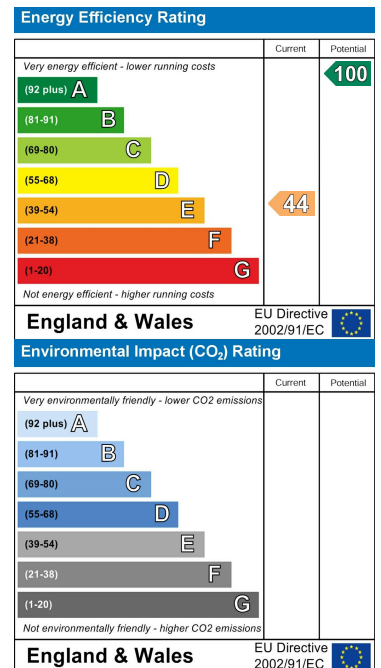

These particulars, whilst believed to be accurate are set out as a general outline only for guidance and do not constitute any part of an offer or contract. Intending purchasers should not rely on them as statements of representation of fact, but must satisfy themselves by inspection or otherwise as to their accuracy. No person in this firm's employment has the authority to make or give any representation or warranty in respect of the property.