



Heyford Grove

Hillfield, Solihull

- A Very Well Maintained Detached Family Home
- Spacious Lounge & Re-Fitted Kitchen/Diner
- Three Bedrooms & No Upward Chain
- Re-Fitted En-Suite Shower Room & Family Bathroom

Offers Over £485,000

Current EPC Rating - C
Current Council Tax Band - E





Property Description

A fully refurbished detached family home benefiting from no upward chain and offering accommodation comprising a spacious lounge, re-fitted kitchen/diner, re-fitted guest W.C, three bedrooms, re-fitted en-suite shower room, re-fitted family bathroom, rear garden, garage and driveway parking

Hillfield is a very sought after location near to Solihull Town Centre and within Tudor Grange Academy senior school catchment. There are local shops in Monkspath off Shelley crescent, where there is a doctors, dentists and the popular Farm gastropub and restaurant. Solihull town centre offers an excellent choice of shopping facilities including Touchwood shopping centre, Waitrose and John Lewis department store.

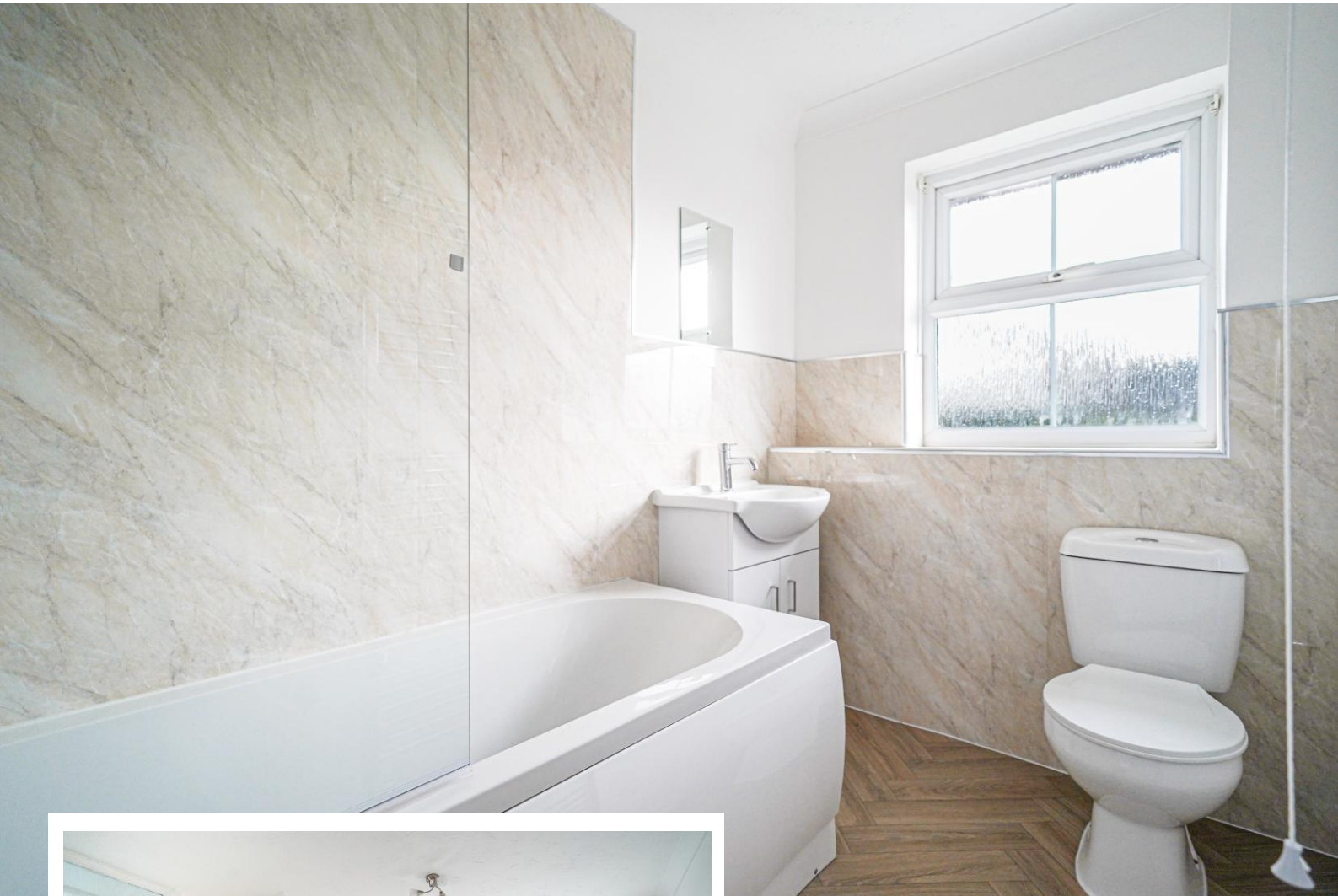

Rooms & Measurements

Lounge to Front 5.5m x 3.2m (18'0" x 10'5")

Re-Fitted Kitchen/Diner to Rear 5.8m x 2.6m (19'0" x 8'6")

Guest W.C

Bedroom One to Rear 3.9m x 3.2m max (12'9" x 10'5" max)

Re-Fitted En-Suite Shower Room

Bedroom Two to Front 3.3m x 3.2m (10'9" x 10'5")

Bedroom Three to Front 2.6m x 2.5m (8'6" x 8'2")

Re-Fitted Family Bathroom to Rear 2.4m x 1.5m (7'10" x 4'11")

Garage 4.9m x 2.4m (16'0" x 7'10")

Tenure

We are advised by the vendor that the property is freehold. We would advise all interested parties to obtain verification through their own solicitor or legal representative.

EPC supplied by vendor. Current council tax band – E

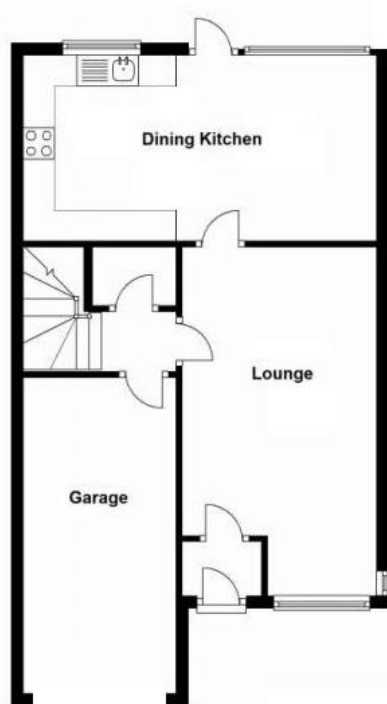

316 Stratford Road
Shirley
Solihull
B90 3DN

www.smart-homes.co.uk
0121 744 4144

Agents Note: Whilst every care has been taken to prepare these particulars, they are for guidance purposes only. We believe all information to be correct from the day of marketing however, we advise and recommend that your conveyancer and or surveyor verifies all information supplied. All measurements are approximate are for general guidance purposes only and whilst every care has been taken to ensure their accuracy, they should not be relied upon and potential buyers are advised to recheck the measurements.