



Rumbush Lane

Dickens Heath, Solihull

- A Three Bedroom Mews Style Property
- Lounge
- Kitchen Diner
- En Suite To Master & Family Bathroom
- Garage & Off Road Parking
- NO UPWARD CHAIN

Offers Over £315,000

Current EPC Rating 74 (C)
Current Council Tax Band D





Property Description

A three bedroom mews style property offered for sale with no upward chain and briefly affording lounge, kitchen diner, en suite shower room, family bathroom, private rear garden, garage, off-road parking, UPVC double glazing and gas central heating

Dickens Heath village offers a contemporary life style with a superb range of family homes and apartments, restaurants, offices, shops, medical surgeries as well as a local library, village hall and village green to provide that community lifestyle. Set within easy access to the M42 and train stations the village is ideal for families and commuters.



Rooms & Measurements

Entrance Hall

Lounge to Front - 4.6m x 3.2m (15'1" x 10'5")

Kitchen Diner to Rear - 4.3m x 2.5m (14'1" x 8'2")

Master Bedroom to Front - 3.7m x 3m (12'1" x 9'10")

En Suite Shower Room

Bedroom Two to Rear - 2.7m x 2.3m (8'10" x 7'6")

Dual Aspect Bedroom Three - 3.9m x 2.4m (12'9" x 7'10")
(some head height restriction)

Family Bathroom to Side - 2m x 1.8m (6'6" x 5'10")

Garage - 5.1m x 2.5m (16'8" x 8'2")

Tenure

We are advised by the vendor that the property is freehold with a service charge of £108 per annum, but are awaiting confirmation from the vendor's solicitor. We would advise all interested parties to obtain verification through their own solicitor or legal representative

EPC supplied by vendor

Current council tax band – D

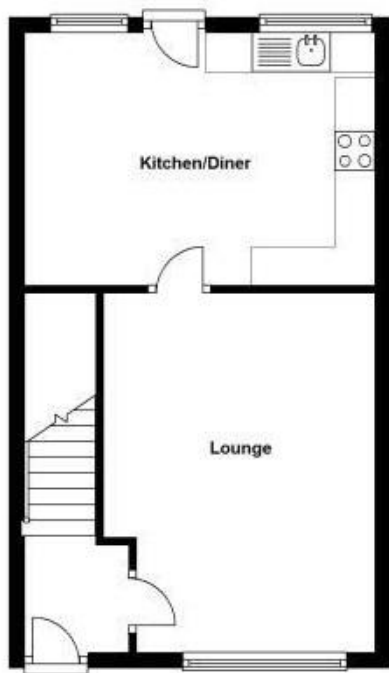
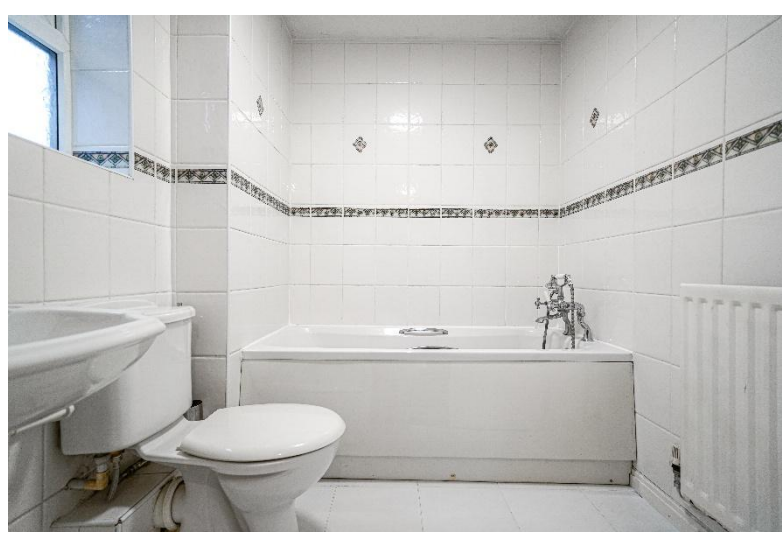

316 Stratford Road
Shirley
Solihull
B90 3DN

www.smart-homes.co.uk
0121 744 4144

Agents Note: Whilst every care has been taken to prepare these particulars, they are for guidance purposes only. We believe all information to be correct from the day of marketing however, we advise and recommend that your conveyancer and or surveyor verifies all information supplied. All measurements are approximate and are for general guidance purposes only and whilst every care has been taken to ensure their accuracy, they should not be relied upon and potential buyers are advised to recheck the measurements.