



6a Belmont Terrace Terrace Road

Buxton, SK17 6DZ

£137,500



6a Belmont Terrace Terrace Road

Buxton, SK17 6DZ

Tenure Leasehold Council Tax Band A



A fully refurbished spacious, two bedroom ground floor maisonette, centrally located in Higher Buxton and The Market Place and within easy walking distance of it's many amenities and the town centre. With brand new kitchen and bathroom fittings, combi gas fired central heating and sealed unit double glazing throughout. Private rear yard. An ideal first time buy or investment purchase. Viewing is highly recommended. No onward chain.

DIRECTIONS:

From our Buxton office, bear left and proceed up Terrace Road and after a short while Belmont Terrace will be seen on the right hand side.

GROUND FLOOR

Communal Entrance Hall

Lounge

13'8" x 12'11" (4.17m x 3.94m)

With two double radiators, security entrance telephone and a feature marbled fireplace with mantel over. With two wall light points and a sealed unit double glazed bay window to front.

Dining/Kitchen

14'5" x 14'1" (4.39m x 4.29m)

Fitted with a brand new range of base and eye level units and working surfaces, incorporating a stainless steel single drainer sink unit with tiled splash backs. With space and plumbing for a washing machine, space for a fridge/freezer, fitting for a cooker and stainless steel extractor over. Two wall light points and sealed unit double glazed window to rear.

Inner Hallway

10'4" x 5'4" (3.15m x 1.63m)

With door to outside and door to lower ground floor.

Bathroom

8'3" x 7'6" (2.51m x 2.29m)

Fully tiled throughout and fitted with an excellent quality suite comprising of panelled bath, pedestal washbasin and low level w.c. Frosted window, wall mounted Alpha combination boiler, extractor fan and double radiator.

LOWER GROUND FLOOR

Hallway

4'4" x 4'2" (1.32m x 1.27m)

Bedroom One

14'7" x 13'6" (4.45m x 4.11m)

With sealed unit double glazed window to front and single radiator.

Bedroom Two

13'5" x 13'2" (4.09m x 4.01m)

With uPVC sealed unit double glazed window to rear and single radiator.

OUTSIDE

To the rear of the property there is a flagged yard.



Road Map



Hybrid Map



Terrain Map



Floor Plans

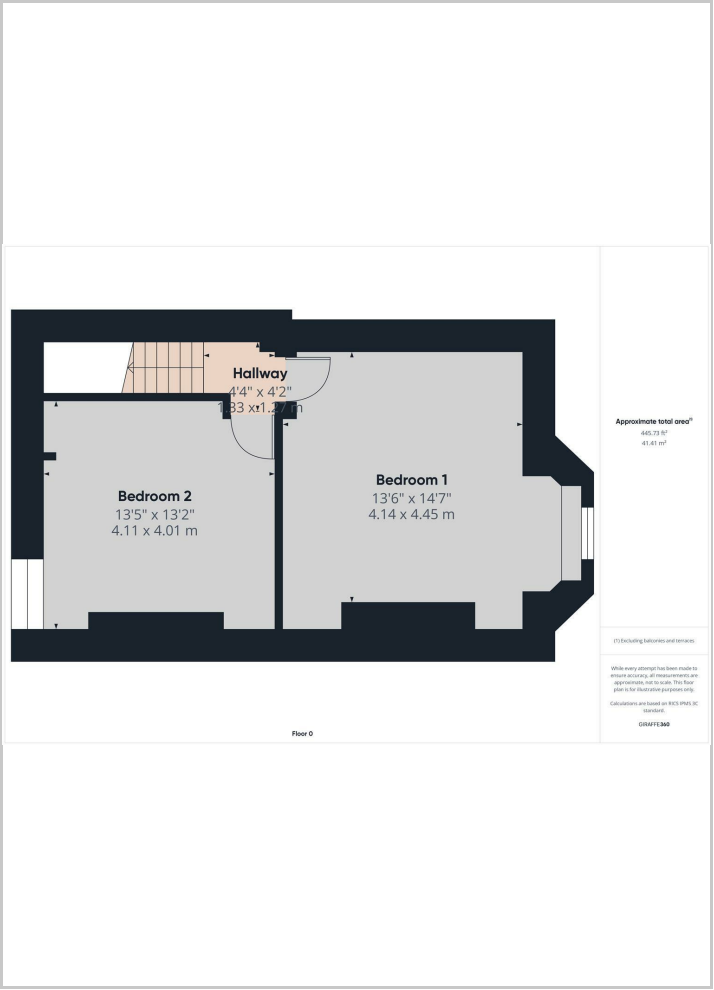

Viewing

Please contact our Jon Mellor & Company Office on 01298 24383 if you wish to arrange a viewing appointment for this property or require further information.

Important Notice

Jon Mellor & Company, their solicitors and joint agents give notice that:

1. They are not authorised to make or give any representations or warranties in relation to the property either here or elsewhere, either on their own behalf or on behalf of their client or otherwise. They assume no responsibility for any statement that may be made in these particulars. These particulars do not form part of any offer or contract and must not be relied upon as statements or representation of fact.
2. Any areas, measurements or distances are approximate. The text, photographs and plans are for guidance only and are not necessarily comprehensive. It should not be assumed that the property has all necessary planning building regulation or other consents and Jon Mellor & Company have not tested any services, equipment or facilities. Purchasers must satisfy themselves by inspection or otherwise.

1 Grove Parade, Buxton, Derbyshire, SK17 6AJ
Tel: 01298 24383 Email: info@mellors.org.uk www.mellors.org.uk

Energy Efficiency Graph

