



Everything you need to know about:

Old Hall Drive,  
Bamber Bridge, Preston,  
PR5 6EU



**Introduction**



**The Property**



**Local Authority**



**Transport Links**

**Education**



**Health**



**Local Policing**







### An invaluable insight into your new home

This i-PACK brochure offers an informed overview of **Old Hall Drive** as a potential new home, along with essential material about its surrounding area and its local community. It provides a valuable insight for any prospective owner or tenant.

We wanted to provide you with information that you can absorb quickly, so we have presented it as visually as possible, making use of maps, icons, tables, graphs and charts. Overall, the brochure contains information about:

- **The Property** - including property details, floor plans, room details, photographs and Energy Performance Certificate.
- **Transport** - including locations of bus and coach stops, railway stations and ferry ports.
- **Health** - including locations, contact details and organisational information on the nearest GPs, pharmacies, hospitals and dentists.
- **Local Policing** - including locations, contact details and information about local community policing and the nearest police station, as well as police officers assigned to the area.
- **Education** - including locations of infant, primary and secondary schools and Key Performance Indicators (KPIs) for each key stage.



**Farrell Heyworth** 309 Garstang Road, Preston, PR2 9XJ **01772 628054**





OLD HALL DRIVE, PRESTON £149,950



x2  
Bedrooms



x1  
Living Rooms



x1  
Bathrooms

Where you are

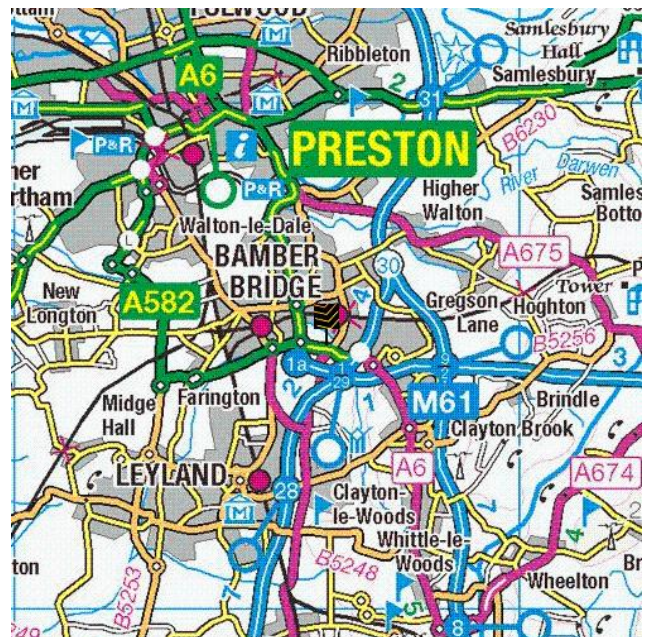
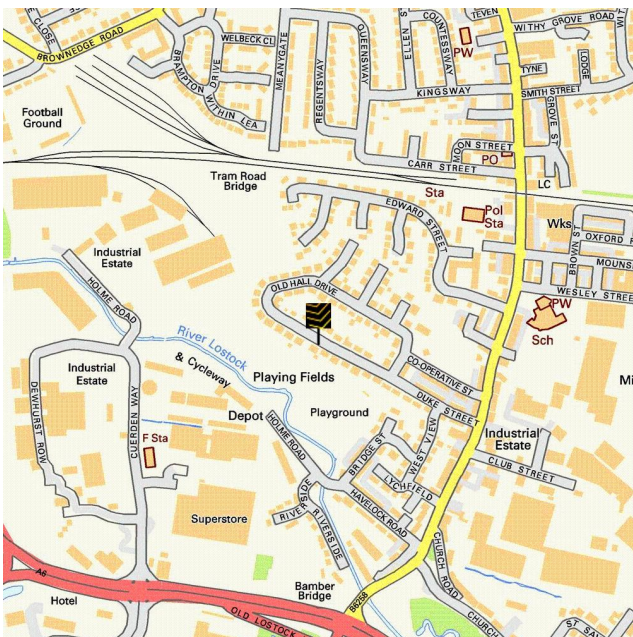





Rear Garden



Lounge image 3







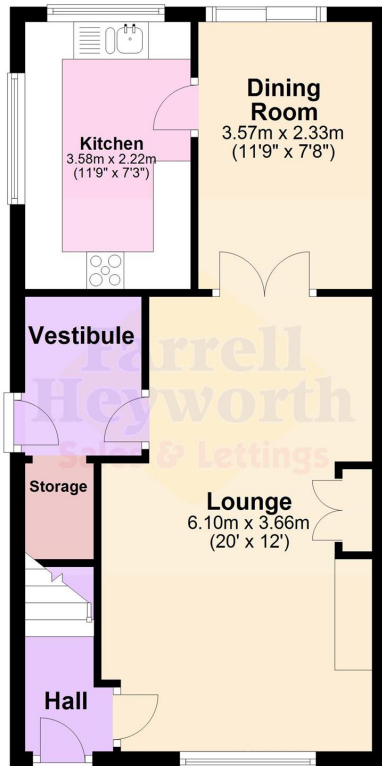

Ground Floor

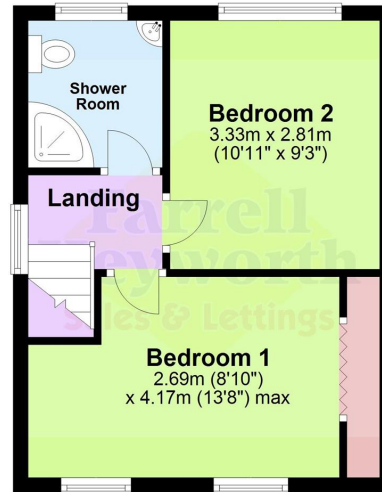

First Floor







Everything you want  
to know about  
local authorities







**Get to know your local authorities**

Local government directly affects quality of life, particularly when it comes to council tax, planning, waste disposal and the impact of local policies. You may want to investigate how this is likely to affect you if you decide to move. There are nearly 400 local authorities in England, with five different types of local government structure. These can be broadly divided into **single-tier** and **two-tier authorities**. Single-tier authorities are **Metropolitan Authorities, London Boroughs** and **Unitary or Shire Authorities**. Two-tier authorities have both a **County Council**, and a **District Council or City Council**. There are also around 10,000 parish and town councils, effectively creating an additional tier in some areas - mostly, but not exclusively, in rural areas. The National Association of Local Councils (NALC) represents and works on behalf of these community councils and is a useful contact point.

The local authority locations and contact details for **Old Hall Drive** are:

Shire / County / District	Website	Address	Contact details
---------------------------	---------	---------	-----------------

**Disclaimer:** The information displayed above has been obtained using the property's postcode in proximity to its local authority. It is recommended that this information is independently verified.





Everything you want  
to know about  
transport links









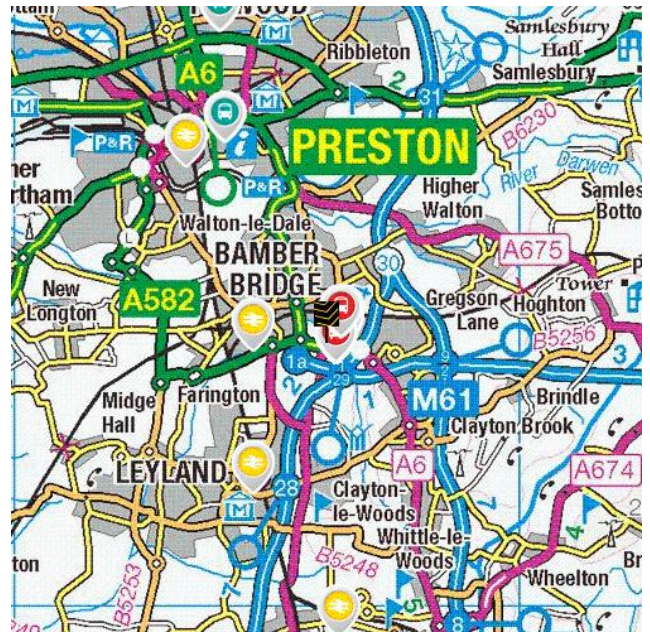

**Become familiar with public transport links**

Being able to choose to travel by public transport is important for many reasons. It helps to reduce congestion, provides access to work and education, and facilitates use of health and leisure facilities. If you or your family members travel abroad, access to the nearest ferry terminals is also likely to be a significant factor in choosing a new property. Using the maps below, you can pinpoint the precise locations of transport links for **Old Hall Drive**. Tables for each type of transport indicate the property's distance from the nearest bus stops, railway stations, coach stops and ferry terminals (providing that these facilities are within the scale proximity of the maps.)

**Transport Links**





	Airports	Approx Distance
	Blackpool International Airport	15.8 miles
	Liverpool John Lennon Airport	27.85 miles
	Manchester Airport	29.84 miles
	Leeds Bradford International Airport	42.18 miles
	Ferry ports	Approx Distance
	Knott End-On-Sea Ferry Landing	19.5 miles
	Fleetwood for Knott End Ferry Landing	19.71 miles
	Heysham Ferry Terminal	23.57 miles
	Liverpool Belfast Ferry Terminal Bootle	23.93 miles
	Liverpool Isle of Man & Dublin Terminal	25.91 miles
	Train Stations	Approx Distance
	Bamber Bridge Rail Station	0.23 miles
	Lostock Hall Rail Station	0.91 miles
	Leyland Rail Station	2.01 miles
	Preston Rail Station	2.81 miles
	Buckshaw Parkway Rail Station	3.57 miles

**Disclaimer:** The information represented in this section has been sourced from the Department of Transport's Open Data and is based on the property's postcode. It is recommended that this information is independently verified.



**Farrell Heyworth** 309 Garstang Road, Preston, PR2 9XJ 01772 628054



	Bus Stops	Approx Distance
	Edwards Street	0.19 miles
	Methodist Church	0.19 miles
	Hob Inn	0.22 miles
	Hob Inn	0.22 miles
	Rail Station	0.22 miles
	Coach Stops	Approx Distance
	Preston Bus Station	2.8 miles
	Fulwood (Preston) Coach Stop	4.08 miles
	Chorley Interchange	5.19 miles
	Blackburn: Boulevard Bus Station	7.69 miles
	Darwen Bus Station	8.38 miles

**Disclaimer:** The information represented in this section has been sourced from the Department of Transport's Open Data and is based on the property's postcode. It is recommended that this information is independently verified.



**Farrell Heyworth** 309 Garstang Road, Preston, PR2 9XJ **01772 628054**





Everything you want  
to know about  
local schools







### How are local schools performing?

If schools are important to you, then this section sets out the published Key Performance Indicators for schools near to your prospective new home. Key Performance Indicators look primarily at how well pupils perform in their tests and examinations, as well as some other measures like attendance.

If you want to know more about a particular school or college, you can also visit the Ofsted website <http://www.ofsted.gov.uk/inspection-reports/find-inspection-report>

## Local Schools

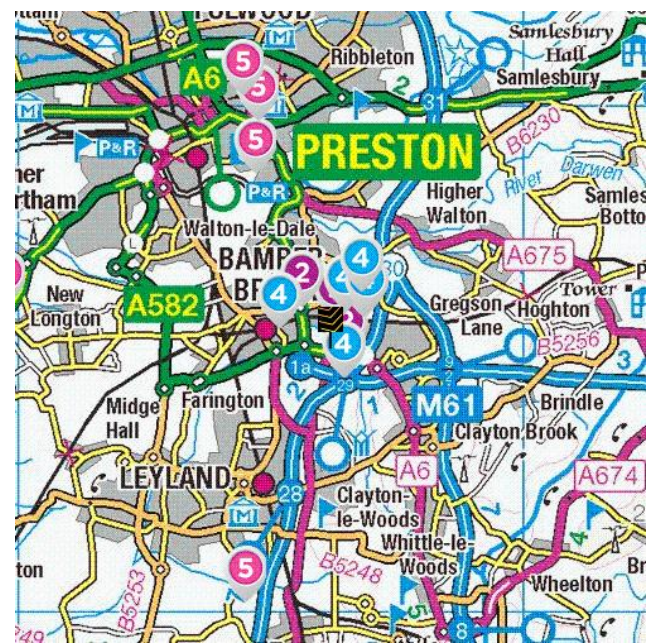
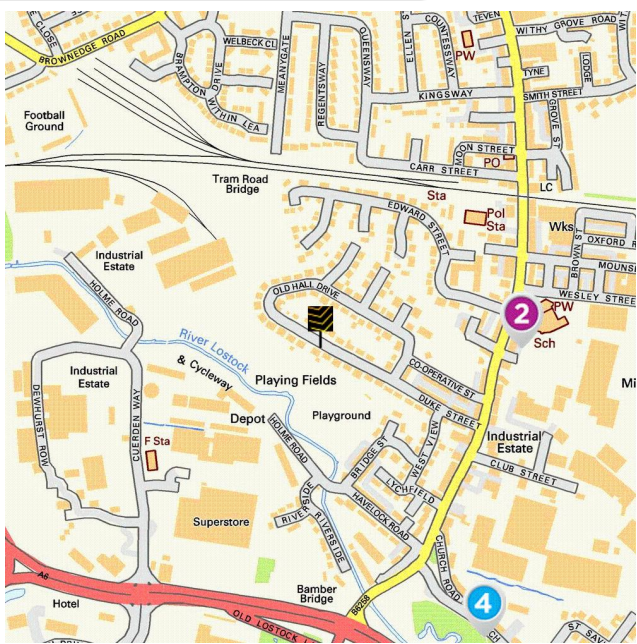



The next page shows tables and charts divided into Key Stages and a list of respective schools local to **Old Hall Drive**. There are four main age-related Key Stages defined as:





Special schools are marked with this icon

Key Stage	Definition
Key Stage 1	Fits broadly with the first stage of education, i.e. ages 5-7.
Key Stage 2	Fits the later stage of primary education, often known as junior schools, i.e. ages 8-11. This takes pupils up to the standardised break at age 11 after which pupils generally change schools and transfer to secondary education.
Key Stage 3	Secondary education split between key stages 3 and 4, with key stage 3 covering ages 11-13.
Key Stage 4	Key Stage 4 (ages 14-16) covers the two year period of study for GCSE level examinations.
Key Stage 5	Beyond key stage 4 is 16+ or Sixth Form provision, sometimes unofficially referred to as Key Stage 5.



**Farrell Heyworth** 309 Garstang Road, Preston, PR2 9XJ **01772 628054**

	Key Stage 2 - Information	Approx Distance
	<p><b>Name:</b> Cuerden Church School, Bamber Bridge  <b>Address:</b> Station Road, Preston, PR5 6ED  <b>Contact Number:</b> 01772335033  <b>Age Range:</b> 4-11 yrs  <b>Local Education Authority:</b> Lancashire  <b>Religious Character:</b> Church of England/Methodist</p>	0.2 miles
	<p><b>Name:</b> St Mary's and St Benedict's Roman Catholic Primary School  <b>Address:</b> Brownedge Lane, Preston, PR5 6TA  <b>Contact Number:</b> 01772336650  <b>Age Range:</b> 4-11 yrs  <b>Local Education Authority:</b> Lancashire  <b>Religious Character:</b> Roman Catholic</p>	0.41 miles
	<p><b>Name:</b> Bamber Bridge St Aidan's Church of England Primary School  <b>Address:</b> Larch Grove, Preston, PR5 6GX  <b>Contact Number:</b> 01772337321  <b>Age Range:</b> 5-11 yrs  <b>Local Education Authority:</b> Lancashire  <b>Religious Character:</b> Church of England</p>	0.63 miles
	<p>  <b>Name:</b> The Coppice School  <b>Address:</b> Ash Grove, Preston, PR5 6GY  <b>Contact Number:</b> 01772336342  <b>Age Range:</b> 2-19 yrs  <b>Local Education Authority:</b> Lancashire  <b>Religious Character:</b> Does not apply</p>	0.68 miles
	<p><b>Name:</b> Walton-le-Dale Community Primary School  <b>Address:</b> Severn Drive, Preston, PR5 4TD  <b>Contact Number:</b> 01772335065  <b>Age Range:</b> 3-11 yrs  <b>Local Education Authority:</b> Lancashire  <b>Religious Character:</b> Does not apply</p>	0.69 miles

**Disclaimer:** The information represented in this section has been sourced from the Department of Education's 2019 results data s and is based on the property's postcode.





## Reading, Writing and Maths

	Name	Expected	Higher
2	Cuerden Church School, Bamber Bridge	65.0 %	13.0 %
	St Mary's and St Benedict's Roman Catholic Primary School	65.0 %	5.0 %
	Bamber Bridge St Aidan's Church of England Primary School	48.0 %	4.0 %
	The Coppice School	N/A	N/A
	Walton-le-Dale Community Primary School	75.0 %	9.0 %
	<b>Lancashire</b>	64.0 %	10.0 %
<b>National</b>	65.0 %	11.0 %	

## Primary Progress Measures

As well as actual pupil performance in tests and exams an important Key Performance Indicator is that of progress measures that compare the actual achievements of other pupils nationally with similar prior attainment. Any increase in attainment achieved by each pupil will be reflected in the schools progress scores. They are fairer to schools in challenging circumstances, as they recognise a school that is doing a good job with an intake with poor prior attainment



## Progress Measures for 2019

	Name	Math	Reading	Writing
2	Cuerden Church School, Bamber Bridge	2.2 %	0.9 %	0.8 %
	St Mary's and St Benedict's Roman Catholic Primary School	0.7 %	0.0 %	-0.7 %
	Bamber Bridge St Aidan's Church of England Primary School	-3.5 %	-3.7 %	-0.9 %
	The Coppice School	N/A	N/A	N/A
	Walton-le-Dale Community Primary School	-1.2 %	-1.3 %	0.5 %

**Disclaimer:** The information represented in this section has been sourced from the Department of Education's 2019 results data set and is based on the property's postcode.



Farrell Heyworth 309 Garstang Road, Preston, PR2 9XJ 01772 628054

	Key Stage 4 - Information	Approx Distance
	 <p><b>Name:</b> Cumberland School  <b>Address:</b> Church Road, Preston, PR5 6EP  <b>Contact Number:</b> 01204324446  <b>Age Range:</b> 11-18 yrs  <b>Local Education Authority:</b> Lancashire  <b>Religious Character:</b> None</p>	0.32 miles
	<p><b>Name:</b> Brownedge St Mary's Catholic High School  <b>Address:</b> Station Road, Preston, PR5 6PB  <b>Contact Number:</b> 01772339813  <b>Age Range:</b> 11-16 yrs  <b>Local Education Authority:</b> Lancashire  <b>Religious Character:</b> Roman Catholic</p>	0.58 miles
	 <p><b>Name:</b> The Coppice School  <b>Address:</b> Ash Grove, Preston, PR5 6GY  <b>Contact Number:</b> 01772336342  <b>Age Range:</b> 2-19 yrs  <b>Local Education Authority:</b> Lancashire  <b>Religious Character:</b> Does not apply</p>	0.68 miles
	<p><b>Name:</b> Lostock Hall Academy  <b>Address:</b> Todd Lane North, Preston, PR5 5UR  <b>Contact Number:</b> 01772336293  <b>Age Range:</b> 11-16 yrs  <b>Local Education Authority:</b> Lancashire  <b>Religious Character:</b> Does not apply</p>	0.72 miles
	<p><b>Name:</b> Walton Le Dale High School  <b>Address:</b> Brindle Road, Preston, PR5 6RN  <b>Contact Number:</b> 01772335726  <b>Age Range:</b> 11-16 yrs  <b>Local Education Authority:</b> Lancashire  <b>Religious Character:</b> Does not apply</p>	0.87 miles

**Disclaimer:** The information represented in this section has been sourced from the Department of Education's 2019 results data s and is based on the property's postcode.





**Percentage of pupils achieving 5+ A\*-C/9-4 or equivalents including 9-4 in both English and mathematics GCSEs**

	Name	2019	2018	2017	2016
4	Cumberland School	0.0 %	0.0 %	0.0 %	0.0 %
	Brownedge St Mary's Catholic High School	58.0 %	64.0 %	61.0 %	68.0 %
	The Coppice School	N/A	N/A	N/A	N/A
	Lostock Hall Academy	76.0 %	64.0 %	75.0 %	55.0 %
	Walton Le Dale High School	60.0 %	60.0 %	50.0 %	44.0 %
	<b>Lancashire</b>	<b>66.0 %</b>	<b>66.1 %</b>	<b>61.7 %</b>	<b>58.5 %</b>
	<b>National</b>	<b>60.0 %</b>	<b>59.4 %</b>	<b>56.6 %</b>	<b>53.5 %</b>

**Disclaimer:** The information represented in this section has been sourced from the Department of Education's 2017 results data set and is based on the property's postcode.

**Average number of GCSE entries per pupil**

	Name	Number
4	Cumberland School	1.9
	Brownedge St Mary's Catholic High School	7.7
	The Coppice School	N/A
	Lostock Hall Academy	6.7
	Walton Le Dale High School	6.1
	<b>Lancashire</b>	<b>7.5</b>
	<b>National</b>	<b>7.1</b>

**Disclaimer:** The information represented in this section has been sourced from the Department of Education's 2019 results data set and is based on the property's postcode.



	Key Stage 5 - Information	Approx Distance
	<p><b>Name:</b> Cardinal Newman College  <b>Address:</b> Lark Hill Road, Preston, PR1 4HD  <b>Contact Number:</b> 01772460181  <b>Age Range:</b> 16+ yrs  <b>Local Education Authority:</b> Lancashire  <b>Religious Character:</b> Roman Catholic  <b>Admission Policy:</b> Not applicable</p>	2.42 miles
	<p><b>Name:</b> Preston Muslim Girls High School  <b>Address:</b> Quwwatul Education Centre, Preston, PR1 6QQ  <b>Contact Number:</b> 01772651906  <b>Age Range:</b> 11-19 yrs  <b>Local Education Authority:</b> Lancashire  <b>Religious Character:</b> Muslim</p>	3.02 miles
	<p><b>Name:</b> Runshaw College  <b>Address:</b> Langdale Road, Leyland, PR25 3DQ  <b>Contact Number:</b> 01772622677  <b>Age Range:</b> 16+ yrs  <b>Local Education Authority:</b> Lancashire  <b>Religious Character:</b> Does not apply  <b>Admission Policy:</b> Not applicable</p>	3.21 miles
	<p><b>Name:</b> Moor Park High School and Sixth Form  <b>Address:</b> Moor Park Avenue, Preston, PR1 6DT  <b>Contact Number:</b> 01772795428  <b>Age Range:</b> 11-18 yrs  <b>Local Education Authority:</b> Lancashire  <b>Religious Character:</b> None</p>	3.37 miles
	<p><b>Name:</b> Hutton Church of England Grammar School  <b>Address:</b> Liverpool Road, Preston, PR4 5SN  <b>Contact Number:</b> 01772613112  <b>Age Range:</b> 11-18 yrs  <b>Local Education Authority:</b> Lancashire  <b>Religious Character:</b> Church of England</p>	4.08 miles

**Disclaimer:** The information represented in this section has been sourced from the Department of Education's 2019 results data set and is based on the property's postcode.





**Percentage of A level students achieving at least three levels at grades AAB or better, at least two of which are in facilitating subjects**

	Name	%
5	Cardinal Newman College	13.1 %
	Preston Muslim Girls High School	N/A
	Runshaw College	16.3 %
	Moor Park High School and Sixth Form	0.0 %
	Hutton Church of England Grammar School	11.8 %
	<b>Lancashire</b>	<b>15.1 %</b>
	<b>National</b>	<b>16.5 %</b>

**Disclaimer:** The information represented in this section has been sourced from the Department of Education's 2019 results data set and is based on the property's postcode.

As well as actual pupil performance in tests and exams, an important Key Performance Indicator is that of Value Added. When pupils start a school, they all have varying levels of ability and social advantage. A school's Value Added score measures how much progress they have made from the beginning to the end of their compulsory secondary education (i.e. between the end of Key Stage 2 and the end of Key Stage 4). It is a quick measurement of the effect of a school on its pupils.

	Name	Value Added
5	Cardinal Newman College	0.2
	Preston Muslim Girls High School	N/A
	Runshaw College	0.0
	Moor Park High School and Sixth Form	0.1
	Hutton Church of England Grammar School	0.2



**Farrell Heyworth** 309 Garstang Road, Preston, PR2 9XJ 01772 628054



Everything you want  
to know about  
local health services







**How local are the health services?**

We all want good access to local health facilities, wherever we live. To see how well **Old Hall Drive** is served, we have set out below the exact locations of hospitals, Accident & Emergency centres, GPs, pharmacies, dentists, out-of-hours medical care and walk-in clinics. Where it's available, you will find more detailed information, including the names of practitioners and their contact details.

Hospitals		Approx Distance
	Chorley And South Ribble Hospital, Chorley and South Ribble Hospital, Chorley, Lancashire, PR7 1PP	4.23 miles
	Royal Preston Hospital, Sharoe Green Lane North, Preston, Lancashire, PR2 9HT	4.9 miles
	Royal Blackburn Hospital, Haslingden Road, Blackburn, Lancashire, BB2 3HH	8.15 miles
	Royal Albert Edward Infirmary, Wigan, Lancashire, WN1 2NN	11.65 miles
	Accrington Victoria Hospital, BB5 6AS	12.42 miles
A&E		Approx Distance
	Chorley And South Ribble Hospital, Chorley and South Ribble Hospital, Chorley, Lancashire, PR7 1PP	4.23 miles
	Royal Preston Hospital, Sharoe Green Lane North, Preston, Lancashire, PR2 9HT	4.9 miles
	Royal Blackburn Hospital, Haslingden Road, Blackburn, Lancashire, BB2 3HH	8.15 miles
	Royal Albert Edward Infirmary, Wigan, Lancashire, WN1 2NN	11.65 miles
	Southport And Formby District General Hospital, Southport, Merseyside, PR8 6PN	14.27 miles

	Walk-in Clinics	Approx Distance
	Dr T L Phillips At Barbara Castle Health Centre, Level Two, Lancashire, BB2 1AX	7.5 miles
	Royal Blackburn Hospital, Haslingden Road, Blackburn, Lancashire, BB2 3HH	8.15 miles
	Darwen Health Care, Darwen Health Centre, Lancashire, BB3 1PY	8.17 miles
	Accrington Victoria Hospital, BB5 6AS	12.42 miles
	Accrington Victoria Health Access Centre, Accrington Victoria Community Hospital, Accrington, Lancashire, BB5 6AS	12.42 miles
	GPs	Approx Distance
	THE RYAN MEDICAL CENTRE, THE RYAN MEDICAL CENTRE, PRESTON, PR5 6TE	0.34 miles
	ROSLEA SURGERY, ROSLEA SURGERY, PRESTON, PR5 6PE	0.62 miles
	MEDICARE UNIT SURGERY, MEDICARE UNIT, LANCASHIRE, PR5 5RS	1.11 miles
	LOSTOCK HALL VILLAGE SURGERY, VILLAGE SURG,1 WILLIAM ST, PR5 5RZ	1.16 miles
	LOSTOCK HALL MEDICAL CTR., LOSTOCK HALL MEDICAL CTR., WALTON-LE-DALE,PRESTON, PR5 5SA	1.25 miles
	Dental Surgeons	Approx Distance
	High Street Smiles, 107-109 High Street, WARRINGTON, Cheshire, WA3 3BZ	17.33 miles
	Mr Jm Kelly & Associates, 7A Stonecross Lane, WARRINGTON, Cheshire, WA3 2SA	17.62 miles
	L Askins, Woodgate, WARRINGTON, Cheshire, WA3 2QZ	17.93 miles
	Hob Hey Dental Practice, 3 Hob Hey Lane, WARRINGTON, Cheshire, WA3 4NQ	19.63 miles
	The Village Dental Practice, Warrington Road, WARRINGTON, Cheshire, WA3 5HH	19.73 miles

**Disclaimer:** The information represented in this section has been sourced from Experian and is based on the property's postcode.



**Farrell Heyworth** 309 Garstang Road, Preston, PR2 9XJ **01772 628054**





Everything you want  
to know about  
local policing





### Understanding who polices your neighbourhood

When you move to a new area, you want to know the arrangements for local community policing. See below for essential information about police services near to **Old Hall Drive**. We have included location and contact details for the police station and wherever possible, details of police officers assigned to the area.

#### Your policing neighbourhood

The name of your policing neighbourhood is **Bamber Bridge North/East/West and Walton le Dale** and it has a population of **17737**.

#### Your Local Policing Team

Name	Rank	Tel No.	E-mail
Teresa Smith	PCSO		
Lee Grant	Constable		

**Disclaimer:** The information represented in this section has been sourced from data.police.uk.

**Disclaimer:** The information represented in this section has been sourced from data.police.uk.







