

## Whitton Avenue West Northolt UB5 4JY

Price Guide: £280,000

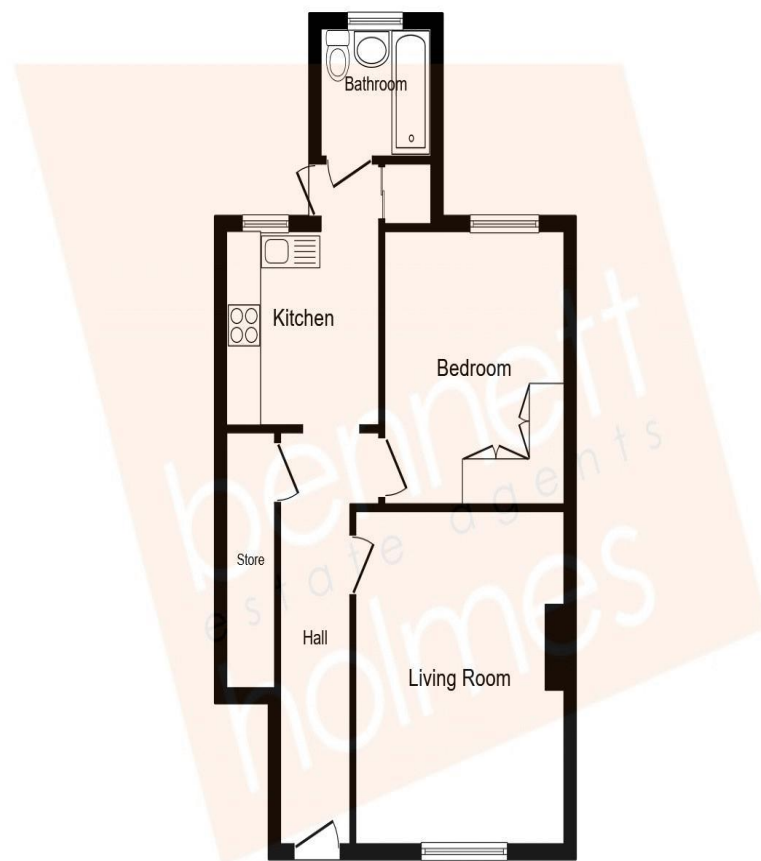

Floor Plan

Floor area 46.0 sq.m. (495 sq.ft.)

Total floor area: 46.0 sq.m. (495 sq.ft.)

This floor plan is for illustrative purposes only. It is not drawn to scale. Any measurements, floor areas (including any total floor area), openings and orientations are approximate. No details are guaranteed, they cannot be relied upon for any purpose and do not form any part of any agreement. No liability is taken for any error, omission or misstatement. A party must rely upon its own inspection(s). Powered by www.Propertybox.io



Leasehold - 990 years remaining  
999 years from 24 June 2016  
Service Charge £190 PA  
Peppercorn ground rent  
London Borough of Ealing  
Council tax band C - £1,814 PA  
EPC =C

### NORTHOLT OFFICE

83 Oldfields Circus Northolt, Middlesex UB5 4RU

sales: 020 8423 2222 lettings: 020 8423 0222

[northolt@bennetholmes.com](mailto:northolt@bennetholmes.com)

**IMPORTANT** Bennett Holmes would inform prospective purchasers that these sales particulars have been prepared as a general guide only. A detailed survey has not been carried out, nor the services, appliances and fittings tested. Room sizes should not be relied upon for furnishing purposes and are approximate. If floor plans are included, they are for guidance only and illustration purposes only and may not be to scale. If there are any important matters likely to affect your decision to buy, please contact us before viewing the property.



Bennett Holmes are pleased to offer this well presented, one double bedroom purpose built ground floor maisonette in Northolt. The property is within close distance to local shops, schools and transport. 0.6 miles to Northolt Park's Chiltern Railway Line station and 0.7 miles to Northolt's Central Line station. Other benefits include over 900 years remaining on the lease, own section of rear garden, double glazed windows, gas central heating and no upper chain.





- ONE DOUBLE BEDROOM
- GROUND FLOOR MAISONETTE
- PURPOSE BUILT
- OVER 900 YEARS REMAINING ON THE LEASE
- MODERN KITCHEN AND BATHROOM
- OWN SECTION OF REAR GARDEN
- DOUBLE GLAZED WINDOWS AND GAS CENTRAL HEATING
- NO UPPER CHAIN

**Whitton Avenue West  
Northolt  
UB5 4JY**

**Price Guide: £280,000**



## Accommodation

The accommodation briefly comprises own front door opening to the entrance hall with doors to a storage cupboard, the front aspect living room, the bedroom and the kitchen. The bedroom has fitted wardrobes. The kitchen is fitted with wall and base level units, a sink and drainer, an integrated 4 ring gas hob with an overhead extractor hood and integrated electric oven, there is plumbing for a washing machine. There is another storage cupboard housing the boiler with a door to the rear garden and the bathroom.

Outside the property is own section of rear garden.  
To the front of the property is communal parking.

