

## 9 Nower Hill Pinner HA5 5QR

Price Guide: Monthly Rental Of £925

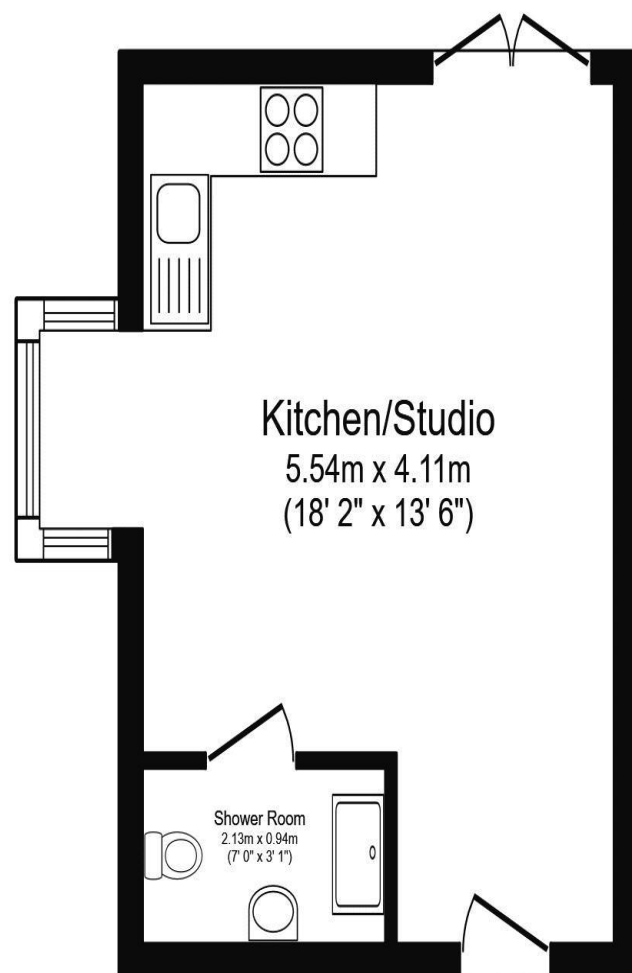

### Floor Plan

Total floor area 24.2 sq.m. (261 sq.ft.) approx

This plan is for illustration purposes only and may not be representative of the property. Plan not to scale.

Furnished  
London borough of Harrow  
Council tax band A  
Council tax £1,524 PA  
Water rates included.  
Available 5th June  
EPC =D

#### NORTHOLT OFFICE

83 Oldfields Circus Northolt, Middlesex UB5 4RU

sales: 020 8423 2222 lettings: 020 8423 0222

[northolt@bennetholmes.com](mailto:northolt@bennetholmes.com)

**IMPORTANT** Bennett Holmes would inform prospective purchasers that these sales particulars have been prepared as a general guide only. A detailed survey has not been carried out, nor the services, appliances and fittings tested. Room sizes should not be relied upon for furnishing purposes and are approximate. If floor plans are included, they are for guidance only and illustration purposes only and may not be to scale. If there are any important matters likely to affect your decision to buy, please contact us before viewing the property.



Bennett Holmes are delighted to offer for letting this modern ground floor studio flat. The property is suited in a prime residential location within easy reach of Pinner's transport links and shopping facilities. Benefits include electric heating, separate shower room and door to the communal garden. Studio is offered furnished with water rates included. AVAILABLE 5TH JUNE.





- STUDIO
- GROUND FLOOR
- COMMUNAL GARDEN
- ELECTRIC HEATING
- PRIME LOCATION WITHIN PINNER
- FURNISHED
- WATER RATES INCLUDED
- AVAILABLE 5TH JUNE

**9 Nower Hill  
Pinner  
HA5 5QR**

**Price Guide:** Monthly Rental Of £925



## Accommodation

This bright ground floor studio flat is ideally placed for those who are looking for access into Pinner, North Harrow and Hatch End. Accommodation comprises, communal front door leading to communal hallway, own front door to: studio room with double glazed door with access the communal garden, open plan to modern kitchen comprising washing machine, Fridge/freezer, electric oven and hob with stainless steel extractor hood over. Shower room with shower cubical, WC and wash had basin. Benefits include electric heating and communal garden. The property is offered for letting furnished and available 5th June.

