

Filton House

Approximate Gross Internal Area 37.4 sq m / 402 sq ft

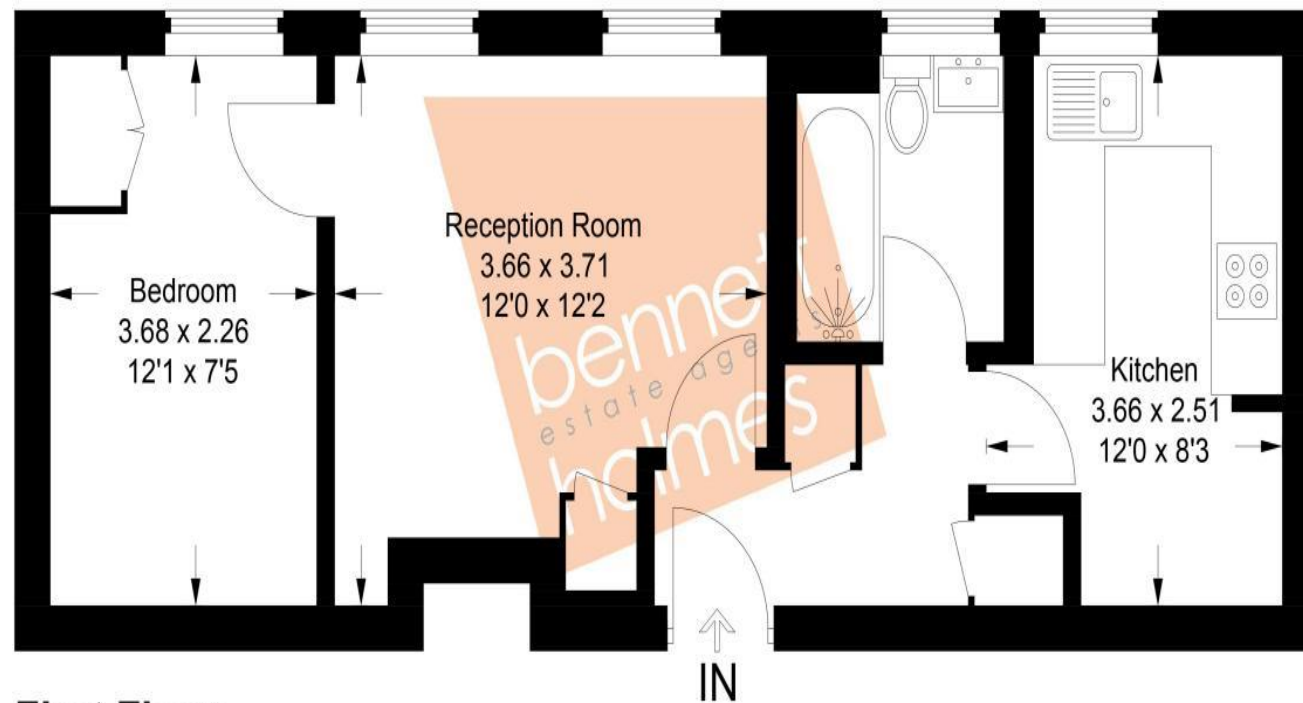

First Floor

This plan is for layout guidance only. Not drawn to scale unless stated. Windows and door openings are approximate. Whilst every care is taken in the preparation of this plan, please check all dimensions, shapes and compass bearings before making any decisions reliant upon them.

Unfurnished
Available Now
Three Rivers District Council
Council Tax Band B
Council Tax £1,711 per annum
EPC =D

NORTHOLT OFFICE

83 Oldfields Circus Northolt, Middlesex UB5 4RU

sales: 020 8423 2222 lettings: 020 8423 0222

northolt@bennetholmes.com

IMPORTANT Bennett Holmes would inform prospective purchasers that these sales particulars have been prepared as a general guide only. A detailed survey has not been carried out, nor the services, appliances and fittings tested. Room sizes should not be relied upon for furnishing purposes and are approximate. If floor plans are included, they are for guidance only and illustration purposes only and may not be to scale. If there are any important matters likely to affect your decision to buy, please contact us before viewing the property.

Filton House Wafford WD19 7SQ

Price Guide: Monthly Rental Of £1,050



A newly redecorated one bedroom 2nd floor flat located within walking distance of Carpenders Park Overground station, allowing access to Central London. Local Schools such as Oxhey Wood Primary and Colnbrook Primary, are both within a few minutes walking distance. The flat has been recently redecorated and benefits from a large kitchen and lounge, newly fitted gas central heating and double glazing. The property is offered unfurnished and available now.



- ONE DOUBLE BEDROOM
- SECOND FLOOR FLAT
- DOUBLE GLAZING
- NEWLY FITTED GAS CENTRAL HEATING
- FITTED KITCHEN
- RECENTLY REDECORATED
- UNFURNISHED
- AVAILABLE NOW

**Filton House
Watford
WD19 7SQ**

Price Guide: Monthly Rental Of £1,050



Accommodation

The communal hallway entered via entryphone, has stairs that lead up to the 2nd floor. The flats own front door leads to the entrance hallway with doors to a fitted kitchen featuring gas hob and built-in oven, washing machine, fridge freezer and range of base and eye level units. There is a family bathroom with bath and electric shower, wash hand basin and low level w.c.. The bedroom is located off of the lounge.

