

Wood End Lane Northolt UB5 4JP

Price Guide: Monthly Rental Of £1,350

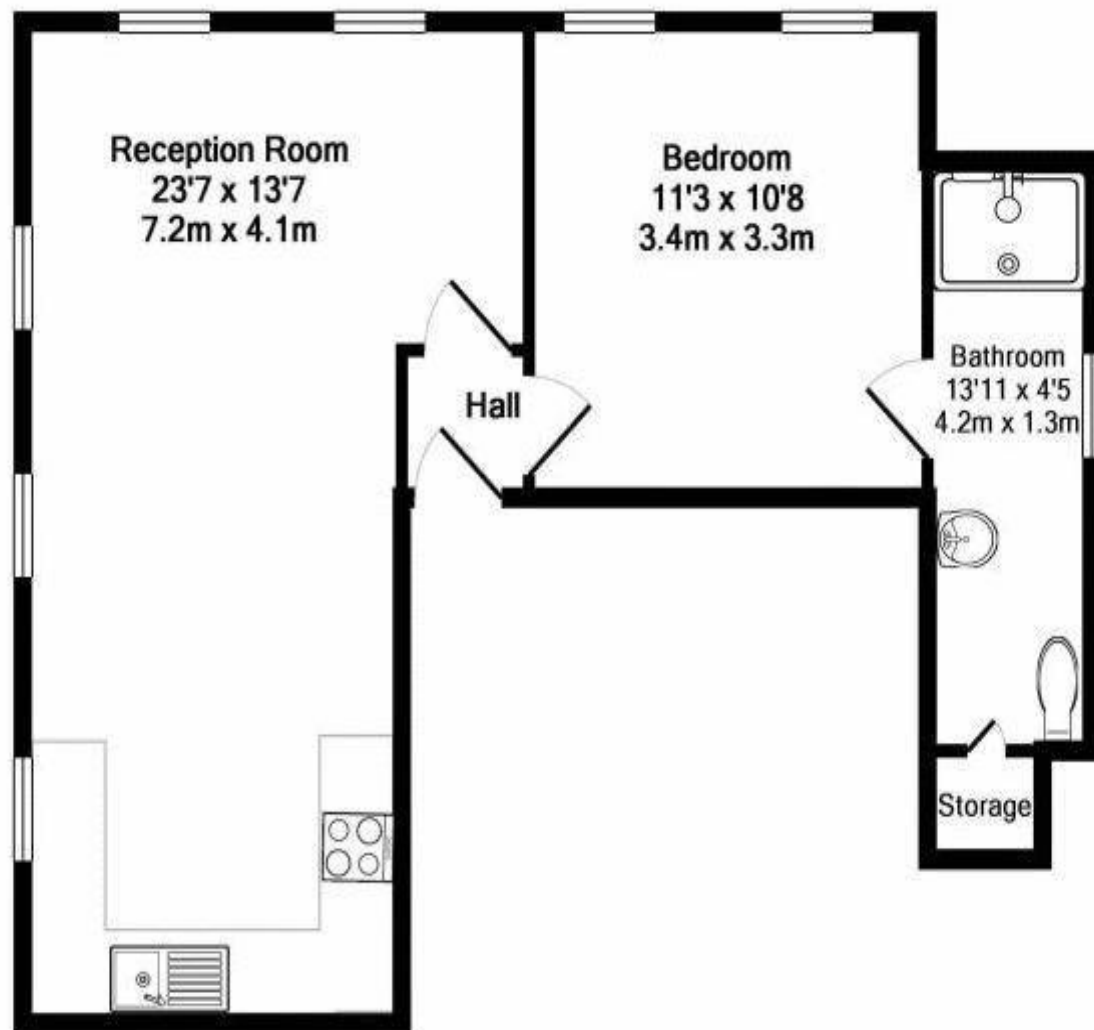

TOTAL APPROX. FLOOR AREA 468 SQ.FT. (43.4 SQ.M.)

Unfurnished
Available 6th November
London Borough Of Ealing
Council Tax Band B
Council Tax £1,515 per annum
EPC =C

NORTHOLT OFFICE

83 Oldfields Circus Northolt, Middlesex UB5 4RU

sales: 020 8423 2222 lettings: 020 8423 0222

northolt@bennetholmes.com

IMPORTANT Bennett Holmes would inform prospective purchasers that these sales particulars have been prepared as a general guide only. A detailed survey has not been carried out, nor the services, appliances and fittings tested. Room sizes should not be relied upon for furnishing purposes and are approximate. If floor plans are included, they are for guidance only and illustration purposes only and may not be to scale. If there are any important matters likely to affect your decision to buy, please contact us before viewing the property.



A one bedroom second floor flat located within close distance to local shops, and schools. Transport is also nearby with Northolt Park's Chiltern Railway Line station being 0.6 miles away, Sudbury Hill's Piccadilly Line Station is 0.8 miles and Northolt's Central Line station is within a mile walk. Offered to the market in good condition throughout, unfurnished and available from the 6th November.



- SECOND FLOOR FLAT
- OPEN PLAN KITCHEN-LIVING ROOM
- DOUBLE GLAZING
- GAS CENTRAL HEATING
- SHOWER ROOM
- MODERN THROUGHOUT
- UNFURNISHED
- AVAILABLE 6TH NOVEMBER

Wood End Lane Northolt UB5 4JP

Price Guide: Monthly Rental Of £1,350



Accommodation

The accommodation comprises: Side accessed secure gate leading to communal entrance entrance with stairs to the 2nd floor, which leads to the flats front door. Entrance hallway with access to : Open plan kitchen with living room, comprising of a modern fitted kitchen with high gloss units, washing machine, under counter fridge-freezer. Separate bedroom with access to the shower room with wash hand basin, w.c. and a fitted cupboard housing combination boiler. All rooms have Velux opening windows.

