

Collapit Close Harrow HA1 4YE

Price Guide: Monthly Rental Of £1,300

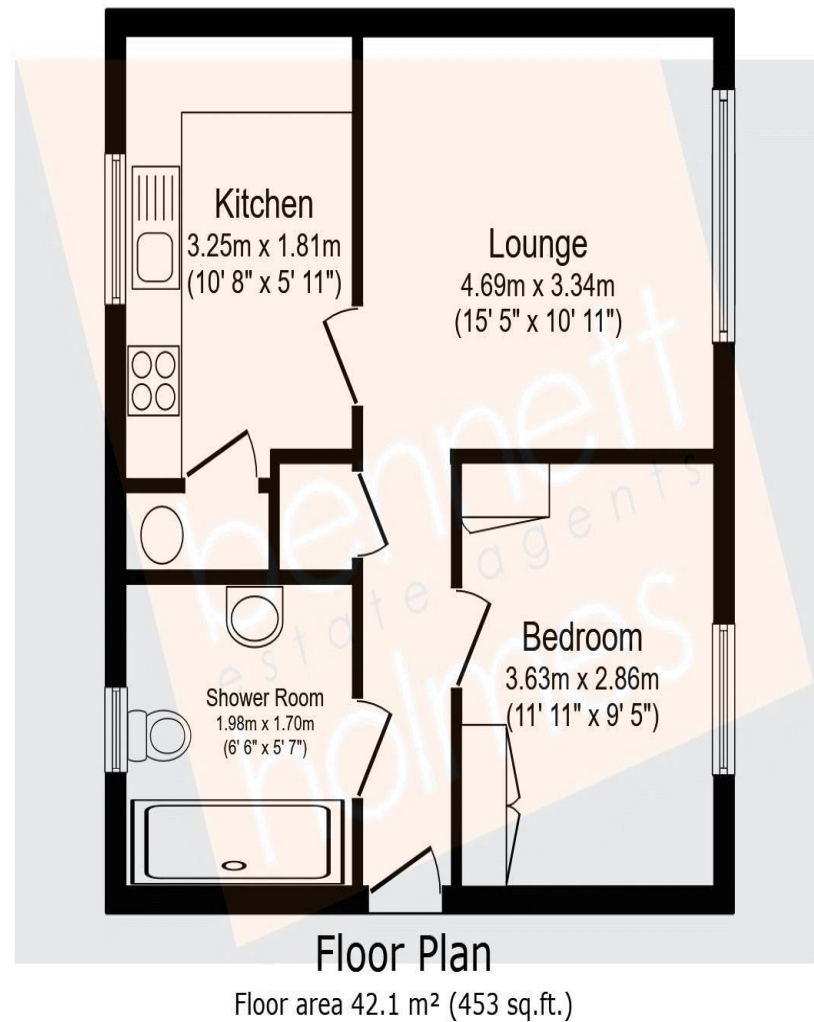

TOTAL: 42.1 m² (453 sq.ft.)

This floor plan is for illustrative purposes only. It is not drawn to scale. Any measurements, floor areas (including any total floor area), openings and orientations are approximate. No details are guaranteed, they cannot be relied upon for any purpose and do not form any part of any agreement. No liability is taken for any error, omission or misstatement. A party must rely upon its own inspection(s). Powered by www.Propertybox.io

Unfurnished
Available now
Borough of Harrow
Council Tax Band C
Council Tax £2,032 per annum
EPC =E

NORTHOLT OFFICE

83 Oldfields Circus Northolt, Middlesex UB5 4RU

sales: 020 8423 2222 lettings: 020 8423 0222

northolt@bennetholmes.com

IMPORTANT Bennett Holmes would inform prospective purchasers that these sales particulars have been prepared as a general guide only. A detailed survey has not been carried out, nor the services, appliances and fittings tested. Room sizes should not be relied upon for furnishing purposes and are approximate. If floor plans are included, they are for guidance only and illustration purposes only and may not be to scale. If there are any important matters likely to affect your decision to buy, please contact us before viewing the property.



Bennett Holmes are pleased to present this one double bedroom ground floor apartment. The property is nestled in a quiet cul-de-sac in North Harrow and is within close walking distance to North Harrow's high street with local shops and the Metropolitan Line Station for easy commute into central London. Also nearby is Harrow-on-the-Hill's shopping centre's and transport links. Other benefits include fitted wardrobes in the bedroom, double glazed windows and electric heating. The property is offered unfurnished and available now.



- ONE DOUBLE BEDROOM
- GROUND FLOOR
- PURPOSE BUILT FLAT
- CUL - DE - SAC LOCATION
- CONVENIENT LOCATION
- COMMUNAL PARKING + GARDENS
- UNFURNISHED
- AVAILABLE NOW

Collapit Close Harrow HA1 4YE

Price Guide: Monthly Rental Of £1,300



Accommodation

The accommodation comprises a secure, entryphone operated communal entrance with stairs to the first floor and door into an inner hallway with front door into the flat. The entrance hallway has doors leading to the modern shower room, double bedroom and living room with door to the kitchen. The kitchen consists of eye and base level units, electric oven and hob with overhead extractor fan, plumbed for washer/dryer and an enclosed cupboard space for the fridge freezer. The shower room includes a walk in shower cubicle with electric power shower, vanity sink, low flush w.c. heated towel radiator and partly tiled walls and full tiled floor. The bedroom benefits from two separate fitted wardrobes.

