

Lime Close Harrow HA3 7JG

Price Guide: Offers in Excess of £220,000

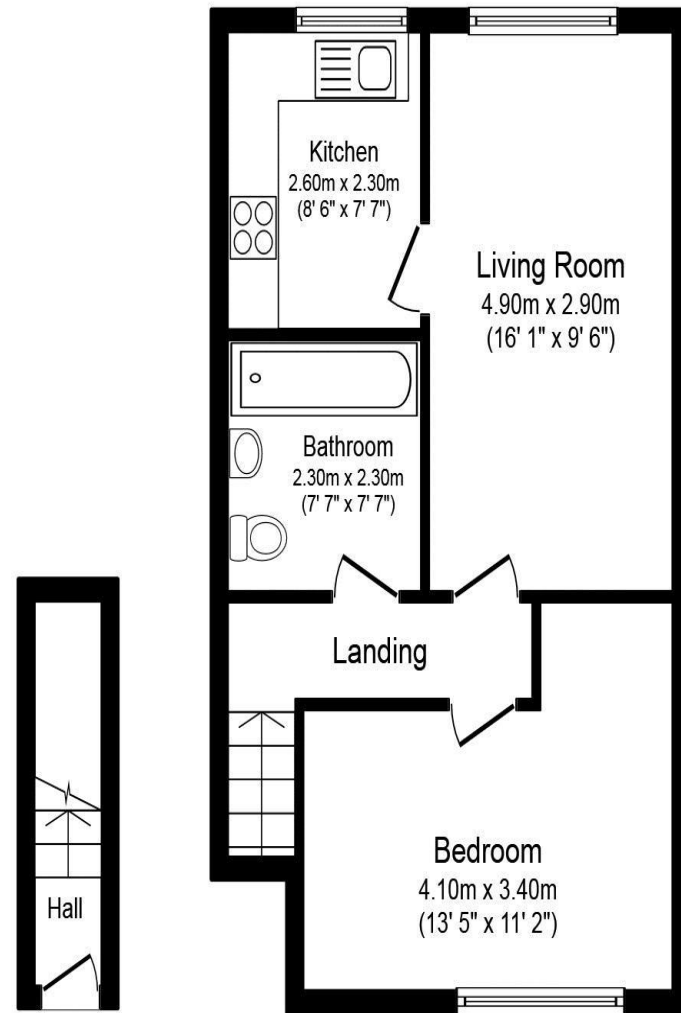

Ground Floor

First Floor

Total floor area 44.0 sq. m. (474 sq. ft.) approx
This plan is for illustration purposes only and may not be representative of the property. Plan not to scale.

NORTHOLT OFFICE

83 Oldfields Circus Northolt, Middlesex UB5 4RU

sales: 020 8423 2222 lettings: 020 8423 0222

northolt@bennetholmes.com

Leasehold - there are 92 years remaining on the lease.
125 years from 24th June 1991. Service charge - £ 220 PA
Ground rent - £150 PA
London Borough of Harrow
Council Tax Band C
Council tax band: £2,032.28
EPC =C

IMPORTANT Bennett Holmes would inform prospective purchasers that these sales particulars have been prepared as a general guide only. A detailed survey has not been carried out, nor the services, appliances and fittings tested. Room sizes should not be relied upon for furnishing purposes and are approximate. If floor plans are included, they are for guidance only and illustration purposes only and may not be to scale. If there are any important matters likely to affect your decision to buy, please contact us before viewing the property.



Bennett Holmes are pleased to offer this spacious one bedroom purpose built first floor maisonette. Situated in a cul de sac location off Kenton Lane, Belmont Circle is within easy reach as well as Harrow & Wealdstone Station. Outside there is residents parking and well maintained communal gardens. Other benefits include new carpets, gas central heating, double glazed windows and no upper chain.



- ONE DOUBLE BEDROOM
- FIRST FLOOR
- MAISONETTE
- CUL DE SAC LOCATION
- NEW CARPETS
- RESIDENTS PARKING
- COMMUNAL GARDENS
- NO UPPER CHAIN

**Lime Close
Harrow
HA3 7JG**

Price Guide: Offers in Excess of £220,000



Accommodation

The property is situated within a modern and sought after development. Accommodation comprises: Stairs to first floor landing, large reception room, modern fitted kitchen with fridge freezer, washing machine, oven and hob. Double bedroom with fitted storage cupboard. Modern fitted bathroom. Further benefits include double glazing and gas central heating. Outside there is residents parking and well maintained communal gardens.

Leasehold - there are 92 years remaining on the lease. 125 years from 24th June 1991.
Service charge - £ 220 PA Ground rent - £150 PA
London Borough of Harrow
Council Tax Band C
Council tax band: £2,032.28
EPC =C

