

## Helmsdale Close Hayes UB4 9QS

Price Guide: Monthly Rental Of £1,300

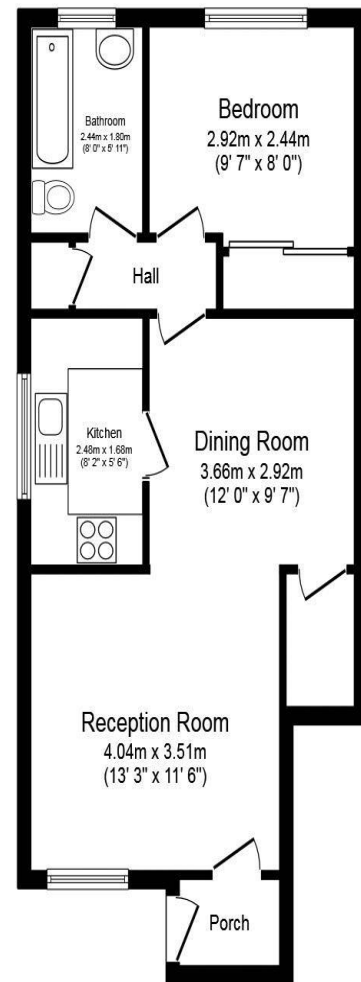

**Floor Plan**

Total floor area 51.3 sq.m. (553 sq.ft.) approx

This plan is for illustration purposes only and may not be representative of the property. Plan not to scale.

NORTHOLT OFFICE

83 Oldfields Circus Northolt, Middlesex UB5 4RU

sales: 020 8423 2222 lettings: 020 8423 0222

[northolt@bennetholmes.com](mailto:northolt@bennetholmes.com)

**IMPORTANT** Bennett Holmes would inform prospective purchasers that these sales particulars have been prepared as a general guide only. A detailed survey has not been carried out, nor the services, appliances and fittings tested. Room sizes should not be relied upon for furnishing purposes and are approximate. If floor plans are included, they are for guidance only and illustration purposes only and may not be to scale. If there are any important matters likely to affect your decision to buy, please contact us before viewing the property.

Unfurnished  
Available now  
London Borough of Hillingdon  
Council Tax band C  
Council Tax £1,657 per annum  
EPC =C



Bennett Holmes are pleased to offer this well presented, one bedroom, ground floor maisonette situated in a quiet residential close in Yeading. The property is convenient for commuters requiring the A40 into and out of London, M25 and M4. Local bus links and schools are also close by. Other benefits include own front door, a large reception room/ diner, a fitted wardrobe, own private paved garden, an allocated parking space and gas central heating. The property is offered unfurnished and is available now.





- ONE BEDROOM
- GROUND FLOOR MAISONNETTE
- OWN REAR PAVED GARDEN
- AN ALLOCATED PARKING SPACE
- DOUBLE GLAZING
- GAS CENTRAL HEATING
- UNFURNISHED
- AVAILABLE NOW

## Helmsdale Close Hayes UB4 9QS

**Price Guide:** Monthly Rental Of £1,300



### Accommodation

The accommodation briefly comprises own front door opening to the inner front door opening to the large reception room/ diner. With doors to the kitchen, the family bathroom and the bedroom. The kitchen comprises wall and base level units, an electric cooker point, a washing machine and fridge/ freezer. The bedroom has a large fitted wardrobe. Outside the property is a private rear paved garden. To the front is an allocated parking space.

