



86 Hilden Park Road, Hildenborough, Kent TN11 9BN  
Offers In Excess Of: £575,000 Freehold

**JAMES MILLARD**  
INDEPENDENT ESTATE AGENTS





- \*Individual Extended Detached Family Home \*Popular Residential Location
- \*Open Plan Extended Sitting/Dining Room \*Kitchen \*Ground Floor Study
- \*Three Bedrooms \*Spacious Family Bathroom & Separate W.C
- \*Detached Garage with Workshop & Driveway
- \*Attractive Landscaped South Westerly Rear Garden

#### Description

An individual detached home situated in this popular residential area, within walking distance of local amenities and village schools. Dating back to 1910 with later ground floor extension, this versatile family home offers light and spacious accommodation with the benefit of a 28ft reception room, ideal for entertaining. The property also benefits from an attractive south westerly facing rear garden, detached garage with workshop extension and off road parking.

#### POINTS OF NOTE:-

- The property is approached over a paved pathway with privet hedging leading to the front door with storm porch canopy, leading to the entrance hallway having stairs rising to the first floor and understairs storage cupboard.
- Ground floor study or occasional guest bedroom with aspect to front.
- Dual aspect extended sitting/dining room, a bright and spacious room ideal for entertaining having a dividing brick faced archway. Picture window to rear enjoying a lovely aspect over the garden and sliding patio doors opening out onto the terrace.
- Kitchen fitted with a range of cream wall mounted cabinets and base units of cupboards and drawers, one and a half bowl stainless steel sink inset to laminate worktops with tiled splashback. Space and plumbing for washing machine and dishwasher, space for tumble dryer and tall fridge/freezer. Space for freestanding gas cooker with extractor hood over. Quarry tiled flooring, high panelled ceiling, two windows overlooking the garden and door to garden.
- First floor landing with access to mainly boarded and insulated loft space. Main bedroom with picture window to front, second bedroom also with aspect to front and fitted wardrobe, third bedroom with aspect to rear overlooking the garden.
- Spacious family bathroom fitted with a white suite comprising panelled bath with shower over, pedestal basin and low level w.c. Fitted airing cupboard with louvre doors, housing Worcester Bosch combination boiler with slatted shelving and further overhead storage. Ladder heated towel rail and laminate wood effect flooring. Separate additional w.c.
- Front garden and driveway offering off road parking for several vehicles, leading to the detached brick garage with workshop extension having up and over door to front, power and light, window and personal door to the rear garden.





- Attractively landscaped south westerly facing rear garden with a paved terrace with lawn and feature raised fishpond. Fenced boundaries and planted with a variety of mature trees including magnolia, fir and holly offering a degree of seclusion. Timber garden shed to side, external tap and low brick wall with wooden gate leading to the driveway.
- All main services. Double glazed windows replaced in 2013. Gas central heating system.
- Council Tax Band: E – Tonbridge & Malling
- EPC: D

#### Hildenborough

This popular village offers local shops and post office and amenities including medical centre, village halls offering social activities and classes, church, public house, library and Ridings Café. The weekly farmers' market is a popular meeting place for the local community, whilst the mainline station offers services to London Charing Cross (via Waterloo East) and Cannon Street with commuter bus service to the station. Well regarded primary schools include Stocks Green which is within easy proximity of the property and Hildenborough CofE. Grammar schools located in Tonbridge, Sevenoaks and Tunbridge Wells including Judd and The Skinners School. Private schools including Sackville in the village, Hilden Grange and Tonbridge School. State secondary schools in Tonbridge including Hayesbrook and Weald of Kent. The A21 by-pass links to the M25 motorway network to London, the south coast, major airports, the Channel Tunnel and Bluewater shopping centre while nearby towns of Sevenoaks and Tonbridge offer comprehensive shopping and recreational facilities. Leisure facilities include Nizels Golf and Country Club, Hilden Golf Driving range with gym, cricket at The Vine in Sevenoaks and Sevenoaks Rugby Club.



Viewing Strictly By Appointment

01732 834835

[www.jamesmillard.co.uk](http://www.jamesmillard.co.uk)  
[hildenborough@jamesmillard.co.uk](mailto:hildenborough@jamesmillard.co.uk)

## 86 Hilden Park Road

House - Gross Internal Area : 102.4 sq.m (1102 sq.ft.)  
 Garage - Gross Internal Area : 17.9 sq.m (192 sq.ft.)

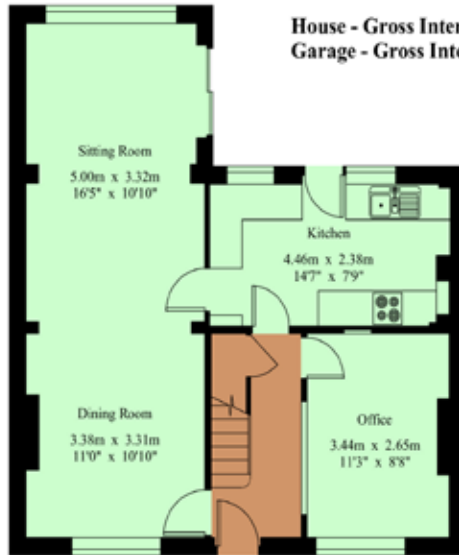

Ground Floor

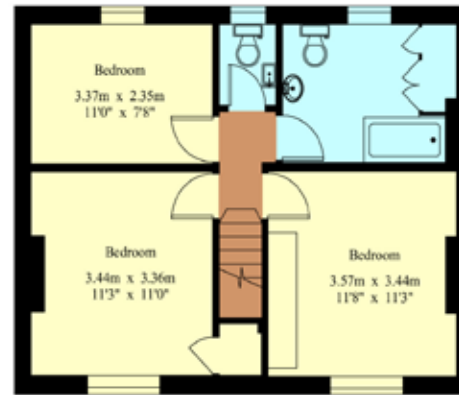

First Floor

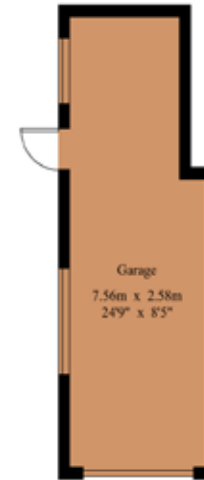

For Identification Purposes Only.  
 © 2023 Trauplan (UK) Limited (01892) 614 881

James Millard Independent Estate Agents, their clients and any joint agents give notice that: 1.They have no authority to make or give any representations or warranties in relation to the property. These particulars are given in good faith and are to be treated as a general guide only and do not constitute any part of an offer or a contract and must not be relied upon as statements or representations of fact. All statements contained in these particulars are made without any responsibility on the part of James Millard Independent Estate Agents or the vendor or lessor of this property. Any intending purchasers must satisfy themselves by inspection or otherwise as to the correctness of each of the statements contained in these particulars. If any points are particularly relevant to your interest in the property please ask for further information. 2. Any areas, measurements or distances are approximate. The text, photographs and plans are for guidance only and are not necessarily comprehensive. It should not be assumed that the property has all necessary planning, building regulation or other consents. 3. It should not be assumed that any contents, furnishings, furniture etc photographed are included in the sale, nor that the property remains as displayed in the photographs. No assumptions should be made with regard to parts of the property that have not been photographed. 4. Prospective purchasers are advised to satisfy themselves as to the working order of any apparatus, equipment, fixtures and fittings or services where applicable. Whilst they may be mentioned in the particulars, they have not been tested by the Agents. J205

