



The Shires, Caxton Place, Hadlow, Tonbridge, Kent TN11 0JU
Guide: £1,250,000 Freehold

JAMES MILLARD
INDEPENDENT ESTATE AGENTS



- *Stunning Grade II Listed Barn Conversion
- *Situated in Private Rural Hamlet
- *Four Bedrooms
- *Dining Hallway with Flagstone Floor
- *Sitting Room with Stove
- *Family/Music Room & Spiral Wine Cellar
- *Bespoke Kitchen/Breakfast Room
- *Main Bedroom with En-Suite
- *Three Further Bedrooms
- *Family Bathroom
- *Ground Floor Shower Room & Utility Room
- *Equestrian Facilities including Paddocks, Stable Block and Field Shelters
- *Part Walled Formal Gardens
- *Private Gated Driveway
- *Total Plot 2.75 Acres

Description

An opportunity to acquire this stunning Grade II listed barn conversion dating back to the 17th century, which forms part of Caxton Place, a small private hamlet, formerly a brewery which enjoys a rural setting amongst glorious countryside. The Shires is presented in excellent order throughout with an abundance of character and charm enjoying just shy of three acres of land, formed of formal part walled gardens, two paddocks each with field shelters, and a stable block.

Accommodation

- Flagstone entrance hallway opening to formal dining hall having large picture window with privacy film, beams and exposed brick wall, electric radiator and open tread sweet chestnut staircase.
- Triple aspect sitting room, a bright space with exposed brick wall and inglenook with Nestor Martin Harmony multi-fuel stove, ceiling beams, door to rear with fixed secondary glazing and engineered oak flooring.
- Bespoke Mereway Lincoln kitchen fitted with a range of contrasting wall cabinets and base units of cupboards and drawers, including tall triple pantry, finished with granite worktops and upstands. Neff appliances including induction hob & extractor over, double oven and microwave, dishwasher and Liebherr fridge. Cupboard housing Worcester LPG boiler, fitted bench seat with storage, door to terrace with fixed secondary glazing and ceramic tiled floor with underfloor heating.
- Family/music room enjoying a vaulted ceiling with exposed beams and solid oak floor with trap door to impressive spiral wine cellar. Double glazed French doors lead out onto the rear terrace.
- Ground floor shower room fitted with an Aqualisa power shower, close coupled w.c, basin and attractive tiled floor. Utility room containing washing machine, tumble dryer, washing machine and fridge/freezer.
- First floor landing having vaulted ceiling, exposed beams and solid timber floor, airing cupboard housing hot water tank and programmer.
- Dual aspect main bedroom suite with vaulted ceiling, exposed beams and smart contemporary en-suite shower room, walk in shower enclosure with Aqualisa power shower, countertop basin set on granite top and electric underfloor heating.
- Three further bedrooms, second with access to loft via hatch with drop down ladder and light, third with vaulted ceiling and fourth also with vaulted ceiling and large eaves storage area.
- Family bathroom fitted with a Utopia suite comprising free standing bath, vanity unit with basin and concealed cistern w.c, metro tiled splashback and wood effect tiled flooring.

- The gardens and grounds extend to 2.75 acres and comprise formal part walled gardens predominately laid to lawn with stone terrace and an abundance of mature shrub/flower borders, fruit trees, security shed, bike shed and greenhouse, hedged boundary and five bar gate leading to private parking area. Two paddocks both having mobile field shelters and water troughs.
- Stable block with concrete yard, power, light and water connected, one stable dry lined for use as a workshop/ hobbies room. Raised vegetable beds with established fruit bushes.
- Services & Points of Note: Mains electricity and water. Conventional LPG heating system and electric heating. LPG metered from shared estate tank by Flogas. Drainage by estate communal biodigester. Construction solid brick and timber framed. Mainly single glazed windows with secondary glazed removable panels. Broadband fibre to house. Security alarm system. The property owns a share in Caxton Place Heritage Ltd with a service charge of £1,083 p/a in 2023 which covers maintenance of drainage system, driveway, hedge trimming, mowing front lawns and communal land.
- Council Tax Band: G – Tonbridge & Malling Borough Council. EPC: Exempt – Grade II Listed

Situation

Caxton Place is a private hamlet of mostly Grade II listed buildings, situated on the rural outskirts of the village of Hadlow on the A26 between Tonbridge and Maidstone and provides local shops, pubs and restaurants, primary school, library, medical centre and pharmacy. The town of Tonbridge is approximately five miles distant offering comprehensive shopping, educational and recreational facilities and mainline station to London with fast services to London Bridge and Charing Cross. The M20 and M25 Motorways are accessed via the A26 and A21. The area is well served with primary and secondary schools in the state and private sectors. The village is situated within a conservation area, surrounded by countryside and with many buildings of interest including the historic St Mary's church and the Hadlow Tower.



Viewing Strictly By Appointment

01732 834835

www.jamesmillard.co.uk
hildenborough@jamesmillard.co.uk

The Shires

House - Gross Internal Area : 190.4 sq.m (2049 sq.ft.)

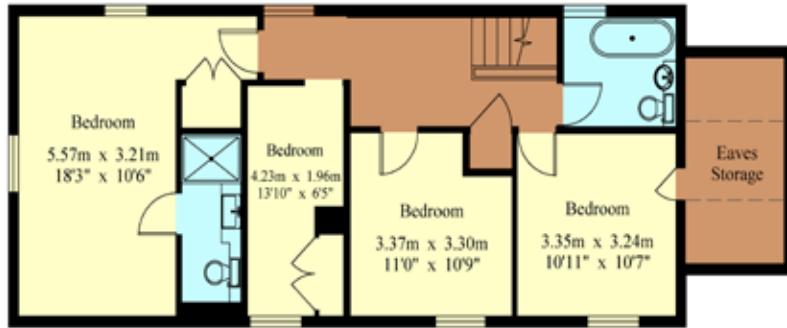

First Floor

---- Restricted Height

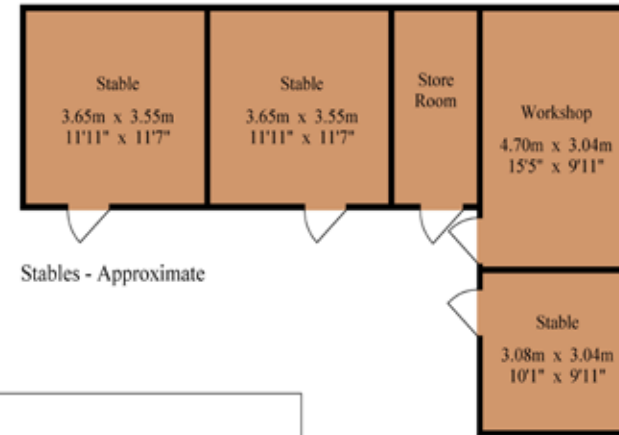

Stables - Approximate



Ground Floor



For Identification Purposes Only.

© 2024 Trueplan (UK) Limited (01892)614881

James Millard Independent Estate Agents, their clients and any joint agents give notice that: 1.They have no authority to make or give any representations or warranties in relation to the property. These particulars are given in good faith and are to be treated as a general guide only and do not constitute any part of an offer or a contract and must not be relied upon as statements or representations of fact. All statements contained in these particulars are made without any responsibility on the part of James Millard Independent Estate Agents or the vendor or lessor of this property. Any intending purchasers must satisfy themselves by inspection or otherwise as to the correctness of each of the statements contained in these particulars. If any points are particularly relevant to your interest in the property please ask for further information. 2. Any areas, measurements or distances are approximate. The text, photographs and plans are for guidance only and are not necessarily comprehensive. It should not be assumed that the property has all necessary planning, building regulation or other consents. 3. It should not be assumed that any contents, furnishings, furniture etc photographed are included in the sale, nor that the property remains as displayed in the photographs. No assumptions should be made with regard to parts of the property that have not been photographed. 4. Prospective purchasers are advised to satisfy themselves as to the working order of any apparatus, equipment, fixtures and fittings or services where applicable. Whilst they may be mentioned in the particulars, they have not been tested by the Agents. J205

