



Belgrave Road  
Pimlico, SW1V

CHESTERTONS







The property benefits from having a lift, two double bedrooms both with built-in wardrobes and the master bedroom having a tiled en-suite bathroom, well-presented reception with sash windows, kitchen and a second bathroom.

- Stucco-fronted period property
- 2 Bedroom, 2 Bathroom, 1 Reception
- The building has a lift
- Close to Pimlico Underground Station

### £2,700 pcm

Additional tenant charges apply (fees apply to non-AST tenancies only)

Tenancy Agreement Fee: £300

References per Tenant/Guarantor: £60

Inventory check (approx. £100 – £250 inc. VAT)

[chestertons.co.uk/property-to-rent/applicable-fees](http://chestertons.co.uk/property-to-rent/applicable-fees)

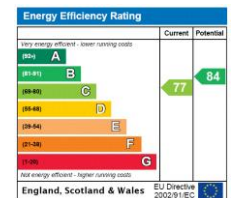

**Minimum Term:** months  
**Deposit Required:** £0.00  
**Local Authority:**  
**Council Tax Band:**  
**EPC Rating:** C  
**Furnished**

### Chestertons Westminster & Pimlico Lettings

105 Wilton Road  
 London  
 SW1V 1DZ

[westminster@chestertons.co.uk](mailto:westminster@chestertons.co.uk)

02030408220

[chestertons.co.uk](http://chestertons.co.uk)

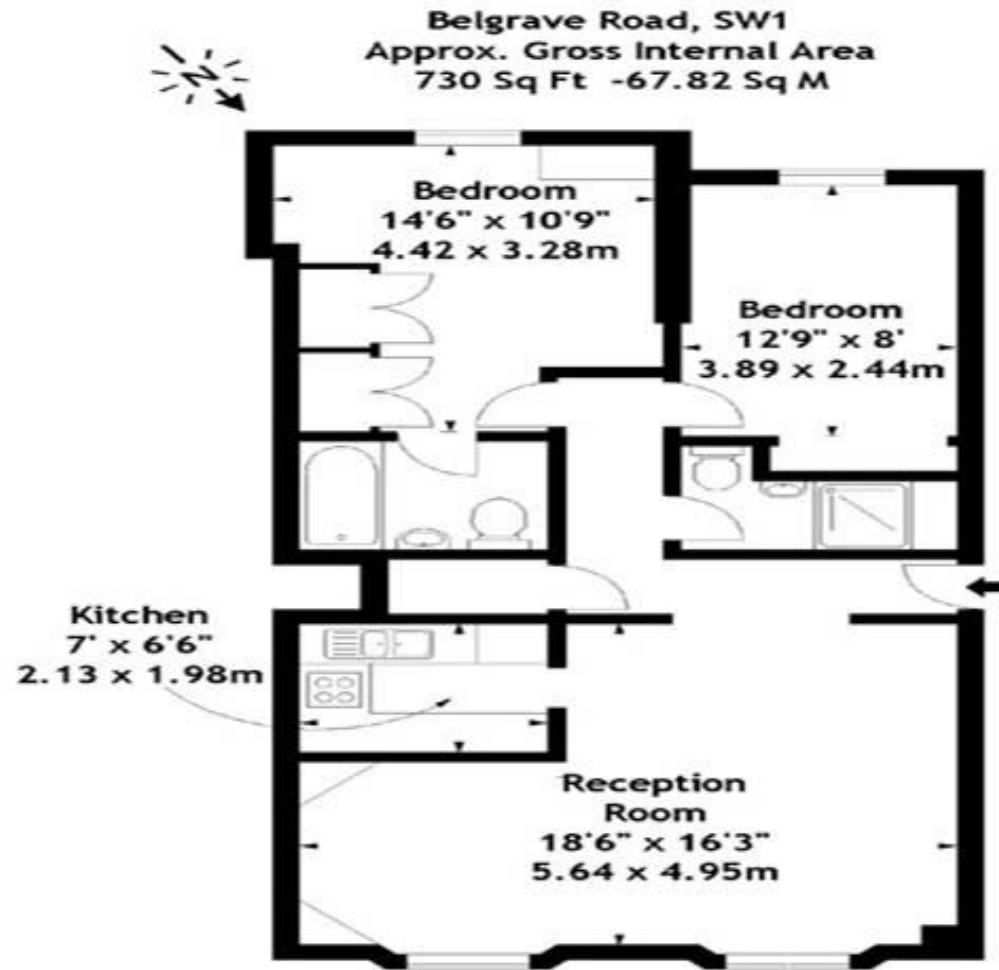

### Third Floor

Every attempt is made to ensure accuracy, however measurements  
are Approximate and for illustrative purposes only. Not to Scale  
© Datagraphy UK Ltd 2006  
Photographs \* Floorplans \* Virtual Tours  
Tel: 0207 386 3735 [www.datagraphy.com](http://www.datagraphy.com)

Chesterton Global Ltd trading as Chestertons for themselves and for the vendor of this property whose agents they are, give notice that (i) these particulars do not constitute any part of an offer or contract, (ii) all statements contained within these particulars are made without responsibility on the part of Chestertons or the vendor, (iii) whilst made in good faith, none of the statements contained within these particulars are to be relied upon as a statement or representation of fact, (iv) any intending purchasers must satisfy themselves by inspection or otherwise as to the correctness of each of the statements contained within these particulars, (v) the vendor does not make or give either Chestertons or any person in their employment any authority to make or give representation or warranty whatsoever in relation to this property. Wide angle lenses may be used. ©Copyright Chestertons | Chesterton Global Ltd | Registered Office 40 Connaught Street, Hyde Park, London W2 2AB Registered Company Number 05334580.