



# Jessel House

Page Street, SW1P

£2,700 per month  
(£623.08 per week)

Exclusive to Chestertons. A newly refurbished two double bedrooms apartment benefiting from wooden floors throughout, spacious reception room, separate modern kitchen and bathroom. Located conveniently between St James, Victoria and Pimlico Stations.

**CHESTERTONS**



# Jessel House

Page Street, SW1P

- Newly refurbished apartment in Westminster
- 2 bedrooms, 1 bathroom, 1 Reception
- Wood floors
- Great location



Exclusive to Chestertons. A newly refurbished two double bedrooms apartment benefiting from wooden floors throughout, spacious reception room, separate modern kitchen and bathroom. The property is located conveniently between St James, Victoria and Pimlico Underground Stations.

**Minimum Term:** 12 months  
**Deposit Required:** £3,115.38  
**Local Authority:** City Of Westminster  
**Council Tax Band:** C  
**EPC Rating:** C  
**Furnished, Part Furnished**

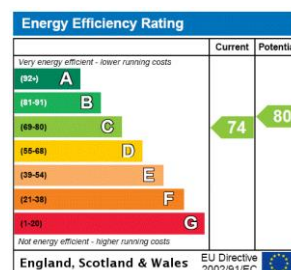

### *Chestertons Westminster & Pimlico Lettings*

105 Wilton Road  
 London  
 SW1V 1DZ  
[westminster@chestertons.co.uk](mailto:westminster@chestertons.co.uk)  
 02030408220  
[chestertons.co.uk](http://chestertons.co.uk)

Additional tenant charges apply (fees apply to non-AST tenancies only)  
 Tenancy Agreement Fee: £300  
 References per Tenant/Guarantor: £60  
 Inventory check (approx. £100 – £250 inc. VAT)  
[chestertons.co.uk/property-to-rent/applicable-fees](http://chestertons.co.uk/property-to-rent/applicable-fees)

# Jessel House

Approximate Gross Internal Area = 623 sq ft / 57.9 sq m

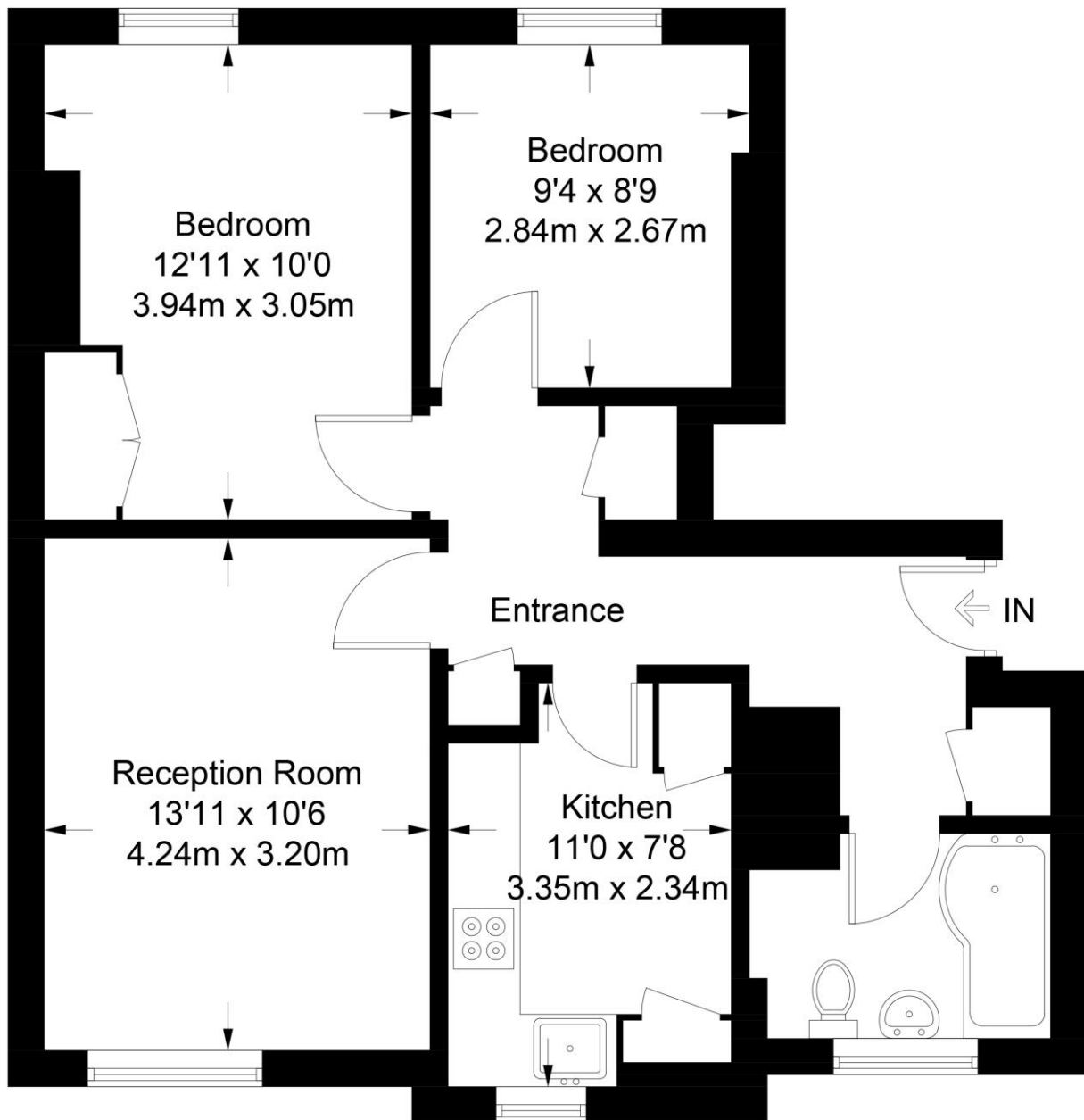

## Third Floor

Not to scale, for guidance only and must not be relied upon as a statement of fact.  
All measurements and areas are approximate only and have been prepared in accordance with the current edition of the RICS Code of Measuring Practice.

