



Drake House

76 Marsham Street, SW1P

£TBC per month
(£TBC per week)

The property comprises a spacious bedroom, stylish reception room leading onto a balcony, modern kitchen and bathroom. The property benefits from high ceilings, wooden parquet floors, underfloor heating and 24hour concierge. Exclusive to Chestertons.



Drake House

76 Marsham Street, SW1P

- A luxurious brand new apartment furnished to the very highest standard in the heart of Westminster
- 1 Bedroom, 1 Bathroom, 1 Reception
- 24-hour concierge, high ceilings, engineered wooden parquet
- Exclusive to Chestertons



Virtual Viewing Available: A stylish one bedroom apartment benefiting from high ceilings, engineered wooden parquet floors, underfloor heating and 24-hour concierge.

The property comprises a spacious bedroom with fitted wardrobes, spacious reception leading onto a balcony, fully integrated kitchen and a modern bathroom.

The property is located just minutes from three tube stations (Circle, District, Victoria and Jubilee lines) and the River Thames and St James' Park. Exclusive to Chestertons.

Minimum Term: 12 months
Deposit Required: £3,576.92
Local Authority: Westminster
Council Tax Band: E
EPC Rating: B
Furnished

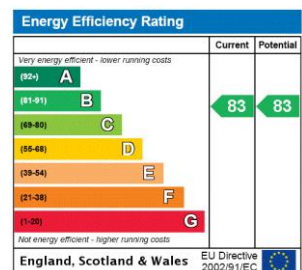

Chestertons Westminster & Pimlico Lettings

105 Wilton Road
 London
 SW1V 1DZ
 westminster@chestertons.co.uk
 02030408220
 chestertons.co.uk

Additional tenant charges apply (fees apply to non-AST tenancies only)
 Tenancy Agreement Fee: £300
 References per Tenant/Guarantor: £60
 Inventory check (approx. £100 – £250 inc. VAT)
 chestertons.co.uk/property-to-rent/applicable-fees

Drake House, Marsham Street, London, SW1P

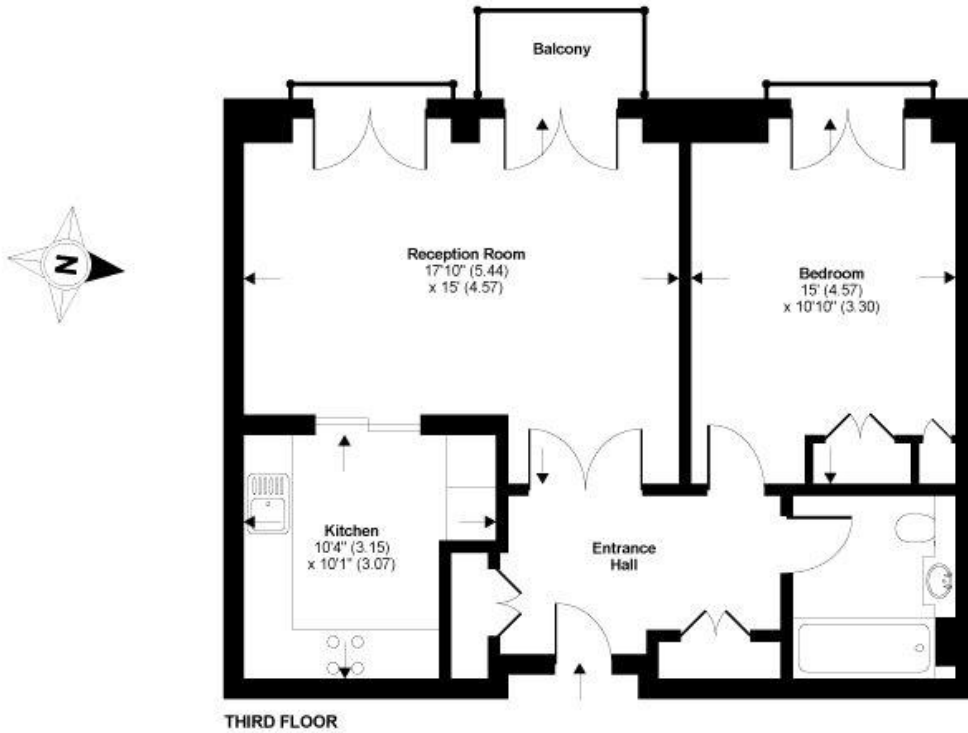

THIRD FLOOR

TOTAL GROSS INTERNAL FLOOR AREA 663 SQ FT 61.5 SQ METRES

Whilst every attempt has been made to ensure the accuracy of the floor plan contained here, measurements of doors, windows and rooms are approximate and no responsibility is taken for any error, omission or misstatement. These plans are for representation purposes only as defined by RICS Code of Measuring Practice and should be used as such by any prospective purchaser. Specifically, no guarantee is given on the total square footage of the property if quoted on this plan. Any figure given is for initial guidance only and should not be relied on as a basis of valuation.

Copyright nichecom.co.uk 2015 Produced for Chesterton Humberts REF : 73743

