



# Carey Mansions

Rutherford Street, SW1P

£2,250 per month  
(£519.23 per week)

A first floor one double bedroom flat in a popular purpose built block in the heart of Westminster. The property further comprises reception room, separate kitchen and bathroom and can be furnished on request. Available now. Exclusive to Chestertons

**CHESTERTONS**



# Carey Mansions

## Rutherford Street, SW1P

- First Floor Flat
- One Double Bedroom
- Reception Room
- Separate Kitchen and Bathroom
- Popular Purpose Built Block
- No Onward Chain
- Lease expires in 2079



Rutherford Street is conveniently located for amenities and transport links of Westminster, Victoria and St James's including a great choice of cafes, shops and restaurants on Victoria Street and the surrounding area as well as transport links at Westminster (Jubilee, Circle and District underground lines) and Victoria (Victoria, Circle and District underground lines and Mainline Station).

**Minimum Term:** 12 months  
**Deposit Required:** £0.00  
**Local Authority:** City Of Westminster  
**Council Tax Band:** D  
**EPC Rating:** C  
**Furnished**

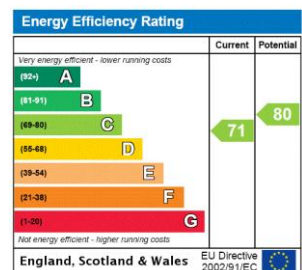

### Chestertons Westminster & Pimlico Lettings

105 Wilton Road  
 London  
 SW1V 1DZ  
 westminster@chestertons.co.uk  
 02030408220  
 chestertons.co.uk

Additional tenant charges apply (fees apply to non-AST tenancies only)  
 Tenancy Agreement Fee: £300  
 References per Tenant/Guarantor: £60  
 Inventory check (approx. £100 – £250 inc. VAT)  
 chestertons.co.uk/property-to-rent/applicable-fees

# Carey Mansions, SW1P

Approximate gross internal area

39.76 sq m / 428 sq ft

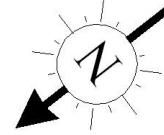

Key :  
CH - Ceiling Height

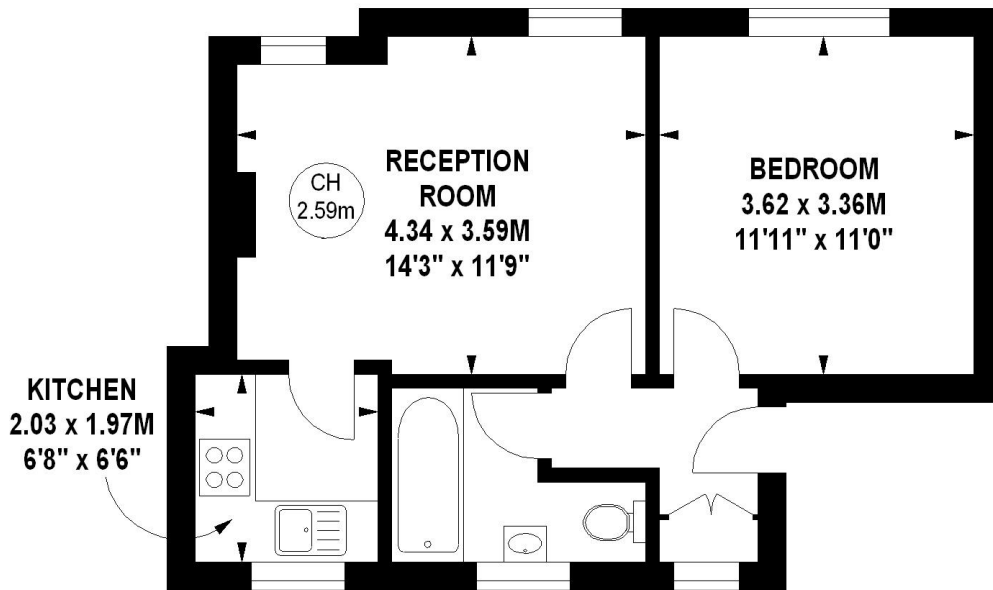

## First Floor

The floor plan is not to scale and measurements and areas shown are approximate and therefore should be used for illustrative purposes only.

The plan has been prepared in accordance with the RICS code of Measuring Practice and whilst we have confidence in the information produced, it must not be relied on.

If there is any aspect of particular importance, you should carry out or commission your own inspection of the property.

Copyright of FeaturePRO.

