



Clarendon Gardens

London, W9

£6,000 per month
(£1,384.62 per week)

(SHORT LET) A charming three bedroom garden maisonette located within this white stucco fronted building on one of W9's most prestigious roads.

CHESTERTONS



Clarendon Gardens

London, W9

- Short Let
- 3 Bedrooms
- 2 Bathrooms
- Newly Refurbished
- Private Garden



A charming three bedroom garden maisonette located within this white stucco fronted building on one of W9's most prestigious roads.

This newly refurbished property offers a perfect blend of modern comfort and period features - a spacious garden with a patio and decking area, ideal for alfresco dining. The bedrooms are generously sized, two modern bathrooms, open plan living and dining space with a separate kitchen.

Located moments to the canal and Warwick Avenue Underground Station, the cafes and shops of Clifton Road are within walking distance.

Minimum Term: 1 months
Deposit Required: 4 weeks (subject to tenancy length)
Local Authority: City of Westminster
Council Tax Band: G
EPC Rating: To be confirmed
Furnished

Chestertons Little Venice Lettings

26 Clifton Road
Maida Vale
London
W9 1SX
littlevenicetlettingsusers@chestertons.co.uk
02072662369
chestertons.co.uk

Additional tenant charges apply (fees apply to non-AST tenancies only)
Tenancy Agreement Fee: £300
References per Tenant/Guarantor: £60
Inventory check (approx. £100 – £250 inc. VAT)
chestertons.co.uk/property-to-rent/applicable-fees

Clarendon Gardens, W9

Approximate gross internal area

109.85 sq m / 1182 sq ft

(Including External Vault & Store)

Vault 3.42 sq m / 37 sq ft

Store 1.66 sq m / 18 sq ft

Key :
CH - Ceiling Height

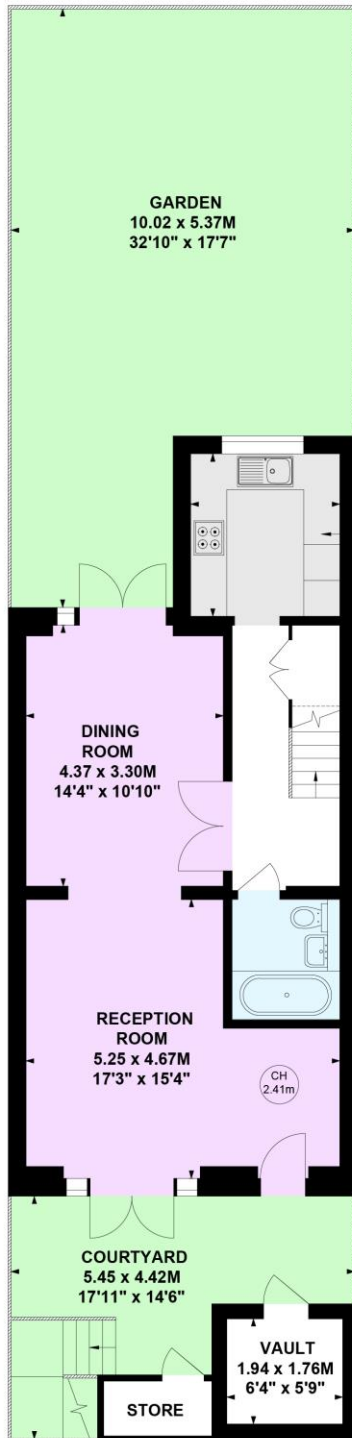

Lower Ground Floor



Raised Ground Floor

This plan is not to scale and must be used as layout guidance only. All measurements and areas are approximate and should not be relied upon to provide accurate information. This plan must not be relied upon when making property valuations, design considerations or any other such relevant decisions. We accept no responsibility or liability (whether in contract, tort or otherwise) in relation to any loss whatsoever arising from or in connection with any use of this plan or the adequacy, accuracy or completeness of it or any information within it.

