



# Maida Vale

London, W9

£2,750 per month  
(£634.62 per week)

This stunning one double bedroom, one bathroom apartment is situated on the ground floor within this impressive mansion block. The property comprises; spacious reception room, modern kitchen, one large double bedrooms and one luxury bathroom.



# Maida Vale

London, W9

- 1 bedroom
- 1 bathroom
- Portered block
- Superb finish



This stunning one double bedroom, one bathroom apartment is situated on the ground floor within this impressive mansion block. The property comprises; spacious reception room, modern kitchen, one large double bedrooms and one luxury bathroom.

This stunning apartment further benefits; high ceilings, parquet flooring, luxury bathroom, luxury kitchen and ample bespoke built-in storage.

Rodney Court is ideally situated moments from all the amenities of Little Venice and close to excellent transport links into the City.

**Minimum Term:** 12 months  
**Deposit Required:** 5 weeks  
**Local Authority:** City of Westminster  
**Council Tax Band:** D  
**EPC Rating:** E  
**Furnished**

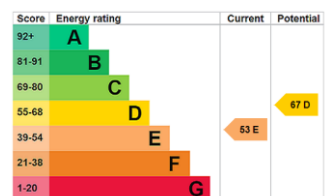

### *Chestertons Little Venice Lettings*

26 Clifton Road  
Maida Vale  
London  
W9 1SX  
littlevenicetlettingsusers@chestertons.co.uk  
02072662369  
chestertons.co.uk

Additional tenant charges apply (fees apply to non-AST tenancies only)  
Tenancy Agreement Fee: £300  
References per Tenant/Guarantor: £60  
Inventory check (approx. £100 – £250 inc. VAT)  
chestertons.co.uk/property-to-rent/applicable-fees

# Rodney Court, W9

○ - Ceiling Height

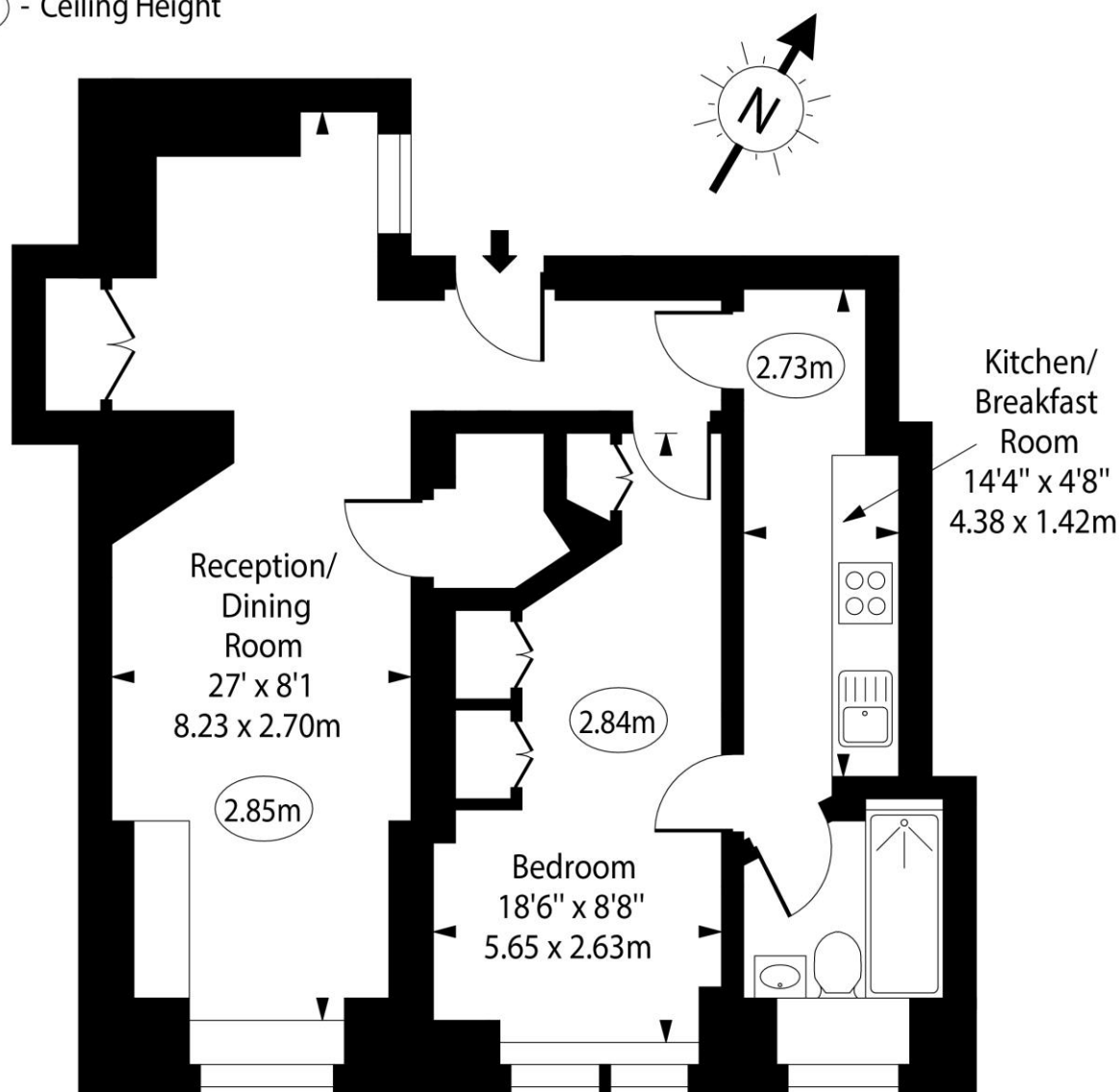

## Ground Floor

Approx Gross Internal Area      538 Sq Ft - 49.98 Sq M

For Illustration Purposes Only - Not To Scale

[www.goldlens.co.uk](http://www.goldlens.co.uk)

Ref. No. 016524R

