



Melbourne Court

Randolph Avenue, W9

£3,250 per month
(£750 per week)

A bright and spacious two bedroom apartment set one the sixth floor (with lift) in this portered purpose built block in the heart of Little Venice.

CHESTERTONS



Melbourne Court

Randolph Avenue, W9

- Modern Apartment In The Heart Of Leafy Little Venice
- Lounge With Hardwood Floors & fantastic City Views
- 2 Double Bedrooms With Lots Of Storage
- Moments from Warwick Avenue, With The Cafes of Clifton Road On The Doorstep & EPC Rating C



A modern apartment with wonderful city views on the 6th floor (with lift) in a sought after portered block. The property benefits from a large dual aspect reception leading on to a private balcony, modern kitchen, two double bedrooms and two bathrooms.

The property further benefits from a lift in the building and wooden flooring throughout the reception, hallways and bedrooms.

Melbourne Court is ideally located for the cafes of Clifton Road & Warwick Avenue Underground.

The property is available for a minimum of 12 months and subject to a 5 week deposit.

Minimum Term: 12 months
Deposit Required: 5 weeks
Local Authority: Westminster City Council
Council Tax Band: E
EPC Rating: C
Furnished

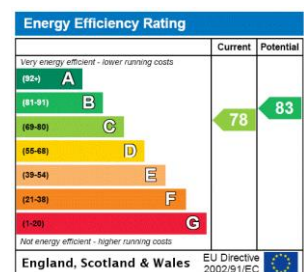

Chestertons Little Venice Lettings

26 Clifton Road
Maida Vale
London
W9 1SX
littlevenice@chestertons.co.uk
02072662369
chestertons.co.uk

Additional tenant charges apply (fees apply to non-AST tenancies only)
Tenancy Agreement Fee: £300
References per Tenant/Guarantor: £60
Inventory check (approx. £100 – £250 inc. VAT)
chestertons.co.uk/property-to-rent/applicable-fees

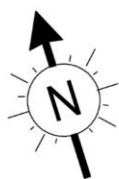

**Melbourne Court,
Randolph Avenue,
Little Venice, W9**

○ - Ceiling Height

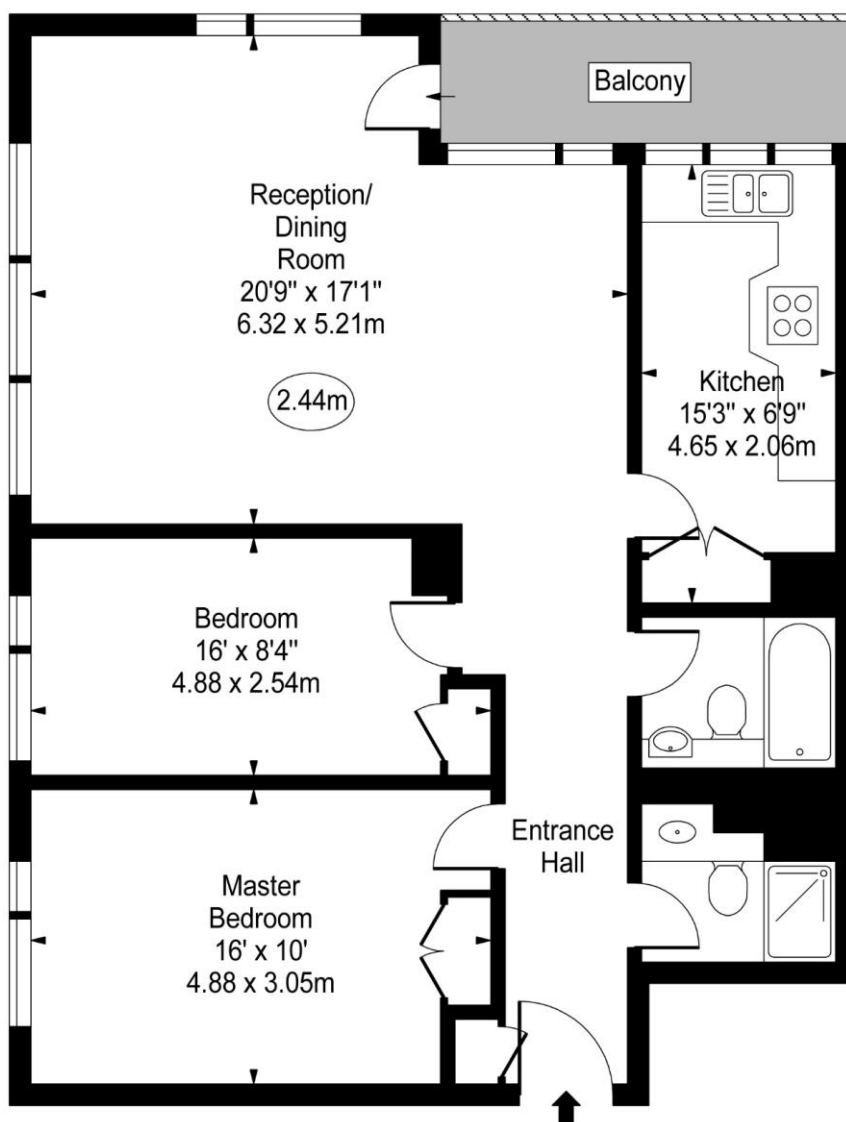

Sixth Floor

Approx Gross Internal Area 926 Sq Ft - 86.02 Sq M

For Illustration Purposes Only - Not To Scale

www.goldlens.co.uk

Ref. No. 015922E

