



Whaddon House

William Mews, SW1X

£6,150 per month
(£1,419.23 per week)

A recently refurbished 5th floor (top floor) lateral apartment, situated in a popular development with porter and lift access. Fitted with wood flooring throughout and benefiting from a stunning private balcony with impressive city views.



Whaddon House

William Mews, SW1X

- Newly refurbished throughout
- Wood flooring
- Lift access
- Porter
- Private balcony



A recently refurbished 5th floor (top floor) lateral apartment, situated in a popular development with porter and lift access. Fitted with wood flooring throughout and benefiting from a stunning private balcony with impressive city views.

The accommodation is circa 1,007 sq ft and includes a spacious reception/dining room with sliding doors providing access to the private balcony, modern open plan kitchen, two double bedrooms and two bathrooms.

Located just a short walk from Hyde Park, Harvey Nichols, Harrods and all the boutiques and shops of Sloane Street and Brompton Road.

Minimum Term: 12 months
Deposit Required: £8,515.38
Local Authority: City Of Westminster
Council Tax Band: G
EPC Rating: D
Furnished

Energy Efficiency Rating		
	Current	Potential
Very energy efficient - lower running costs		
A (92-100)		
B (81-91)		
C (69-80)		79
D (55-68)	60	
E (39-54)		
F (21-38)		
G (1-20)		
Not energy efficient - higher running costs		
England, Scotland & Wales		EU Directive 2002/91/EC

Chestertons Knightsbridge & Belgravia Lettings

31 Lowndes Street
 London
 SW1X 9HX
knightsbridglettingsusers@chestertons.co.uk
 02072353530
chestertons.co.uk

Additional tenant charges apply (fees apply to non-AST tenancies only)
 Tenancy Agreement Fee: £300
 References per Tenant/Guarantor: £60
 Inventory check (approx. £100 – £250 inc. VAT)
chestertons.co.uk/property-to-rent/applicable-fees



Whaddon House,
Williams Mews, SW1X
Approximate Gross Internal Area
93.53 sq m / 1,007 sq ft
(CH = Ceiling Heights)

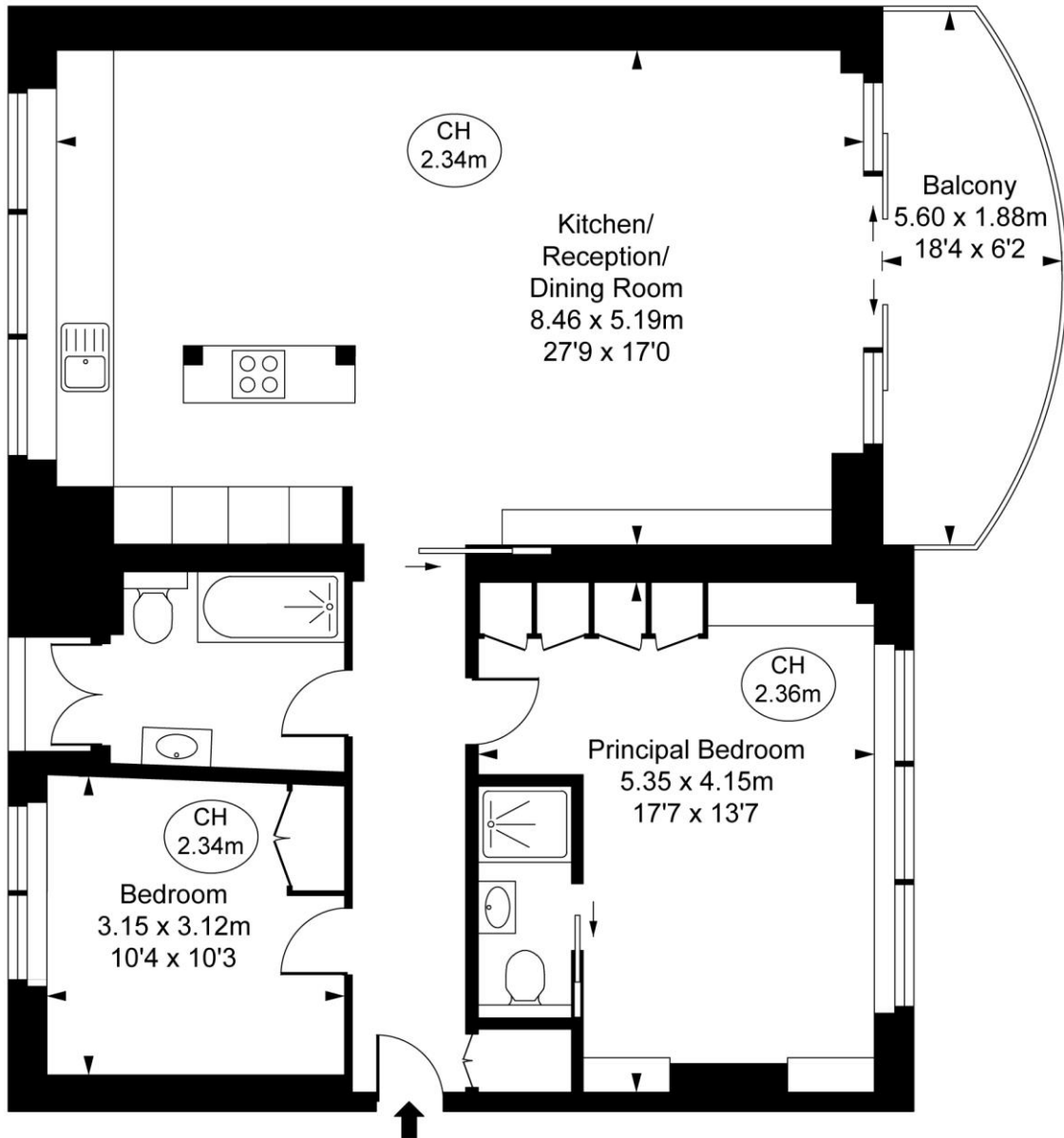

Fifth Floor

This plan is not to scale. It is for guidance and not for valuation purposes.
All measurements and areas are approximate only, and have been prepared in accordance with the current edition of the RICS Code of Measuring Practice.
© Fulham Performance

