



# Kinnerton Place South

Belgravia, SW1X

£3,445 per month  
(£795 per week)

Recently refurbished apartment comprising part of a smart period conversion. The property includes a spacious reception/dining room, fully fitted kitchen, double bedroom and modern bathroom. Rent inclusive of utilities.

**CHESTERTONS**

## Kinnerton Place South, SW1X

Approximate Gross Internal Area  
47.69 sq m / 513 sq ft

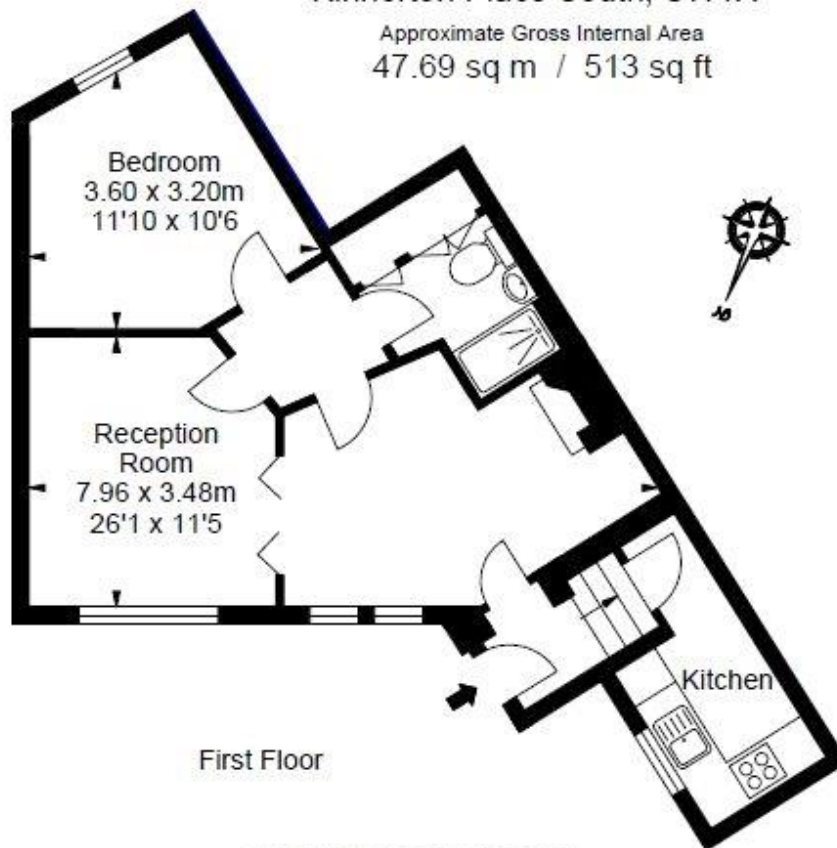

ILLUSTRATION FOR IDENTIFICATION PURPOSES ONLY  
ALL MEASUREMENTS ARE MAXIMUM, AND INCLUDE WINDOW BAYS AND WARDROBES WHERE APPLICABLE  
THIS PLAN MUST NOT BE REPRODUCED BY ANY OTHER PERSON WITHOUT PERMISSION

**Minimum Term:** 12 months  
**Deposit Required:** £3,975.00  
**Local Authority:** City of Westminster  
**Council Tax Band:** F  
**EPC Rating:** D  
**Furnished**

| Energy Efficiency Rating                    |   | Current                    | Potential |
|---|---|----------------------------|-----------|
| Very energy efficient - lower running costs |   |                            |           |
| (92+)                                       | A |                            |           |
| (81-91)                                     | B |                            |           |
| (69-80)                                     | C |                            | 75        |
| (55-68)                                     | D | 61                         |           |
| (39-54)                                     | E |                            |           |
| (21-38)                                     | F |                            |           |
| (1-20)                                      | G |                            |           |
| Not energy efficient - higher running costs |   |                            |           |
| England, Scotland & Wales                   |   | EU Directive<br>2002/91/EC |           |

### Chestertons Knightsbridge & Belgravia Lettings

31 Lowndes Street  
London  
SW1X 9HX  
knightsbridge@chestertons.co.uk  
02072353530  
chestertons.co.uk

Additional tenant charges apply (fees apply to non-AST tenancies only)

Tenancy Agreement Fee: £300

References per Tenant/Guarantor: £60

Inventory check (approx. £100 – £250 inc. VAT)

[chestertons.co.uk/property-to-rent/applicable-fees](http://chestertons.co.uk/property-to-rent/applicable-fees)

Chesterton Global Ltd trading as Chestertons for themselves and for the vendor of this property whose agents they are, give notice that (i) these particulars do not constitute any part of an offer or contract, (ii) all statements contained within these particulars are made without responsibility on the part of Chestertons or the vendor, (iii) whilst made in good faith, none of the statements contained within these particulars are to be relied upon as a statement or representation of fact, (iv) any intending purchasers must satisfy themselves by inspection or otherwise as to the correctness of each of the statements contained within these particulars, (v) the vendor does not make or give either Chestertons or any person in their employment any authority to make or give representation or warranty whatsoever in relation to this property. Wide angle lenses may be used. ©Copyright Chestertons | Chesterton Global Ltd | Registered Office 40 Connaught Street, Hyde Park, London W2 2AB Registered Company Number 05334580.



This paper is  
100% recyclable