



# Lennox Gardens

London, SW1X

£9,500 per month  
(£2,192.31 per week)

Stunning apartment with communal garden access and caretaker. The apartment has been recently renovated to an extremely high standard and offers beautiful wood flooring, a spacious reception and modern fixtures and fittings.

CHESTERTONS

LENNOX GARDENS, CHELSEA, LONDON SW1

TOTAL AREAS SHOWN ON PLAN  
1010 SQ.FT. / 93.8 SQ.M.

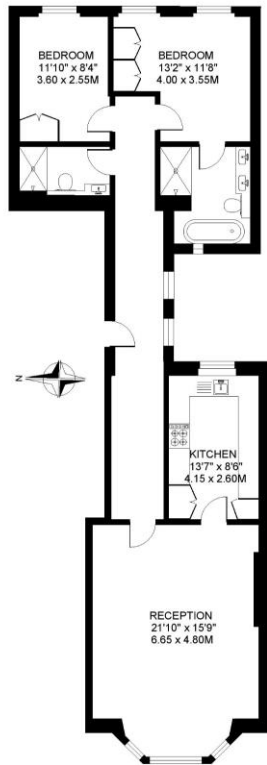

GROUND FLOOR

COPYRIGHT: Floorplan produced for "Henry & James Estate Agents Ltd." by floorplanners.co.uk  
This plan is not to a given scale, and is for guidance only, and must not be relied upon as a statement of fact.  
All measurements are maximum, and include window bays, and wardrobes where applicable.  
This plan has been prepared in accordance with the "RICS" Code of Measuring Practice.  
Where a room has a sloping ceiling, the dotted line indicates height at 1.5m, and measurements are shown at floor level.

**Minimum Term:** 12 months  
**Deposit Required:** £13,153.85  
**Local Authority:** Royal Borough of Kensington & Chelsea  
**Council Tax Band:** G  
**EPC Rating:** D  
**Furnished**

Energy Efficiency Rating		Current	Potential
Very energy efficient - lower running costs			
(92+)	A		
(81-91)	B		
(69-80)	C		
(55-68)	D	62	73
(39-54)	E		
(21-38)	F		
(1-20)	G		
Not energy efficient - higher running costs			
England, Scotland & Wales		EU Directive 2002/91/EC	

**Chestertons Premier Property Management**

26 Clifton Road  
London  
W9 1SX  
premier.dept@chestertons.co.uk  
02072985908  
chestertons.co.uk

Additional tenant charges apply (fees apply to non-AST tenancies only)

Tenancy Agreement Fee: £300  
References per Tenant/Guarantor: £60  
Inventory check (approx. £100 – £250 inc. VAT)  
chestertons.co.uk/property-to-rent/applicable-fees

Chesterton Global Ltd trading as Chestertons for themselves and for the vendor of this property whose agents they are, give notice that (i) these particulars do not constitute any part of an offer or contract, (ii) all statements contained within these particulars are made without responsibility on the part of Chestertons or the vendor, (iii) whilst made in good faith, none of the statements contained within these particulars are to be relied upon as a statement or representation of fact, (iv) any intending purchasers must satisfy themselves by inspection or otherwise as to the correctness of each of the statements contained within these particulars, (v) the vendor does not make or give either Chestertons or any person in their employment any authority to make or give representation or warranty whatsoever in relation to this property. Wide angle lenses may be used. ©Copyright Chestertons | Chesterton Global Ltd | Registered Office 40 Connaught Street, Hyde Park, London W2 2AB Registered Company Number 05334580.



This paper is 100% recyclable