



Sinclair Road

Kensington, W14

£2,166 per month
(£499.85 per week)

An excellent and well-balanced 2nd floor one double bedroom period conversion apartment located within this striking Victorian building.

Offering generous ceiling heights and attractive views to the front of the property.



Sinclair Road

Kensington, W14



An excellent and well-balanced 2nd floor one double bedroom period conversion apartment located within this striking Victorian building.

Comprising a large open-plan kitchen/ reception, generous shower room, good ceiling heights and offering attractive views to the front of the property.

Sinclair Road is an attractive street ideally located for the shopping, transport and leisure amenities of Westfield shopping centre and Shepherds Bush. Brook Green, Kensington High Street and the green open spaces of Holland Park are within close proximity.

Minimum Term: 6 months
Deposit Required: £2,499.23
Local Authority: Royal Borough of Kensington & Chelsea
Council Tax Band: C
EPC Rating: C
Furnished

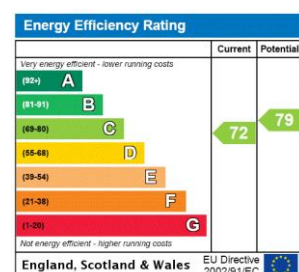

Chestertons Kensington Lettings

116 Kensington High Street
 Kensington
 London
 W8 7RW
kensington@chestertons.co.uk
 02079377260
chestertons.co.uk

Additional tenant charges apply (fees apply to non-AST tenancies only)
 Tenancy Agreement Fee: £300
 References per Tenant/Guarantor: £60
 Inventory check (approx. £100 – £250 inc. VAT)
chestertons.co.uk/property-to-rent/applicable-fees

Sinclair Road, W14
Approximate Gross Internal Area
33.14 sq m / 357 sq ft
(CH = Ceiling Heights)

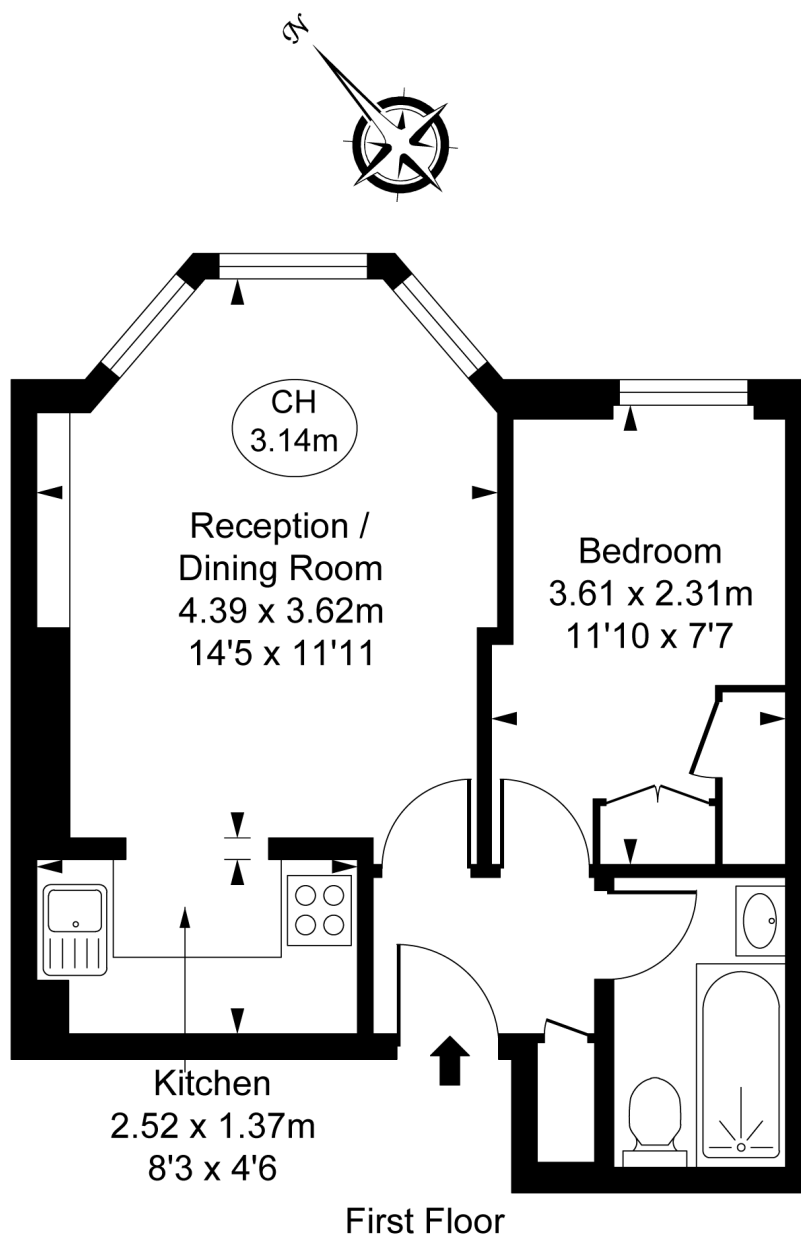

This plan is not to scale. It is for guidance and not for valuation purposes.
All measurements and areas are approximate only, and have been prepared in accordance with the current edition of the RICS Code of Measuring Practice.
© Fulham Performance

