



# Lexham Gardens

London, W8

£5,828.33 per month  
(£1,345 per week)

This raised ground-floor garden flat is nestled within a charming period building, offering a blend of classic elegance and modern comfort.



# Lexham Gardens

London, W8

- 2 bedrooms
- 2 bathrooms
- newly refurbished
- shared garden



This raised ground-floor garden flat is nestled within a charming period building, offering a blend of classic elegance and modern comfort.

The apartment boasts two generously sized double bedrooms, with one featuring an en suite shower room and the other providing direct access to a private garden. This creates a seamless indoor-outdoor living experience, perfect for relaxation and entertaining.

In addition to the well-appointed bedrooms, the property includes a contemporary family bathroom and a fully fitted kitchen, equipped with all the essentials for comfortable urban living. The flat's tasteful combination of timeless design and modern amenities makes it an ideal retreat in the heart of the city.

Lexham Gardens enjoys a prime location offering a wide selection of shops, bars, and restaurants. For excellent transport connections, Gloucester Road Underground Station (Circle, District, and Piccadilly lines) and High Street Kensington (District and Circle lines) are conveniently nearby.

**Minimum Term:** 12 months  
**Deposit Required:** £8,070.00  
**Local Authority:** Royal Borough of Kensington & Chelsea  
**Council Tax Band:** F  
**EPC Rating:** C

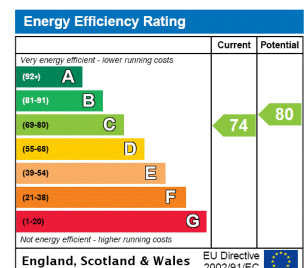

### Chestertons Kensington Lettings

116 Kensington High Street  
 Kensington  
 London  
 W8 7RW  
 kensington@chestertons.co.uk  
 02079377260  
 chestertons.co.uk

Additional tenant charges apply (fees apply to non-AST tenancies only)  
 Tenancy Agreement Fee: £300  
 References per Tenant/Guarantor: £60  
 Inventory check (approx. £100 – £250 inc. VAT)  
[chestertons.co.uk/property-to-rent/applicable-fees](https://www.chestertons.co.uk/property-to-rent/applicable-fees)

## Lexham Gardens, W8

Approximate gross internal area  
93.74 sq m / 1009 sq ft



Key :  
CH - Ceiling Height

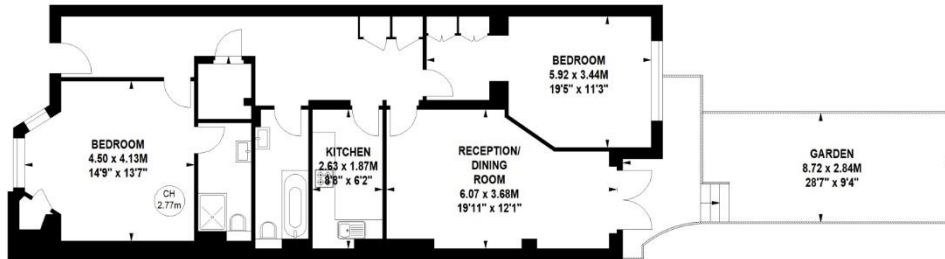

### Lower Ground Floor

Not to scale, for guidance only and must not be relied upon as a statement of fact.  
All measurements and areas are approximate only

