



Sinclair Road

Hammersmith, W14

£2,800 per month
(£646.15 per week)

Moments from Kensington Olympia.

The Atelier building is brand new and built to the highest of standards. Benefits include concierge, gym, cinema room.



Sinclair Road

Hammersmith, W14

- Second floor brand new one bedroom apartment
- New boutique development
- Located moments from Kensington Olympia
- Benefits include concierge, gym, cinema room



New one bedroom apartment within new development. Located moments from Kensington Olympia. The Atelier building is brand new and built to the highest of standards. Benefits include concierge, gym, cinema room.

Minimum Term: 6 months
Deposit Required: £3,230.77
Local Authority: Hammersmith & Fulham
Council Tax Band: F
EPC Rating: B
Furnished

Energy Efficiency Rating		Current	Potential
Very energy efficient - lower running costs			
(92-100)	A		
(81-91)	B	84	84
(69-80)	C		
(55-68)	D		
(39-54)	E		
(21-38)	F		
(1-20)	G		
Not energy efficient - higher running costs			
England, Scotland & Wales		EU Directive 2002/91/EC	

Chestertons Kensington Lettings

116 Kensington High Street
 Kensington
 London
 W8 7RW
 kensington@chestertons.co.uk
 02079377260
 chestertons.co.uk

Additional tenant charges apply (fees apply to non-AST tenancies only)
 Tenancy Agreement Fee: £300
 References per Tenant/Guarantor: £60
 Inventory check (approx. £100 – £250 inc. VAT)
chestertons.co.uk/property-to-rent/applicable-fees

**The Atelier,
Sinclair Road,
Hammersmith, W14**

Approximate gross internal area
51.56 sq m / 555 sq ft

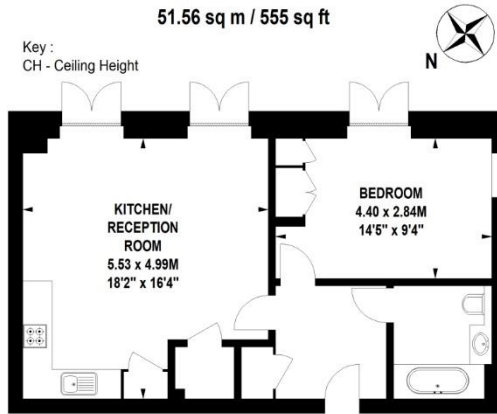

Second Floor

Not to scale, for guidance only and must not be relied upon as a statement of fact.
All measurements and areas are approximate only

