



Kensington Court

W8

£5,800 per month (9 months)
£5,500 per month (12 months)

A newly refurbished third floor apartment in a period red-brick block with a lift and porter. The style is modern/ contemporary with wooden flooring, marble tiles and bespoke lighting and joinery.



Kensington Court

W8

- Superb prime central location
- Close to parks and green spaces
- Excellent transport links
- Good for local amenities
- Easy access to transport
- Newly refurbished
- Separate storage included within the building



A newly refurbished third floor apartment in a period red-brick block with a lift and porter. The style is modern/contemporary with wooden flooring, marble tiles and bespoke lighting and joinery.

The property comprises: two double bedrooms, two bathrooms (main en suite), modern, well-equipped kitchen (with breakfast bar) and a reception/ dining room. The property has an abundance of good storage including a separate storage room in the basement.

Kensington Court is located just off Kensington High Street and offers momentary access to the boutique shops, restaurants and supermarkets (Whole Foods, M&S Food and Waitrose) on the High Street. The District and Circle Line (Zone 1) Tube Station is 0.3 miles from the apartment as are a good selection of bus routes. The green spaces of Hyde Park, Kensington Gardens and Holland Park are within 0.5 miles.

Minimum Term: 6 months
Deposit Required: £7,615.38
Local Authority: Royal Borough of Kensington & Chelsea
Council Tax Band: F
EPC Rating: D
Furnished

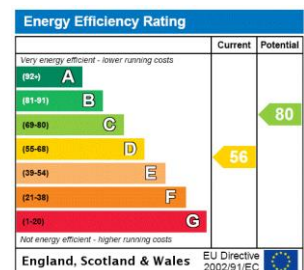

Chestertons Kensington Lettings

116 Kensington High Street
 Kensington
 London
 W8 7RW
 kensington@chestertons.co.uk
 02079377260
 chestertons.co.uk

Additional tenant charges apply (fees apply to non-AST tenancies only)
 Tenancy Agreement Fee: £300
 References per Tenant/Guarantor: £60
 Inventory check (approx. £100 – £250 inc. VAT)
chestertons.co.uk/property-to-rent/applicable-fees

Kent House, Kensington Court, W8

○ - Ceiling Height

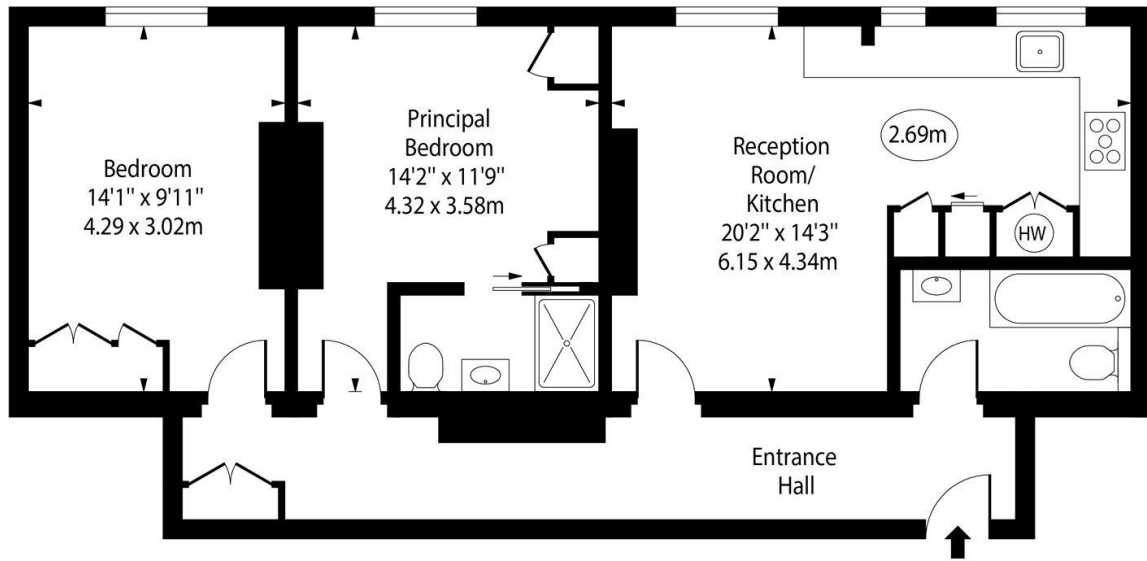

Third Floor

Approx Gross Internal Area 775 Sq Ft - 72.00 Sq M

For Illustration Purposes Only - Not To Scale
www.goldlens.co.uk
Ref. No. 018714JU

