



Warwick Gardens

Kensington, W14

£34,450 per month
(£7,950 per week)

Elegant six bedroom house with annex and 50 foot garden with conservatory. The property offers a modern kitchen, utility room, further four reception rooms, off street parking for 2/3 cars & air conditioning.



Warwick Gardens

Kensington, W14

- A grand semi detached house with a substantial secure garden and terrace
- 6 Bedrooms (including a one bedroom annexe with own entrance)
- 3 Reception rooms including a formal drawing, family room & dining room
- Gated off-street parking for up to 3 cars; Ideally located for Holland Park, Kensington



VIDEO AVAILABLE An elegant and well presented 6 bedroom house in Kensington that offers a huge amount of entertaining and family living space.

The property is arranged over five floors, with two reception rooms at garden level along with a modern kitchen and utility room. Within the east and south facing garden there is a studio that is fully equipped with air-conditioning and television points. There is also a self sufficient studio with private access that has a fully fitted kitchen, en-suite bathroom, reception room and bedroom.

The master bedroom is accompanied with two dressing rooms and

Minimum Term: 6 months
Deposit Required: £47,700.00
Local Authority:
Council Tax Band:
EPC Rating: E
Part Furnished, Unfurnished

Energy Efficiency Rating		
	Current	Potential
Very energy efficient - lower running costs		
A (92-100)		
B (81-91)		
C (69-80)		
D (55-68)		
E (39-54)	42	
F (21-38)		
G (1-20)		
Not energy efficient - higher running costs		
England, Scotland & Wales EU Directive 2002/91/EC		

Chestertons Kensington Lettings

116 Kensington High Street
 Kensington
 London
 W8 7RW
kensington@chestertons.co.uk
 02079377260
chestertons.co.uk

Additional tenant charges apply (fees apply to non-AST tenancies only)
 Tenancy Agreement Fee: £300
 References per Tenant/Guarantor: £60
 Inventory check (approx. £100 – £250 inc. VAT)
chestertons.co.uk/property-to-rent/applicable-fees

Warwick Gardens, W14

Approximate Gross Internal Area = 483.9 sq m / 5208 sq ft

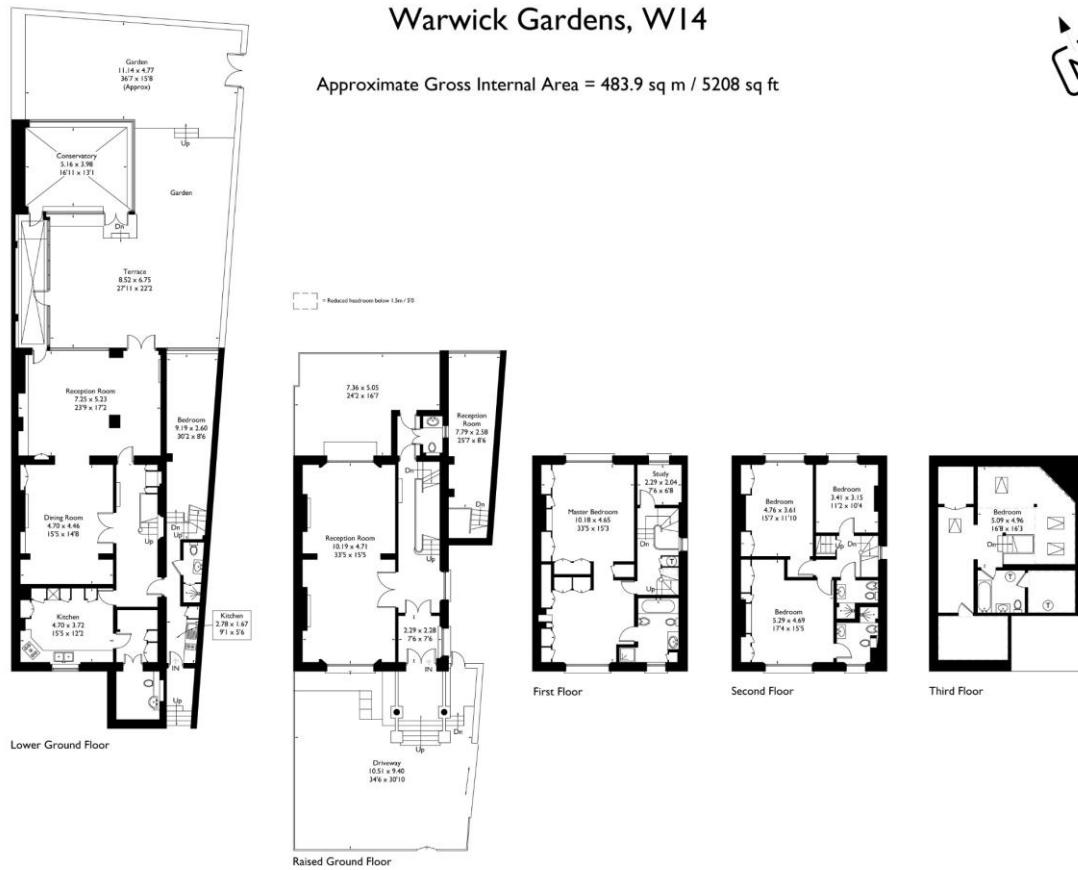

FLOORPLANZ © 2015 0845 6344080 Ref: 151402

This plan is for layout guidance only. Drawn in accordance with RICS guidelines. Not drawn to scale unless stated. Windows & door openings are approximate. Whilst every care is taken in the preparation of this plan, please check all dimensions, shapes & compass bearings before making any decisions reliant upon them.

