



# Goldfinch Court

713a Finchley Road, NW11

£2,350 per month  
(£542.31 per week)

A beautiful 2-bedroom apartment on the 4th floor of this modern purpose-built block with lift, private balcony communal gardens on the 2nd floor and underground parking with charging bay. The property is situated in this excellent location within walking distance to Golders Green and the open green spaces of Hampstead (Northern Lines). Accommodation comprises reception room, fully fitted kitchen, main bedroom with fitted wardrobes, 2nd bedroom, bathroom. Sole Agent.

**CHESTERTONS**



# Goldfinch Court

## 713a Finchley Road, NW11

- A Beautiful 4th Floor Apartment in Modern Purpose-Built Block
- 2 Bedrooms, 1 Bathroom, Reception, Fully Fitted Kitchen
- Lift, Balcony, Communal Gardens on 2nd Floor, Underground Parking, Porter
- Excellent Location, Walking Distance to Golders Green and Hampstead (Northern Lines)





**Minimum Term:** 18 months  
**Deposit Required:** £2,711.54  
**Local Authority:** London Borough of Barnet  
**Council Tax Band:** E  
**EPC Rating:** To be confirmed  
**Unfurnished**

Energy Efficiency Rating		
	Current	Potential
Very energy efficient - lower running costs		
(94-100) <b>A</b>		
(81-93) <b>B</b>	85	85
(69-80) <b>C</b>		
(55-68) <b>D</b>		
(39-54) <b>E</b>		
(21-38) <b>F</b>		
(1-20) <b>G</b>		
Not energy efficient - higher running costs		
England, Scotland & Wales EU Directive 2002/91/EC		

### *Chestertons Hampstead Lettings*

55-56 Hampstead High Street  
 Hampstead  
 London  
 NW3 1QH  
[hampsteadlettingsusers@chestertons.co.uk](mailto:hampsteadlettingsusers@chestertons.co.uk)  
 02077941125  
[chestertons.co.uk](http://chestertons.co.uk)

Additional tenant charges apply (fees apply to non-AST tenancies only)  
 Tenancy Agreement Fee: £300  
 References per Tenant/Guarantor: £60  
 Inventory check (approx. £100 – £250 inc. VAT)  
[chestertons.co.uk/property-to-rent/applicable-fees](http://chestertons.co.uk/property-to-rent/applicable-fees)

# Goldfinch Court, Finchley Road, NW11

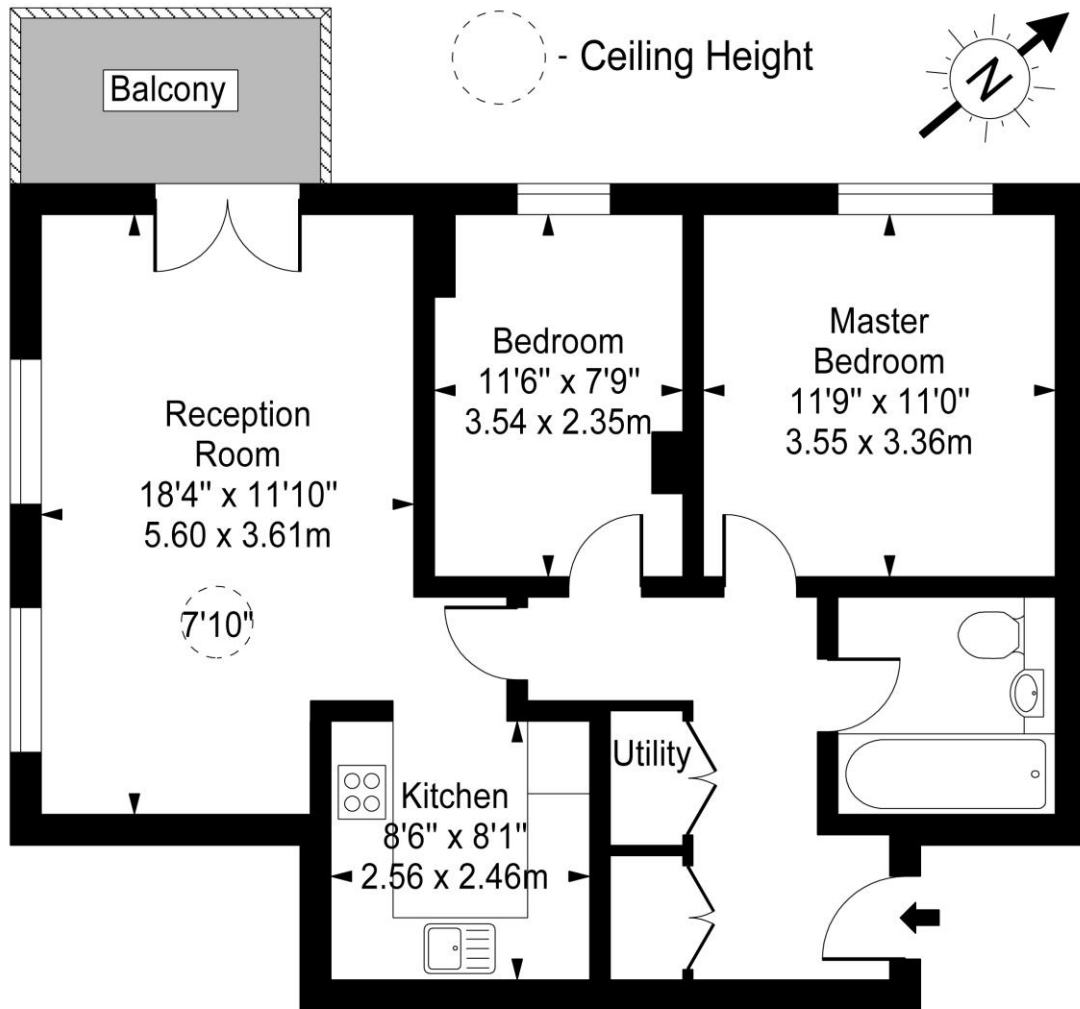

Fourth Floor

Approx Gross Internal Area **705 Sq Ft - 65.5 Sq M**

For Illustration Purposes Only - Not To Scale  
[www.goldlens.co.uk](http://www.goldlens.co.uk)

Prepared for Chestertons  
 Ref. No. 012351MiV