



# East Heath Road

Hampstead, NW3

£2,750 per month  
(£634.62 per week)

\*VIDEO TOUR AVAILABLE\*. A charming 2 bedroom apartment with its own entrance and boasting a private front garden, wood floors in the reception room and high ceilings in this period building in Hampstead. Sole Agent.

**CHESTERTONS**



# East Heath Road

## Hampstead, NW3

- A Charming Lower Ground Floor Apartment
- 2 Bedrooms, 1 Bathroom, Reception, Kitchen
- Own Entrance, Front Patio Garden, Wood Floors
- Situated Opposite Open Green Spaces of Hampstead Heath





\*VIDEO TOUR AVAILABLE\*. A charming 2 bedroom apartment with its own entrance and boasting a private front garden, wood floors in the reception room and high ceilings in this period building in Hampstead. The property is set back well back from the road opposite the green open spaces of Hampstead Heath. Accommodation comprises reception room, kitchen, master bedroom with fitted wardrobes and en-suite shower room, double bedroom, smart family bathroom.

**Minimum Term:** 12 months  
**Deposit Required:** £3,173.08  
**Local Authority:** London Borough Of Camden  
**Council Tax Band:** NA  
**EPC Rating:** C  
**Part Furnished**

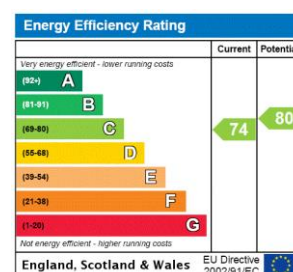

### *Chestertons Hampstead Lettings*

55-56 Hampstead High Street  
 Hampstead  
 London  
 NW3 1QH  
[hampsteadlettingsusers@chestertons.co.uk](mailto:hampsteadlettingsusers@chestertons.co.uk)  
 02077941125  
[chestertons.co.uk](http://chestertons.co.uk)

Additional tenant charges apply (fees apply to non-AST tenancies only)  
 Tenancy Agreement Fee: £300  
 References per Tenant/Guarantor: £60  
 Inventory check (approx. £100 – £250 inc. VAT)  
[chestertons.co.uk/property-to-rent/applicable-fees](http://chestertons.co.uk/property-to-rent/applicable-fees)

# East Heath Road, Hampstead, London, NW3

Approximate Gross Internal Floor Area = 74.0 sq m / 797 sq ft

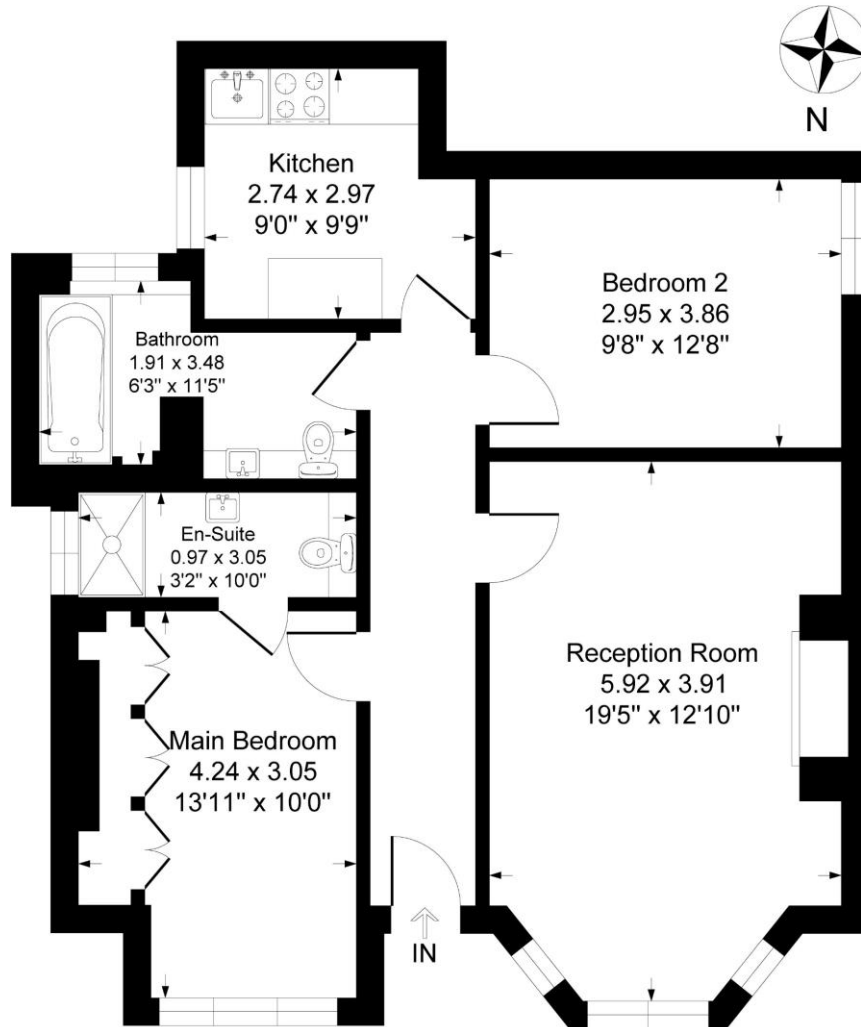

Lower Ground Floor

Illustration for identification purposes only, measurements are approximate, not to scale.

