



# Quex Road

West Hampstead, NW6

£1,800 per month  
(£415.38 per week)

A delightful 2nd floor apartment with balcony and wood floors. The property is situated in this desirable road within close proximity to the amenities of West End Lane and Kilburn High Road (Jubilee Line & Thameslink). Accommodation comprises reception room, open plan kitchen with direct access to the balcony, double bedroom with fitted wardrobes, shower room.

**CHESTERTONS**



# Quex Road

## West Hampstead, NW6

- A Lovely 2nd Floor Apartment
- 1 Bedroom, 1 Bathroom, Reception, Open Plan Kitchen
- Balcony, Wood Floors
- Situated in this Desirable Road, Close Proximity to the Amenities of West End Lane and Kilburn High Road (Jubilee Line & Metropolitan)



**Minimum Term:** 12 months  
**Deposit Required:** £2,076.92  
**Local Authority:** London Borough Of Camden  
**Council Tax Band:** A  
**EPC Rating:** D  
**Part Furnished**

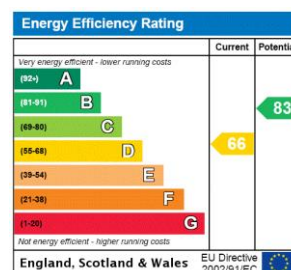

### Chestertons Hampstead Lettings

55-56 Hampstead High Street  
 Hampstead  
 London  
 NW3 1QH  
[hampsteadlettingsusers@chestertons.co.uk](mailto:hampsteadlettingsusers@chestertons.co.uk)  
 02077941125  
[chestertons.co.uk](http://chestertons.co.uk)

Additional tenant charges apply (fees apply to non-AST tenancies only)  
 Tenancy Agreement Fee: £300  
 References per Tenant/Guarantor: £60  
 Inventory check (approx. £100 – £250 inc. VAT)  
[chestertons.co.uk/property-to-rent/applicable-fees](http://chestertons.co.uk/property-to-rent/applicable-fees)

**Quex Road,  
West Hampstead, NW6**



- Ceiling Height

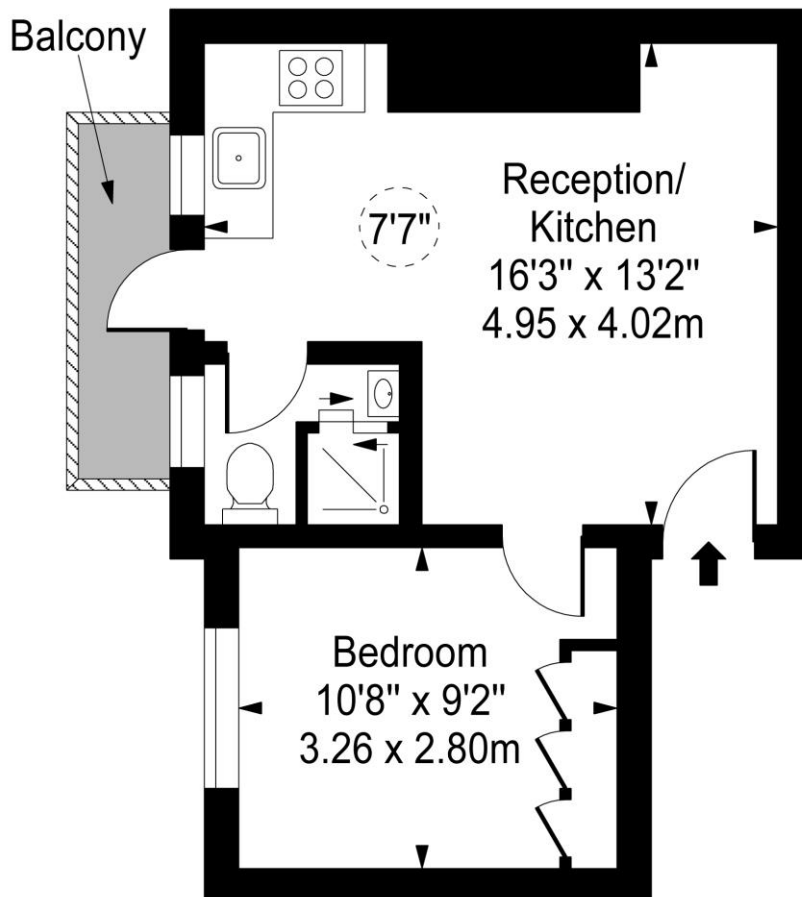
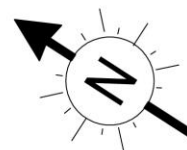

**Third Floor**

**Approx Gross Internal Area     334 Sq Ft - 31.02 Sq M**

For Illustration Purposes Only - Not To Scale

[www.goldlens.co.uk](http://www.goldlens.co.uk)

Prepared for Chestertons

Ref. No. 012987MiV

