



Viridium Apartments

264-270 Finchley Road, NW3

£4,300 per month
(£992.31 per week)

VIDEO TOUR AVAILABLE. A fantastic 3 double bedroom duplex apartment on the ground and lower ground floors of this modern development boasting private patio, floor to ceiling windows and wood floors within walking distance to Hampstead Village.

CHESTERTONS



Viridium Apartments

264-270 Finchley Road, NW3

- A Beautiful Duplex Apartment on Ground/Lower Ground Floors of Modern Development
- 3 Bedrooms, 2 Bathrooms, Reception, Open Plan Fully Fitted Kitchen with Breakfast Bar
- Floor to Ceiling Windows, Wood Floors, Lift
- Situated Within Walking Distance to Hampstead Village (Northern Line), Within Close Proximity to Finchley Road (Jubilee Line)



VIDEO TOUR AVAILABLE. A fantastic 3 double bedroom duplex apartment on the ground and lower ground floors of this modern development boasting a private patio, floor to ceiling windows, wood floors and carpets in the bedroom. The property is situated within walking distance to Hampstead Village (Northern Line) and within close proximity to Finchley Road (Jubilee Line). Accommodation comprises reception room, open plan fully fitted kitchen with breakfast bar, master bedroom with en-suite shower room, 2 further double bedrooms, ultra modern bathroom, storage room.

Minimum Term: 18 months
Deposit Required: £5,953.85
Local Authority: London Borough Of Camden
Council Tax Band: G
EPC Rating: B
Furnished

Energy Efficiency Rating		
	Current	Potential
Very energy efficient - lower running costs		
A (92-100)		
B (81-91)	90	90
C (69-80)		
D (55-68)		
E (39-54)		
F (21-38)		
G (1-20)		
Not energy efficient - higher running costs		
England, Scotland & Wales		EU Directive 2002/91/EC

Chestertons Hampstead Lettings

55-56 Hampstead High Street
 Hampstead
 London
 NW3 1QH
hampsteadlettingsusers@chestertons.co.uk
 02077941125
chestertons.co.uk

Additional tenant charges apply (fees apply to non-AST tenancies only)
 Tenancy Agreement Fee: £300
 References per Tenant/Guarantor: £60
 Inventory check (approx. £100 – £250 inc. VAT)
chestertons.co.uk/property-to-rent/applicable-fees

Finchley Road, NW3

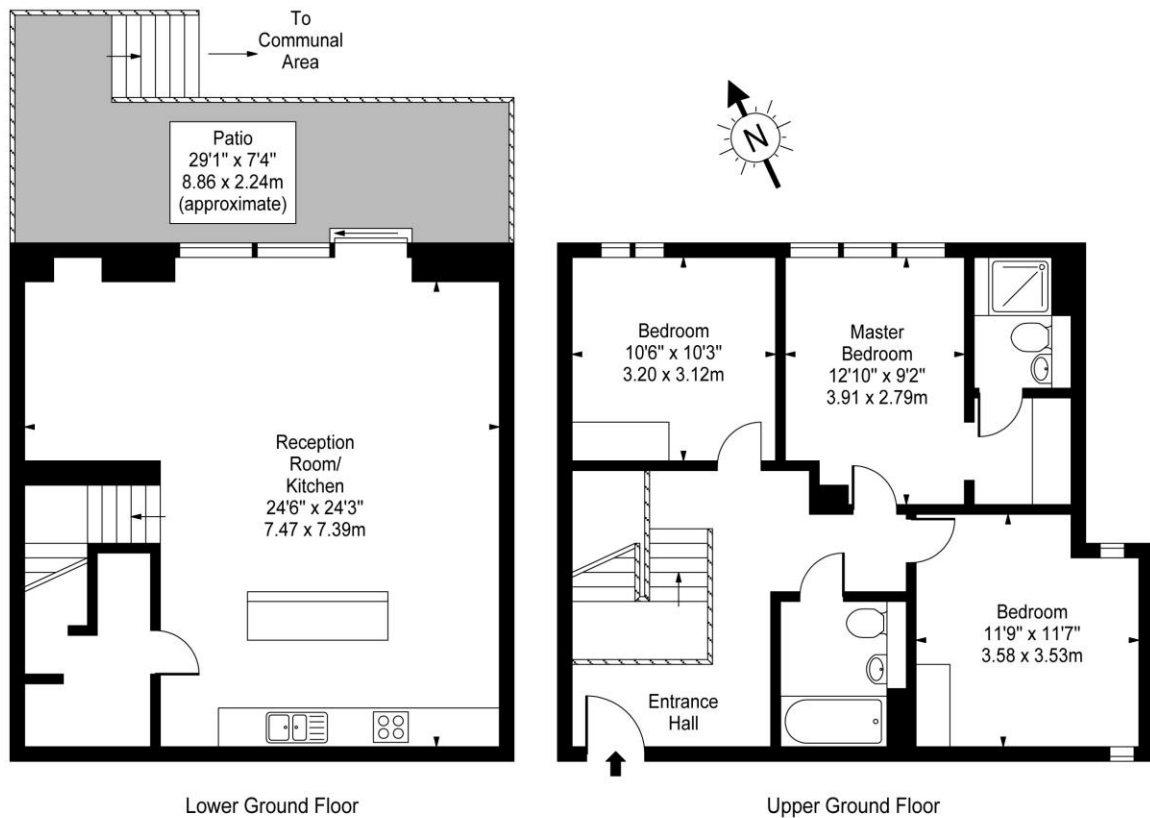

Approx Gross Internal Area **1292 Sq Ft - 120.03 Sq M**

For Illustration Purposes Only - Not To Scale

www.goldlens.co.uk

Prepared for Chestertons

Ref. No. 009547K

