



Visage Apartments

Winchester Road, NW3

£6,500 per month
(£1,500 per week)

****Short Let**** Short Let. A luxurious 4th floor apartment in this modern purpose built block with dark wood floors throughout, private balcony, floor to ceiling windows, lift, 24 hour portage and underground parking (under separate negotiation). The property is ideally situated close to Swiss Cottage Underground Station (Jubilee Line). Accommodation comprises grand reception room and dining area with direct access to the balcony, open plan fully kitchen, master bedroom with fitted wardrobes, bathroom, cloaks cupboard.



Visage Apartments

Winchester Road, NW3

- Short Let. A Luxurious 4th Floor Apartment in Modern Purpose Built Block
- 1 Bedroom, 1 Bathroom, Reception, Kitchen
- Dark Wood Floors, Private Balcony, Underground Parking (Under Separate Negotiation), Lift, 24 Hour Porterage
- Situated in Excellent Location in Swiss Cottage (Jubilee Line)



Minimum Term: 1 months
Deposit Required: £6,000.00
Local Authority: London Borough Of Camden
Council Tax Band: E
EPC Rating: C
Furnished

Energy Efficiency Rating		
	Current	Potential
Very energy efficient - lower running costs		
(94-100) A		
(81-93) B		86
(69-80) C	75	
(55-68) D		
(39-54) E		
(21-38) F		
(1-20) G		
Not energy efficient - higher running costs		
England, Scotland & Wales		EU Directive 2002/91/EC

Chestertons Hampstead Lettings

55-56 Hampstead High Street
 Hampstead
 London
 NW3 1QH
hampstead@chestertons.co.uk
 02077941125
chestertons.co.uk

Additional tenant charges apply (fees apply to non-AST tenancies only)
 Tenancy Agreement Fee: £300
 References per Tenant/Guarantor: £60
 Inventory check (approx. £100 – £250 inc. VAT)
chestertons.co.uk/property-to-rent/applicable-fees

**Visage Apartments,
Winchester Road,
Swiss Cottage, NW3**

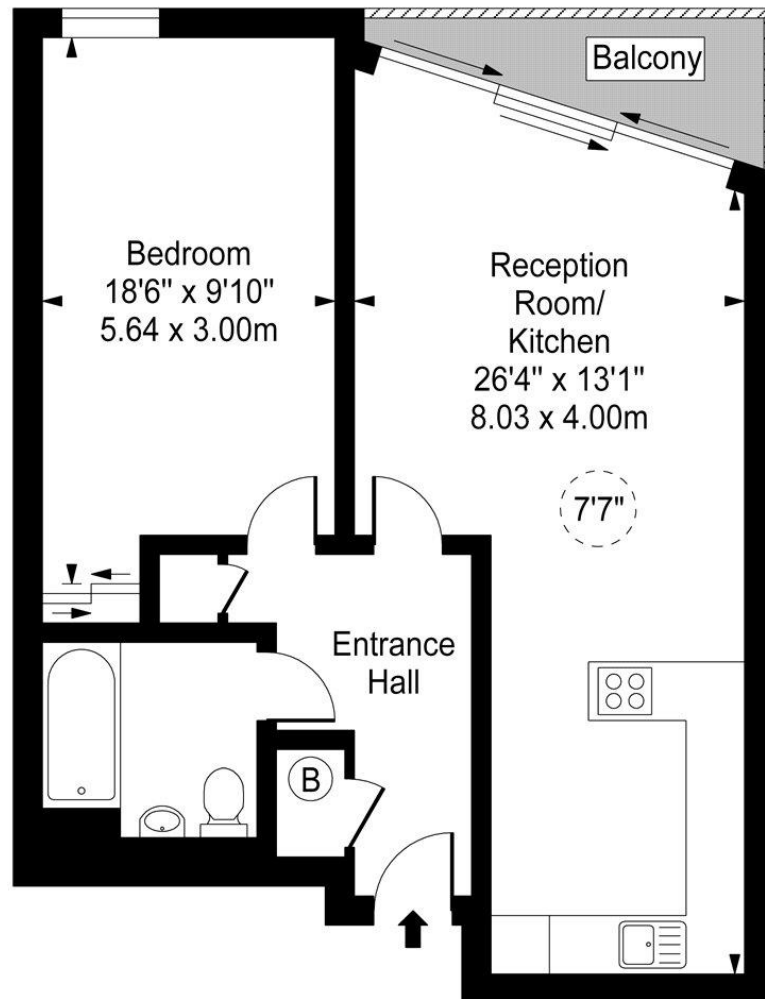
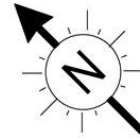

Fourth Floor

Approx Gross Internal Area 640 Sq Ft - 59.46 Sq M

For Illustration Purposes Only - Not To Scale

www.goldlens.co.uk

Prepared for Chestertons

Ref. No. 013697MiV