



Mansfield Road

London, NW3

£3,750 per month
(£865.38 per week)

****SHORT LET**** A delightful one double bedroom garden flat located moments from Parliament Hill Fields. This contemporary apartment comprises open plan kitchen/reception, double bedroom with walk-in wardrobe and en-suite bathroom, ample storage and access to a beautiful private garden.

Located only moments from Gospel Oak Overground and a short walk away from the amenities of South End Green, Belsize Park and Hampstead Heath.

CHESTERTONS



Mansfield Road

London, NW3

- Delightful one double bedroom garden flat
- Stone's throw away from Parliament Hill Fields
- Good storage
- Moments from Gospel Oak Overground
- Short walk to the amenities of Belsize Park & Hampstead



Minimum Term: 1 months
Deposit Required: £1,730.77
Local Authority: London Borough Of Camden
Council Tax Band: A
EPC Rating: E
Furnished

Score	Energy rating	Current	Potential
92+	A		
81-91	B		
69-80	C		70 C
55-68	D		
39-54	E	46 E	
21-38	F		
1-20	G		

Chestertons Hampstead Lettings

55-56 Hampstead High Street
Hampstead
London
NW3 1QH
hampstead@chestertons.co.uk
02077941125
chestertons.co.uk

Additional tenant charges apply (fees apply to non-AST tenancies only)
Tenancy Agreement Fee: £300
References per Tenant/Guarantor: £60
Inventory check (approx. £100 – £250 inc. VAT)
[chestertons.co.uk/property-to-rent/applicable-fees](https://www.chestertons.co.uk/property-to-rent/applicable-fees)

TOTAL APPROX FLOOR AREA 286.64 SQ. FT. (AREA 26.63 SQ. M)

Whilst every attempt has been made to ensure the accuracy of the floor plan contained here, measurements of doors, windows, rooms and any other items are approximate and no responsibility is taken for any error, omission or mis-statement. This plan is for illustrative purposes only and should be used as such by any prospective purchaser.

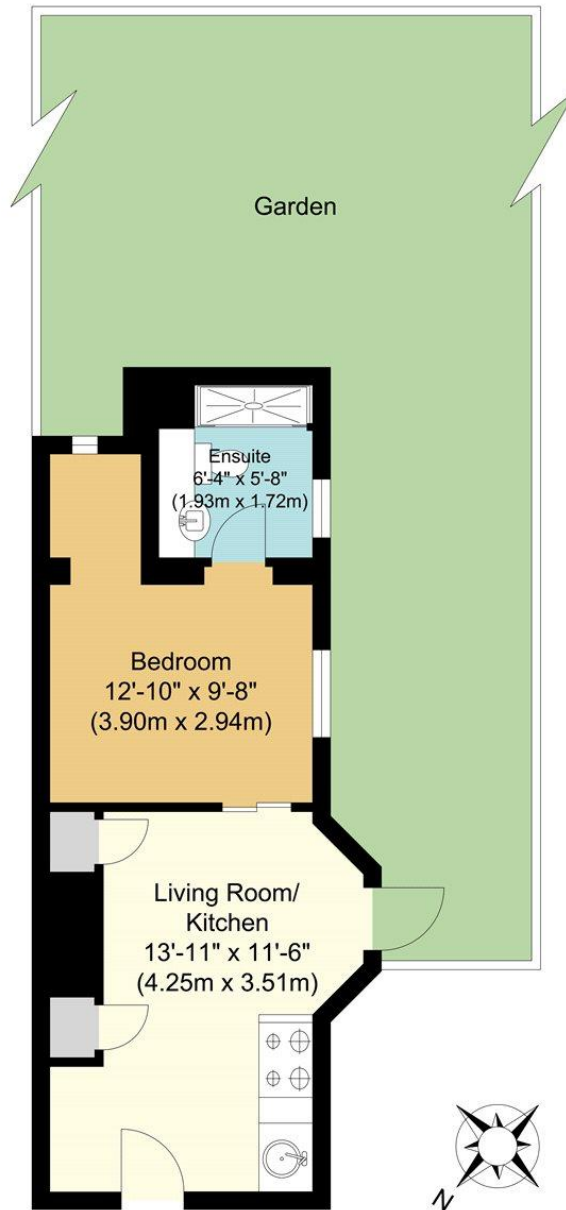

Ground Floor Flat
Approximate Floor Area
286.64 sq. ft.
(26.63 sq. m)