



Belsize Square

Belsize Park, NW3

£2,250 per month
(£519.23 per week)

VIDEO TOUR AVAILABLE. A magnificent spacious 1st floor apartment in a beautiful period building boasting exceptionally high ceilings, wood floors throughout and a balcony in Belsize Park. Sole Agent.

CHESTERTONS



Belsize Square

Belsize Park, NW3

- A Magnificent Spacious 1st floor Apartment in Beautiful Period Building
- 1 Bedroom, 1 Bathroom, Reception, Kitchen
- Exceptionally High Ceilings, Wood Floors,, Balcony
- Quiet Tree Lined Street, Walking Distance to the Shops/Amenities of Belsize Park (Northern Line)



VIDEO TOUR AVAILABLE.A magnificent spacious 1st floor apartment in a beautiful period building boasting exceptionally high ceilings, wood floors throughout and a balcony. The property is situated in this popular well located quiet tree lined square in the heart of Belsize Park, walking distance to the shops and restaurants. Accommodation comprises spacious reception room, fully fitted kitchen, double bedroom with fitted wardrobes with direct access to the balcony, ultra modern bathroom, separate guest cloakroom. Sole Agent.

Minimum Term: 18 months
Deposit Required: £2,596.15
Local Authority: London Borough Of Camden
Council Tax Band: D
EPC Rating: C
Furnished

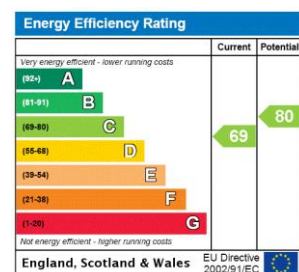

Chestertons Hampstead Lettings

55-56 Hampstead High Street
Hampstead
London
NW3 1QH
hampstead@chestertons.co.uk
02077941125
chestertons.co.uk

Additional tenant charges apply (fees apply to non-AST tenancies only)
Tenancy Agreement Fee: £300
References per Tenant/Guarantor: £60
Inventory check (approx. £100 – £250 inc. VAT)
chestertons.co.uk/property-to-rent/applicable-fees

Belsize Square, NW3

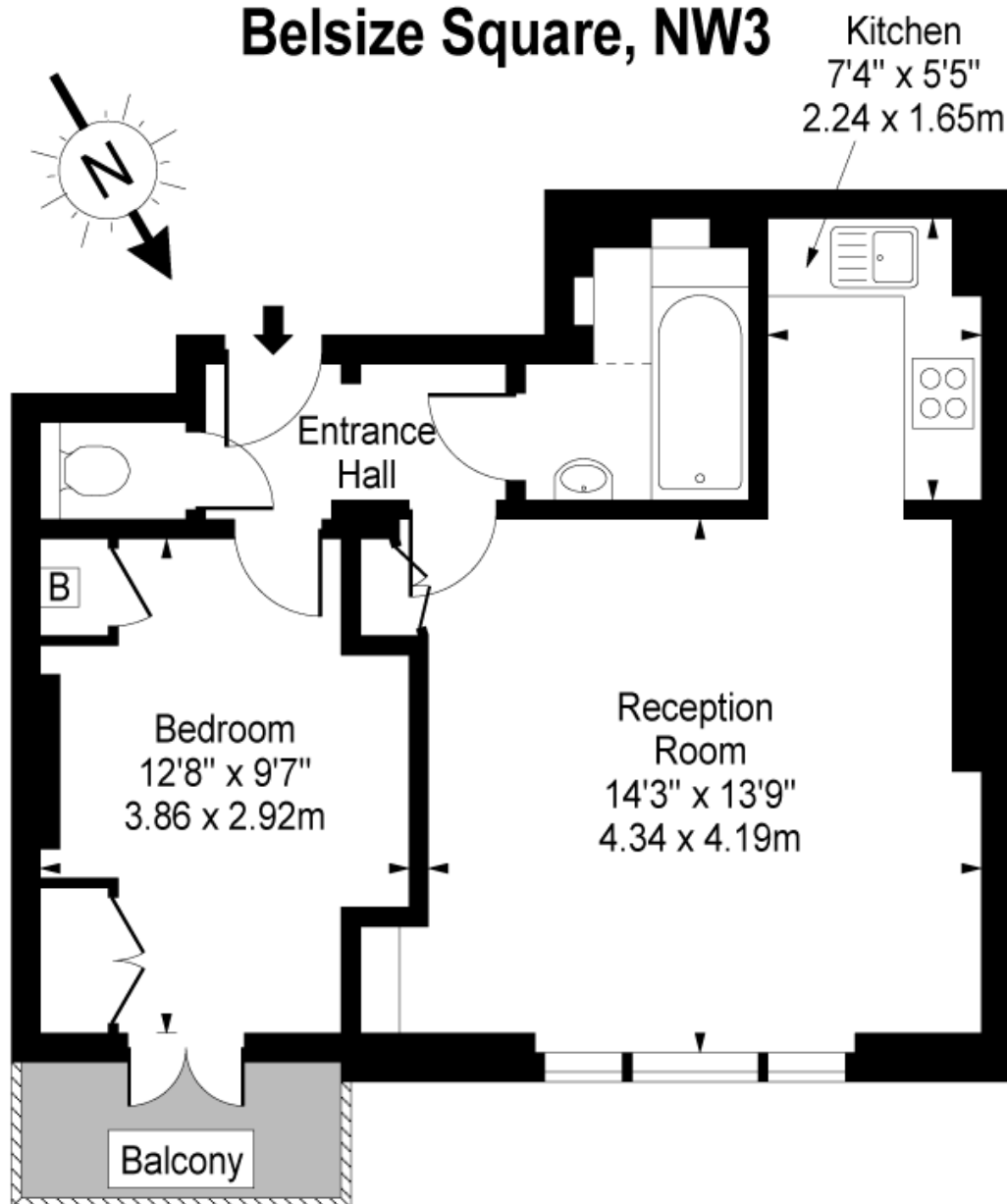

First Floor

Approx Gross Internal Area 450 Sq Ft - 41.81 Sq M

For Illustration Purposes Only - Not To Scale

www.goldlens.co.uk

Prepared for Chestertons

Ref. No. 001573

